

ZIPPER MASCHINEN GmbH

Gewerbepark 8

4707 Schlösslberg | AUSTRIA

+43 (0) 7248 61116-700 | FAX 7248 61116-720

info@zipper-maschinen.at | www.zipper-maschinen.at

Originalfassung

DE BETRIEBSANLEITUNG

MULTIPUMPE 3 IN 1

Übersetzung / Translation

EN USER MANUAL

PUMP 3 IN 1



ZI-MUP350

EAN: 9120039233253

ZI-MUP750

EAN: 9120039233260





10 PREFACE (EN)

Dear Customer!

This manual contains important information and advice for the correct and safe use and maintenance of the PUMP 3 IN 1 ZI-MUP350 / ZI-MUP750.

Following the usual commercial name of the machine (see cover) is substituted in this manual with the name "machine".

The manual is part of the machine and may not be stored separately. Read it profoundly before first use of the machine and keep it for later reference. When the machine is handed to other persons always put the manual to the machine.

Please follow the security instructions!

Please read the entire manual, to prevent misunderstandings, machine damage or even injuries!



Due to continuous development of our products illustrations, pictures might differ slightly.

If you however find errors in this manual, please inform us.

Technical changes excepted!

Copyright law

© 2017

This manual is protected by copyright law – all rights reserved. Especially the reprinting as well as the translation and depiction of pictures will be prosecuted by law. Court of jurisdiction is the Landesgericht Linz or the competent court for 4707 Schlüsslberg, AUSTRIA.

Customer Support

ZIPPER MASCHINEN GmbH

Gewerbepark 8, 4707 Schlüsslberg
AUSTRIA

Tel.: +43 7248 61116-700

Fax: +43 7248 61116-720

Mail: info@zipper-maschinen.at

11 TECHNIC

11.1 Components

1	Transport handle
2	Connection cable
3	Float switch cable
4	Pump housing
5	Hose adapter
6	Float switch
7	Suction slots

Symbolfoto

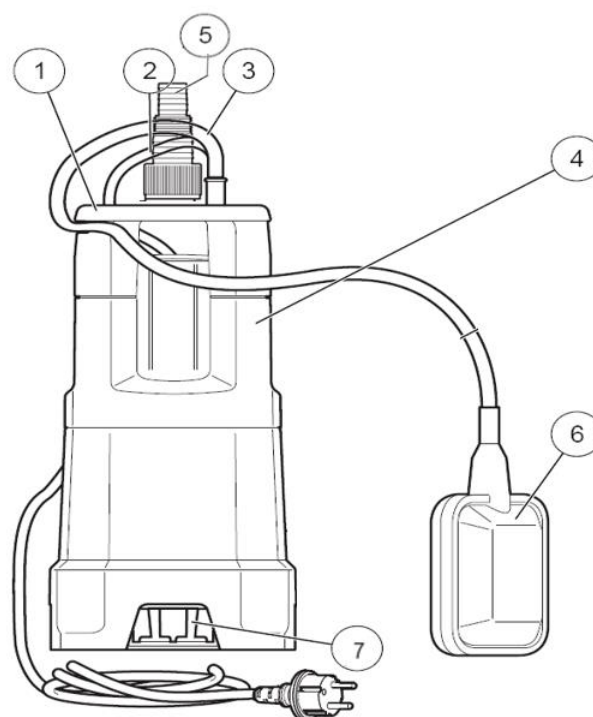

11.2 Technical details

	ZI-MUP350	ZI-MUP750
Voltage	230 V / 50 Hz	230 V / 50 Hz
Power	350 W	750 W
Max. head of delivery	7 m	10 m
Max. immersion	7 m	7 m
Max. delivered capacity	7500 l/h	12000 l/h
Solid	1 mm	1 mm
Max. water temperature	35° C	35° C
Hose connection	1-1,5"	1-1,5"
Protection mode	IP X8	IP X8
Connecting cable length	10 m	10 m
Weight	5,2 kg	6,8 kg



12 SAFETY

12.1 Intended Use

The machine must only be used for its intended purpose! Any other use is deemed to be a case of misuse.

To use the machine properly you must also observe and follow all safety regulations, the assembly instructions, operating and maintenance instructions lay down in this manual.

All people who use and service the machine have to be acquainted with this manual and must be informed about the machine's potential hazards.

It is also imperative to observe the accident prevention regulations in force in your area.

The same applies for the general rules of occupational health and safety.

The machine is used for:

Drainage and for pumping into and out of containers in the house, garden, farm and agriculture

The machine is suitable for:

Clear water, rainwater, chlorine-containing water (e.g. swimming pools), waste water.

This machine is not intended for use by persons (including children) with reduced physical, sensory or mental capabilities, or lack of experience and knowledge, unless they have been given supervision or instruction concerning use of the machine by a person responsible for their safety.

Never allow children or people unfamiliar with these instructions to use the machine. Supervise children. This will ensure that children do not play with the machine.

Any manipulation of the machine or its parts is a misuse, in this case ZIPPER-MASCHINEN and its sales partners cannot be made liable for ANY direct or indirect damage.

Prohibited use:

The machine must not be used continuously.

They are not suitable for conveying:

Drinking water; salt water; foodstuffs; aggressive media, chemicals; corrosive, flammable, explosive or fuming fluids; Fluids that are hotter than 35 °C; Water containing sand and abrasive fluids; feces.

- The operation of the machine outside the stated technical limits described in this manual is forbidden.
- Any manipulation of the machine and parts is forbidden.
- The use of the machine not being suitable for the use of the machine and not being certified is forbidden.
- The use of the machine for any purposes other than described in this user-manual is forbidden.
- The unattended operation on the machine during the working process is forbidden!
- It is not allowed to leave the immediate work area during the work is being performed!



12.2 Safety instructions

Missing or non-readable security stickers have to be replaced immediately!

The locally applicable laws and regulations may specify the minimum age of the operator and limit the use of this machine!

To avoid malfunction, machine defects and injuries, read the following security instructions!

- **Electric shock! There is a risk of an injury caused by electric shock!**
- **Children should be supervised to ensure that they do not play with the device. Always keep children and unauthorised persons out of reach of the appliance.**
- **Operation is only allowed with a safety switch against stray current (RCD max. stray current of 30mA). Before putting into operation, a qualified electrician must check whether electric safety measures required are in place. Any national regulations in this regard must be complied with.**
- **Electric connection must be to a socket.**
- **It is necessary to make sure the connecting socket was not near water and humidity and the plug was protected against humidity.**
- **Check the voltage. Technical data given on the type label must correspond with electric network voltage.**
- **Only use splash proof extension cables approved for outdoor purposes.**
- **Do not grab the feeder cable, plunge the pump, lift or carry it while it is connected to the grid!**
- **Check the cable and/or socket for damages before the appliance putting into operation.**
- **To avoid danger, a damaged connection cable must be replaced.**
- **Protect the connection cable from excessive temperatures, oil and sharp edges.**
- **Unplug the device prior to submersion, upon termination of operation, in the course of defect removal and prior to performing maintenance procedures.**
- **If the pump is in operation, neither people nor animals can be present or plunged in the pumped liquid (e.g. pools, cellars, etc.).**
- **The pump must not in any case run without fillings.**
- **Do not leave the pump unattended while in operation in order to prevent subsequent damages caused by eventual malfunctions. Make sure to disconnect the device from the grid if you do not plan on using it.**
- **If the pump is used in ponds, wells, etc. and appropriate pumping stations, standards valid for pumps in the given country must unconditionally be observed.**
- **Risk of injury around the crusher on the bottom of the pump. Touch the appliance on the top on the handle only. Do not touch the rotating tool.**



13 OPERATION

13.1 Assembly

- Screw the hose adapter (5) into the pump outlet
 - Fix a hose to the hose adapter.
- The hose adapter can be trimmed to suit the selected hose connection.

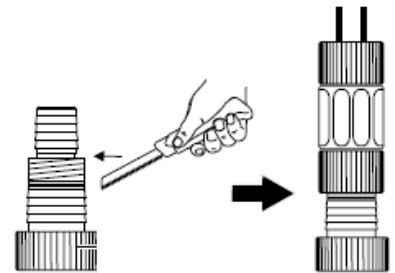

13.2 Operation instructions

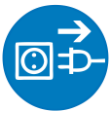

WARNING



- **Perform all machine settings with the machine being disconnected from the power supply!**
- **Make sure that the immersion pump is standing securely or operate the immersion pump suspended from a rope.**
- **Make sure there is adequate clearance under the pump.**
- **Never allow the immersion pump to run against a closed off hose line.**
- **When using in shafts, make sure the size is adequate.**
- **Always cover the shaft with a secure footplate.**
- **The immersion pump switches on automatically using the float switch when a specific water level has been reached, and switches off again if the water drops below the switch-off height.**
- **Recommended cable length on the float switch approx. 120 mm.**

13.3 Operating

- Unwind the connection cable (2) completely.
- Make sure that the electrical plug connection is mounted in the area safe from flooding.
- Change the terminal position and adjust the switching points of the float switch (6) individually.
- Attach the cable on the float switch to the pump housing securely.
- Immerse the immersion pump in the conveying medium slowly. Hold the immersion pump at a slight angle to allow any air to escape.
- Insert the mains plug into the plug socket.
- To switch off remove the mains plug from the plug socket.

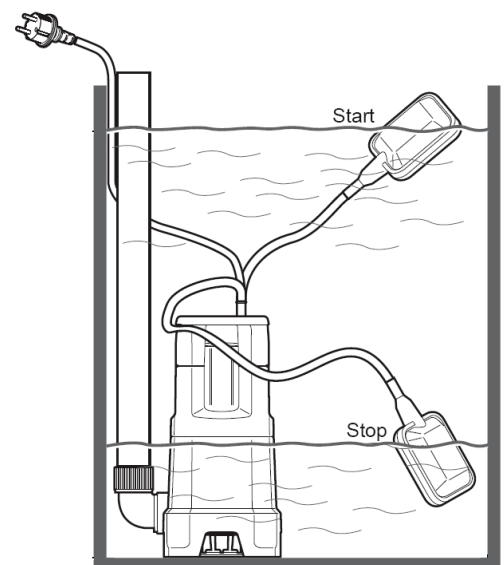



14 MAINTENANCE

ATTENTION



Perform all maintenance machine settings with the machine being disconnected from the power supply!
Serious injury due to unintentional or automatic activation of the machine!



The machine does not require extensive maintenance. If malfunctions and defects occur, let it be serviced by trained persons only.

NOTICE

Clean your machine regularly after every usage – it prolongs the machines lifespan and is a prerequisite for a safe working environment.

Repair jobs shall be performed by respectively trained professionals only!

Check regularly the condition of the security stickers. Replace them if required.
Check regularly the condition of the machine.

14.1 Cleaning

After each workshift the machine has to be cleaned.
Clean the suction slots on the suction foot if necessary with clear water.



NOTICE

The usage of certain solutions containing ingredients damaging metal surfaces as well as the use of scrubbing agents will damage the machine surface!

Clean the machine surface with a wet cloth soaked in a mild detergent

14.2 Storing

Make sure there is no water in the machine. The machine has to be completely emptied and stored in a dry area with frost-proof protection. Adhesion of mechanical seals can be prevented if you rinse the pump with appropriate oil (for example, with vegetable oil).

14.3 Disposal

Do not dispose the machine in residual waste. Contact your local authorities for information regarding the available disposal options. When you buy at your local dealer for a replacement unit, the latter is obliged to exchange your old.





15 TROUBLE SHOOTING

BEFORE YOU START WORKING FOR THE ELIMINATION OF DEFECTS, DISCONNECT THE MACHINE FROM THE POWER SUPPLY.

Trouble	Possible cause	Solution
Motor does not run.	• Impeller blocked	• Remove dirt in the suction area.
	• Thermal protection switch has switched off.	• Wait until the thermal protection switch on the immersion pump switches on again. Take note of the maximum temperature of the conveying medium. Have the immersion pump inspected.
	• No mains power.	• Check the fuses and the power supply
	• Float switch does not switch off when the water level rises.	• Check the float switch
Pump is running but does not feed.	• Air in pump housing.	• Vent the immersion pump by holding it at an angle.
	• Blockage on the suction side.	• Remove dirt in the suction area.
	• Hose line closed off or kinked.	• Open or extend the hose line.
Feed rate too low	• Hose diameter too small.	• Use a bigger hose.
	• Blockage on the suction side.	• Remove dirt in the suction area
	• Feed head too high.	• Observe max. feed head!

MANY POTENTIAL SOURCES OF ERROR CAN BE CLEARED BY THE EXPERTLY CONNECTION TO THE ELECTRICITY GRID.



NOTICE

Should you in necessary repairs not able to properly to perform or you have not the prescribed training for it always attract a workshop to fix the problem.