

ZIPPER MASCHINEN GmbH

Gewerbepark 8

4707 Schlüsslberg | AUSTRIA

+43 (0) 7248 61116-700 | FAX 7248 61116-720

info@zipper-maschinen.at | www.zipper-maschinen.at

Originalfassung

DE BETRIEBSANLEITUNG

Übersetzung / Translation

EN USER MANUAL

SL NAVODILO ZA OBRATOVANJE

ES INSTRUCCIONES DE SERVICIO

BENZIN HECKENSCHERE

GASOLINE HEDGE TRIMMER

BENCINSKE ŠKARJE ZA ŽIVO MEJO

CORTASETOS DE GASOLINA



ZI-BHS605

EAN: 9120039233826





12 PREFACE (EN)

Dear Customer!

These operating instructions contain information and important instructions for the safe start-up and handling of the ZIPPER petrol hedge trimmer ZI-BHS 605, hereinafter referred to as "machine".



The manual is an integral part of the machine and must not be removed. Keep it for later use in a suitable place, easily accessible to users (operators), protected from dust and moisture, and enclose it with the machine if it is passed on to third parties!

Please pay special attention to the chapter Safety!

Due to the constant further development of our products, illustrations and contents may differ slightly. If you notice any errors, please inform us.

Subject to technical changes!

Inspect the goods immediately after receipt and note any complaints on the consignment note when accepted by the deliverer!

Transport damage must be reported separately to us within 24 hours.

ZIPPER MASCHINEN cannot be held liable for any unnoticed transport damage.

Copyright

© 2018

This documentation is protected by copyright. All rights reserved! In particular the reprint, the translation and the removal of photos and illustrations will be prosecuted.

The place of jurisdiction shall be the court responsible for ZIPPER Maschinen.

Customer Service Address

ZIPPER MASCHINEN GmbH

Gewerbepark 8, A-4707 Schlüsslberg
AUSTRIA

Tel.: +43 7248 61116-700

Fax: +43 7248 61116-720

Mail: info@zipper-maschinen.at



13 SAFETY

This section contains information and important notes on safe commissioning and handling of the machine.



For your safety, please read these operating instructions carefully before start-up. This will enable you to handle the machine safely and prevent misunderstandings as well as personal injury and damage to property. Also observe the symbols and pictograms used on the machine as well as the safety and hazard information!

13.1 Intended Use of the Machine

The machine is intended exclusively for the following activities: For cutting shrubs, bushes, bushes and hedges within the specified technical limits.

ZIPPER-MASCHINEN accepts no responsibility or warranty for any other use or use beyond this and for any resulting damage to property or injury.

13.1.1 Prohibited Applications / Hazardous Misapplications

- Operating the machine without adequate physical and mental fitness.
- Operating the machine without knowledge of the operating manual of the machine / engine.
- Changes to the design of the machine.
- Operating the machine in a potentially explosive environment.
- Operating the machine indoors or in closed areas.
- Operating the machine without functioning or missing protection devices.
- Remove the safety signs attached to the machine.
- Modify, circumvent or disable the safety devices of the machine.

Improper use or disregard of the explanations and instructions given in this manual will result in the expiration of all warranty and compensation claims against Zipper Maschinen GmbH.

13.2 User Requirements

The machine is designed to be operated by one person. The physical and mental suitability as well as knowledge and understanding of the operating instructions are prerequisites for operating the machine.

Please note that local laws and regulations may determine the minimum age of the operator and restrict the use of this machine!

Put on personal protective equipment before starting work with/on the machine.

13.3 General Safety Instructions

To avoid malfunctions, damage and health hazards when working with the machine, in addition to the general rules for safe working, the following points in particular must be observed:

- Check that the machine is in perfect condition before each use. Ensure that all guards are in place and working properly and that all nuts, bolts, etc. are securely tightened.
- Ensure sufficient lighting conditions in the working and surrounding areas of the machine.
- Always ensure a safe working position.
- Remove setting tools from the machine before starting.
- Never leave the running machine unattended.
- Ensure that unauthorised persons maintain in safe distance from the machine and keep children away from the machine in particular.
- The machine may only be operated, serviced or repaired by persons who are familiar with it and who have been informed of the dangers arising during this work.
- Always wear suitable personal protective equipment (eye protection, ear protection, face protection, working gloves, safety shoes, tight-fitting protective clothing, etc.)!
- Do not work on the machine if you are tired, not concentrated or under the influence of medication, alcohol or other drugs!



- Never operate the machine in the presence of flammable liquids or gases (danger of explosion!).
- Carry out conversion, adjustment, measuring and cleaning work only when the engine is switched off.
- Only use spare parts and accessories recommended by ZIPPER machines.

13.4 Special Safety Instructions for Machine Operation

- Keep the machine away from your body when you start it and work with it.
- Do not start cutting until you have ensured that there are no other people or animals in the work area.
- Always start cutting with the cutting device running.
- Move the machine so that the cut is always away from the body.
- Never cut above shoulder height.
- Never work with the hedge trimmer standing on ladders.
- When working with the machine, make sure that you do not touch any objects that could damage the cutting device, such as wires, fences, etc.
- Do not touch the ground with the cutting device running.
- Never touch the cutting device with your hands while the machine is in operation.
- Never attempt to remove objects stuck in the cutter while the engine is running.
- Prolonged continuous use of the machine may result in circulatory problems caused by vibration, especially on fingers, hands or wrists. Therefore, take regular breaks and wear suitable working gloves to reduce the vibration intensity.
- Excessive noise can cause hearing damage and temporary or permanent hearing loss. Wear hearing protection certified to health and safety regulations to limit noise exposure.

13.5 Safety Instructions for Machines with Combustion Engine

- Do not touch the engine and/or muffler during operation or immediately after switching off! These areas become hot during operation and can cause burns.
- Do not touch the spark plug connector when the engine is running (electric shock!).
- Do not operate the unit in closed areas or in rooms, unless there is adequate ventilation through exhaust fans or hoses. (Danger from carbon monoxide!)
- Do not smoke when refuelling the machine.
- Refuel the machine only in a well ventilated area.
- Do not refuel the machine as long as the engine is running or the machine is still hot.
- Do not refuel the machine near an open flame.
- Do not spill fuel when refuelling.
- Do not crank a flooded petrol engine as long as the spark plug is removed - fuel accumulated in the cylinder sprays out of the spark plug opening.
- Do not carry out an ignition spark test on petrol engines if the engine is flooded or petrol can be smelled. A stray spark could ignite the vapours.
- Do not use petrol or other types of fuel or flammable solutions to clean machine parts, especially indoors. Vapours from fuels and solutions may explode.
- Always keep the area around the muffler free of foreign substances such as leaves, paper, cardboard, etc. A hot muffler could ignite these substances and cause a fire.
- Close the filler cap after refuelling.
- Check the fuel line and tank regularly for leaks and cracks. Do not operate the machine if leaks in the fuel system are known.
- Store fuel only in designated and approved containers.

13.6 Hazard Warnings

Despite proper use, certain residual risks remain. Due to the design and construction of the machine, hazardous situations may occur when handling the machine, which are identified in these instructions as follows:

DANGER



A safety instruction designed in this way indicates an imminently hazardous situation which, if not avoided, will result in death or serious injury.

**WARNING**

Such a safety instruction indicates a potentially hazardous situation which, if not avoided, may result in serious injury or even death.

CAUTION

A safety instruction designed in this way indicates a potentially hazardous situation which, if not avoided, may result in minor or moderate injury.

NOTICE

A safety notice designed in this way indicates a potentially hazardous situation which, if not avoided, may result in property damage.

Irrespective of all safety regulations, your common sense and your corresponding technical suitability/training are and will remain the most important safety factor for error-free operation of the machine. **Safe working depends first and foremost on you!**

14 TRANSPORT

WARNING

Never transport the hedge trimmer with the cutting device running!

Always keep the hot silencer away from your body during transport. Carry the hedge trimmer only on the handles. The cutting device should point backwards during transport. When transporting over long distances, always attach the supplied blade cover.

Ensure that the hedge trimmer is in a safe position during transport in the vehicle. Only place the hedge trimmer in the trunk or on a transport surface separated from the driver.

15 START-UP

15.1 Checking the Delivery Content

Check the machine immediately after unpacking for transport damage, missing parts and loose screw connections. Report any damage or missing parts to your retailer immediately. Visible transport damage must be noted on the delivery note in accordance with the warranty provisions, otherwise the goods will be deemed to have been properly accepted.

15.2 Assembly

The machine is delivered pre-assembled. Therefore, no further assembly steps are necessary before commissioning, but the fuel reservoir must be refilled.

15.3 Fuel

15.3.1 General Requirements

The machine is equipped with a two-stroke engine that requires two-stroke oil to be added to the petrol.

- Only use two-stroke oil approved for air-cooled engines, chainsaws, trimmers, etc. in a 2.5% mixture. This means that 4 litres of unleaded petrol are mixed with 0.1 litres of 2-stroke oil (mixing ratio 40:1).



- Do not use alkylate petrol as it consists of only 2% mixture and can damage the engine.
- Use a suitable, clean container for mixing.
- Shake the container with the oil well before opening and then mix oil and petrol thoroughly.
- Fuel and fuel mixtures age: Superimposed fuel and fuel mixtures can lead to starting problems. Never store the same mixture in the tank for more than 30 days. Do not use a petrol/oil mixture older than 90 days for the machine.

15.3.2 Filling up with Fuel

DANGER



Always switch off the engine before refuelling. Never fill the machine with fuel when the engine is running or while the engine is still hot – cool down time at least 2 minutes. Move more than 3 meters from the point of refuelling before restarting the engine.

Fuelling procedure:

- Unscrew fuel tank cap
- Pour the oil-fuel mixture carefully into the tank
→ Do not spill anything!
- Close the tank cap tightly.
→ Wipe up any spilled petrol!

16 OPERATION

16.1 Starting the Machine

16.1.1 Starting with Cold Engine

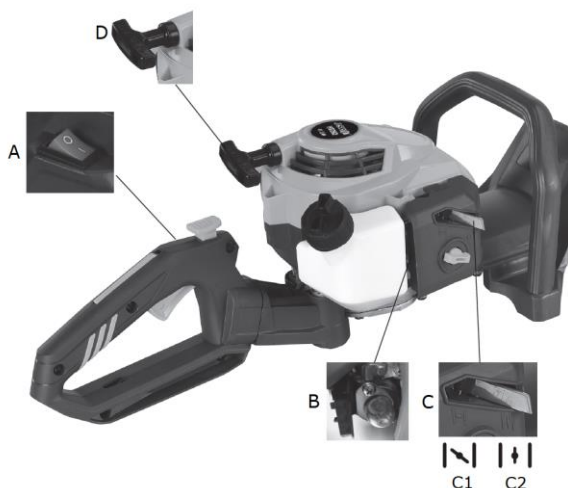

1. Place the hedge trimmer on a flat, stable surface.
2. Set the ON-OFF switch (A) to position "I" (ON).
3. Press fuel pump (B) 8 to 10 times.
4. Move the choke lever to start position (C1).
5. Slowly pull out the start rope (D) until you feel a slight resistance. Then pull out the starting rope powerfully. Guide the start rope back into the engine by hand. Repeat up to 3 times until the first ignition can be heard (engine normally does not start here).
6. Move the choke lever (C) to the run position (C2) = closed.
7. Pull the starting rope as described (point 5) until the engine is running.

16.1.2 Starting with a warm Engine

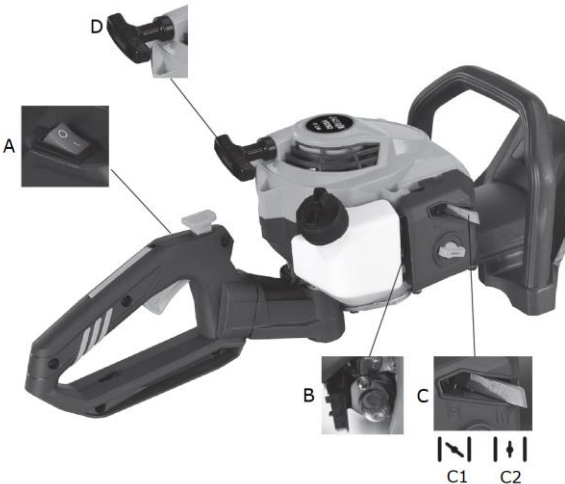

1. Set the ON-OFF switch (A) to position "I" (ON).
2. Move the choke lever (C) to run position (C2) = closed.
3. Pull start rope (D) until the engine is running.

16.2 Switching off the machine

1. Release the throttle.
2. Set ON-OFF switch (A) to position "0" (OFF).

16.3 Turning the Handle

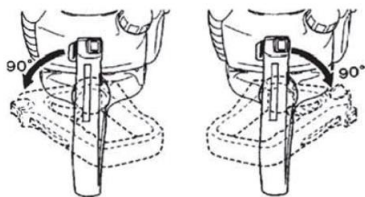

To give you the best and most ergonomic way to trim your hedge, the handle can be rotated 90 degrees to the right or left - see illustration on the left.

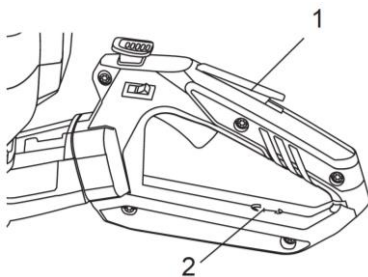

Notice: Do not press on the throttle when turning the handle!

Procedure:

Press the throttle lock (1) on the top of the rear handle. Then push the locking handle (2) downwards while simultaneously turning the handle to the left or right – see illustrations on the left.

16.4 Recommendations for Cutting

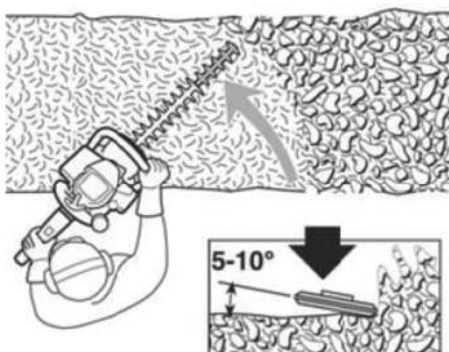

Only accelerate as much as necessary.

Hold the hedge trimmer at an angle of 5-10 degrees to the hedge (see illustration on the left).

→ This makes cutting easier and the result is better.



17 MAINTENANCE

WARNING



Hot surfaces and rotating machine parts while the engine is running can cause serious injury or even death. Always switch off the machine for conversion, adjustment, cleaning and maintenance work and secure it against unintentional recommissioning.

The machine is low-maintenance and only a few parts have to be serviced. Nevertheless, malfunctions or defects which could impair the safety of the user must be rectified immediately! If you are unable to carry out necessary maintenance work properly and/or do not have the required training, always consult a specialist workshop to get the problem fixed.

17.1 Maintenance schedule

The type and degree of machine wear depend to a large extent on the operating conditions. The following intervals apply when the machine is used within the specified limits:

	Assembly group/component	What to do?	Before starting	After xx operating hours			Remark
				25	50	100	
Motor	Fuel leak	wipe up spilled fuel immediately	✓				
	Fuel tank, air filter, fuel filter	check and clean	✓	✓			replace if necessary
	Spark plug	cleaning and adjusting the spark plug head		✓			Distance 0,6-0,7 mm
	Airfilter	clean		✓			replace if necessary
Trimmer	Sword, blades	check and clean	✓				
	Gear box	check and lubricate			✓		grease during and after use
	Bolts, screws, nuts	tighten, replace	✓			✓	

17.2 Measures before Starting

- Remove leaves, branches and dirt from the machine.
- Check the machine for loose or missing parts.
- Fasten loose parts.
- Check the air filter for contamination.
- Check the machine for leaks in the fuel system.

17.3 Cleaning the Air Filter

A dirty air filter makes it difficult to start the engine and reduces the engine power.

Procedure:

1. Loosen the wing nut on the air filter housing, remove the cover and check that there is no dirt in the filter.
2. If necessary, clean the air filter in warm soapy water.
3. Allow the air filter to dry completely.
4. Then soak the air filter with 2-stroke engine oil.
5. Squeeze out excess oil.
6. Insert the oil-soaked filter.
7. Mount the air filter cover and tighten the wing nut.

Signs indicating a necessary air filter change:

- Engine power decreases, at the same time fuel consumption increases
- Oil consumption increases
- Starting the engine becomes more difficult

17.4 Lubricating the Gearbox

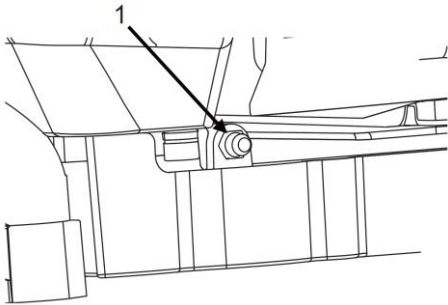

The gearbox is lubricated at the time of delivery of the machine, but must be relubricated at regular intervals (see maintenance schedule).

Lubrication is carried out via the lubrication nipple (1) on the side of the gearbox housing - see illustration on the left. Use a multi-purpose grease of class NLGI 2 or an equivalent product.

17.5 Setting the Idle Speed

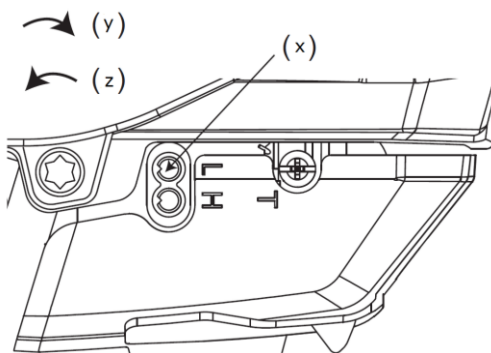

First check that the air filter is clean, as it may affect the result.

If the idle speed is correct, the cutter blade should not move when the machine is idling.

Use the idle screw (X) to adjust. Turn in direction y: Increase speed, direction z: Decrease speed.

Procedure:

- Close the idle adjustment screw while the engine is running (turn counterclockwise) until the cutting tool begins to rotate.

If the idle speed cannot be adjusted so that the cutter blade no longer moves, contact your dealer/service

centre and do not use the machine again until it has been properly adjusted or repaired.

17.6 Cleaning the Spark Plug

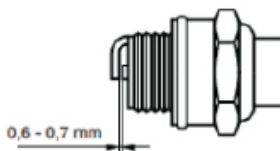

Remove the spark plug and clean it of soot and other impurities with a brush. Then check the distance between the contacts. It should be 0.6 to 0.7 mm (see illustration on the left), which is approximately the thickness of a credit card. Then reinstall the spark plug. For optimum performance, the spark plug should be replaced once a year. You will find the article number in the spare parts list.

18 STORAGE

DANGER



Observe all safety precautions for the safe storage and handling of petrol.

NOTICE



Improper storage can damage and destroy important components. Only store packed or unpacked parts under the intended ambient conditions!

In the case of a longer interruption of operation (> 30 days) or during decommissioning, observe the following points:

- - Clean the machine thoroughly and keep the blades frost-free and out of the reach of children.
- - Before storing the machine, empty all fuel into a container approved for petrol. Then let the engine run until it stops.
- - Store the machine in a dry environment protected from frost and other weather conditions.



19 DISPOSAL



Observe the national waste disposal regulations. Never dispose of the machine, machine components or equipment in residual waste. If necessary, contact your local authorities for information on the disposal options available.

If you buy a new machine or an equivalent device from your specialist retailer, he is obliged in certain countries to dispose of your old machine properly.

20 TROUBLESHOOTING

WARNING



Hot surfaces and rotating machine parts while the engine is running can cause serious injury or even death. Always switch off the machine before carrying out troubleshooting work and secure it against unintentional restarting.

If you are unable to carry out necessary repairs properly and/or do not have the required training, always consult a specialist to get the problem fixed.

Problem	Possible Cause	Solution
Engine does not start	<ol style="list-style-type: none">1. No ignition spark2. No fuel3. Engine "sunk"4. Recoil starter must be pulled tighter when the machine is new	<ol style="list-style-type: none">1. Check the spark plug.2. Press fuel pump. If the problem persists, contact your local retailer.3. Pull the starter three times with the choke-lever in closed position. If the engine does not start, set the choke-lever to "C1" and carry out the normal starting procedure. If the engine still does not start, repeat the procedure with a new spark plug.4. Contact your local retailer.
Engine starts but does not accelerate	<ol style="list-style-type: none">1. Carburettor should be adjusted	<ol style="list-style-type: none">1. Contact your local retailer
Engine starts but can only run on full power and on half choke.	<ol style="list-style-type: none">1. Carburettor should be cleaned, readjusted or replaced.	<ol style="list-style-type: none">1. Contact your local retailer
Engine does not run on full power and smokes heavily	<ol style="list-style-type: none">1. Check the petrol/oil mixture.2. Dirty air filter3. Carburettor should be readjusted, repaired or replaced	<ol style="list-style-type: none">1. Use fresh fuel and the correct two-stroke mixture.2. Clean or replace air filter3. Contact your local retailer
Engine starts, runs and accelerates but cannot run idle	<ol style="list-style-type: none">1. Carburettor should be adjusted	<ol style="list-style-type: none">1. Contact your local retailer
Oil leaks from the exhaust.	<ol style="list-style-type: none">1. Trimmer is not used at full power2. Check the petrol/oil mixture3. Carburettor should be adjusted	<ol style="list-style-type: none">1. Use full power2. Use fresh fuel and the correct two-stroke mixture.3. Contact your local retailer