

EN

SV

DE

FR

SC-60 Scissors Jig Instruction

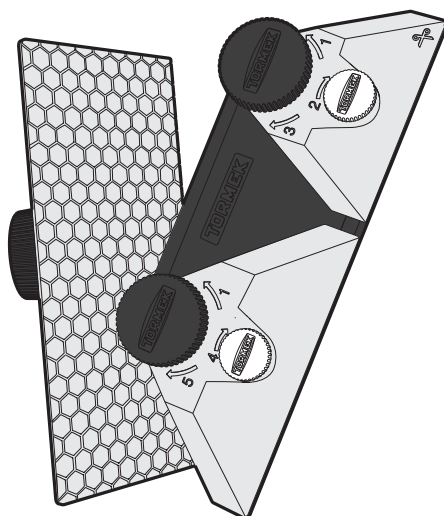

PATENT

To see all patents visit
tormek.com/patents

SC-60 Scissors Jig

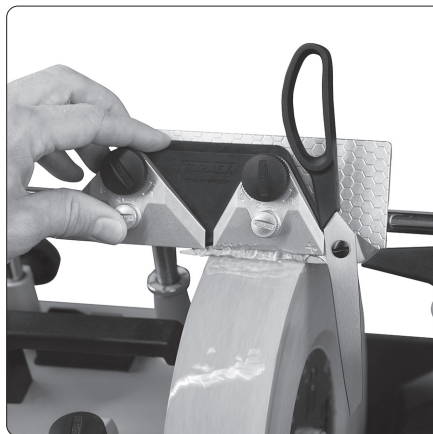

SCISSORS



HEDGE SHEARS

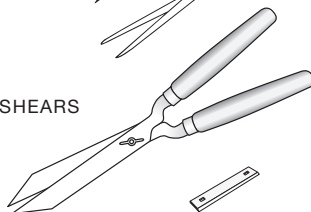

PORTABLE ELECTRIC PLANER BLADES

Positioning of Machine

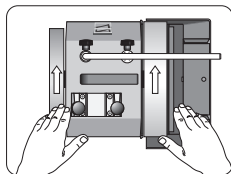

Sharpening direction:
Edge leading.

Design

The jig consists of a *support plate* (1) and a *holder* (2) with a *smaller clamp* (3) and a *larger clamp* (4). The smaller clamp serves as the main clamp, holding the scissors in place, while the larger one supports the tip of the blade to reduce vibrations. The clamps can be adjusted to fit different scissor thicknesses using *screws* (5) and *knobs* (6).

On the back of the support plate, there are two *guides* (7) that allow you to quickly set a 60-degree angle. The *knob* (8) locks the support plate at a fixed angle during sharpening. Thanks to its wedge shape, the *TorLock hole* (9) locks the support plate securely.

The support plate features a hexagon-patterned sliding surface, allowing the holder to move smoothly while being pressed against the plate. The pattern reduces friction, and the channels between the hexagons help keep the surface clean and efficient. It also features a *center indentation* (10) designed for easier use of the WM-200 AngleMaster.

Note For instructions on how to use the jig on the Tormek T-2 Pro Kitchen Knife Sharpener see page 10.

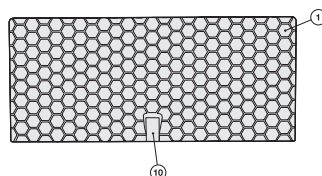
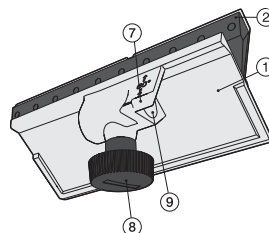
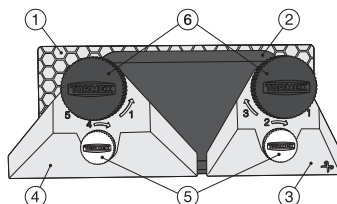

1. Mounting the scissors in the holder

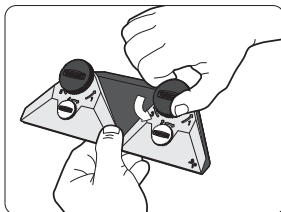

Loosen both knobs fully (1), without removing them.

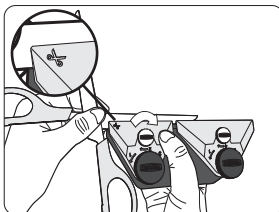

Place the base of the blade at the scissors symbol. Adjust the clamp to the thickness of the scissors using the screw on the smaller clamp (2).

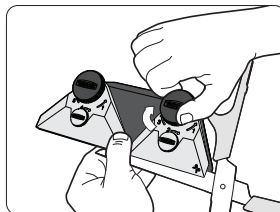

Tighten the knob (3) on the smaller clamp to secure the scissors. Repeat these steps for the larger clamp (4 and 5).

Important Make sure the scissors are open at least 90 degrees to prevent the other blade from coming into contact with the side of the grinding wheel. If necessary, disassemble the scissors and sharpen the blades separately.

Note For left-handed scissors please see page 8 for instructions.

The edge angle is set by adjusting the support plate. You can either set a general 60-degree angle using the jig's quick guide (2a), repeat the existing angle (2b) or set a custom angle for your scissors using the WM-200 AngleMaster (2c).

2a. Setting a 60 degree edge angle

A 60-degree edge angle works well for most scissors, which is why we recommend it as a quick setting. If your scissors have a different angle, you can choose to change it to 60° during the first sharpening with the jig. While this may take a bit longer the first time due to the changed angle, it will save time during future sharpenings.

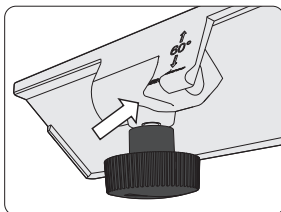

On the back of the support plate, there are two guides that enable a quick setting of a 60-degree edge angle. One guide is for 250 mm grinding wheels, and the other is for 200 mm grinding wheels.

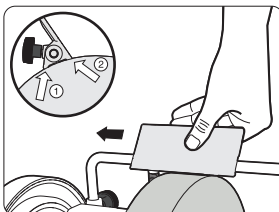

Slide the support plate onto the universal support. Adjust the height of the universal support so that both the correct guide for your grinding wheel size (1) and the edge of the support plate (2) are in full contact with the wheel.

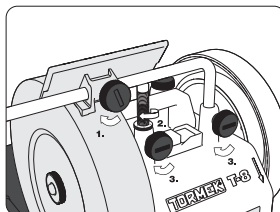

Secure the support plate in this position using the knob on the jig (1). Rotate the micro adjustment on the universal support one full turn clockwise (2), or until the support plate clears the grinding wheel, then lock the universal support in place with the knob on the machine's precision mounts (3).

Note The quick guide is designed for grinding wheels with an exact 200 mm or 250 mm diameter. Using a grinding wheel with a different diameter will slightly affect the accuracy of this method of angle setting. In most cases, this effect is negligible. However, the greater the difference is from these set diameters, the more noticeable the deviation will be.

2b. Repeat the existing edge angle



Slide the support plate onto the universal support. Adjust the height of the universal support so that there is approximately 1.5 mm of clearance between the support plate and the grinding wheel (this equals one full turn clockwise on the micro adjust).

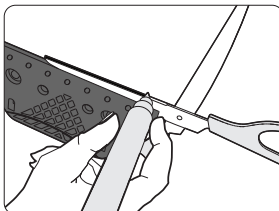

Color the bevel with a marker.

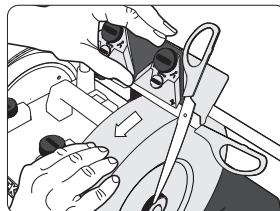

Place the holder against the support plate with the blade touching the grinding wheel. Rotate the grinding wheel by hand.

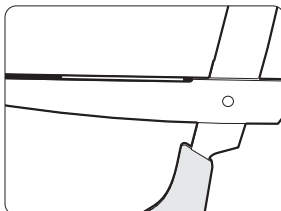

Check the bevel to see where the marker has worn off. Adjust the support plate until the grinding wheel removes the coloring from the entire width of the bevel.

2c. Setting a custom edge angle with WM-200 AngleMaster

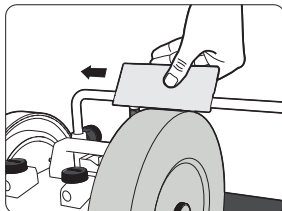

Slide the support plate onto the universal support. Adjust the height of the universal support so that there is approximately 1.5 mm of clearance between the support plate and the grinding wheel (this equals one full turn clockwise on the micro adjust).

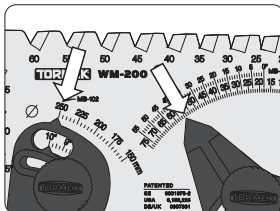

Set the WM-200 AngleMaster to the desired edge angle and adjust it to match the diameter of your grinding wheel.

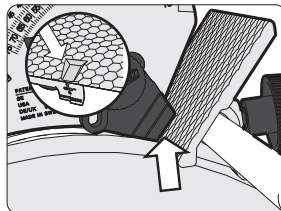

The AngleMaster is placed against the center indentation of the support plate or directly on the scissor blade to set the correct angle.

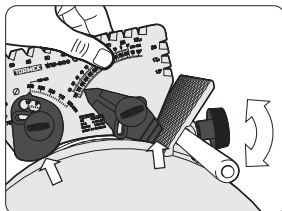

Adjust the support plate until both measuring surfaces of the AngleMaster are in full contact with the grinding wheel and the indentation on the support plate, then lock it in place.

3. Sharpening

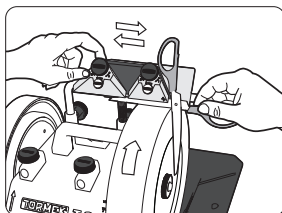

Place the holder on the support plate and keep it pressed against the plate at all times. Apply light pressure to the grinding wheel.

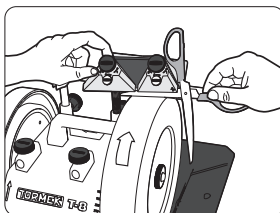

Move the holder back and forth across the grinding wheel while following the shape of the blade.

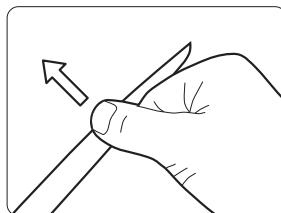

Sharpen until a burr forms along the entire edge, and the bevel is evenly sharpened.

Note Because of the larger sharpening angle used for scissors, the burr can be less pronounced than you may be used to. Carefully inspect the entire edge to ensure you do not miss the burr before proceeding; this helps avoid unnecessary material removal.

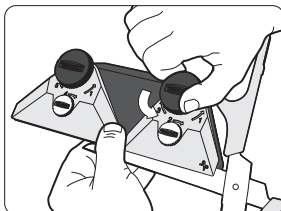

To sharpen the second blade, loosen the knobs and remove the scissors from the holder.

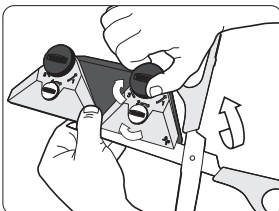

Flip the scissors and mount the second blade in the holder using the same procedure as previously described in step 1.

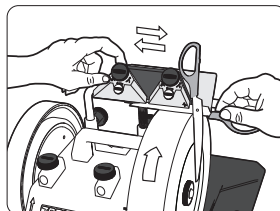

Repeat the sharpening process for the second blade.

Note Sharpening scissors will often produce a loud screeching sound, that's completely normal. Protect your ears accordingly.

Important! Use very light pressure when sharpening with a diamond grinding wheel to prevent damage to the grinding wheel.

No honing

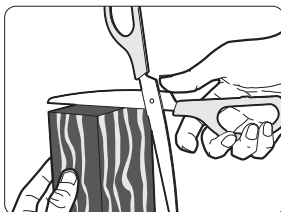

Do not hone the edge after sharpening scissors! There is no need for a finer surface—on the contrary, a slightly coarser edge actually improves the performance of the scissors. The coarser surface provides better grip on the material being cut, such as fabric or paper, reducing slippage and makes cutting easier. To remove the small burr created during sharpening, simply draw the scissors through the end grain of a piece of wood.

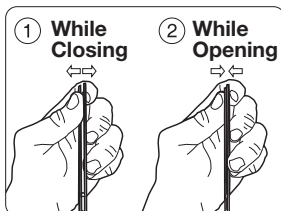

You can also remove the burr by pressing the tips of the blades **apart** while **closing** the scissors. Then **open** them again while pressing the blades gently **towards** each other.

Left-handed scissors

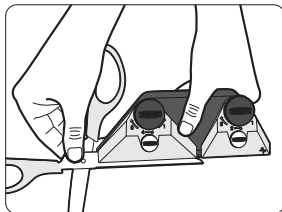

Left-handed scissors are sharpened edge trailing (with the grinding wheel rotating away from the edge), with the scissors mounted in the larger clamp.

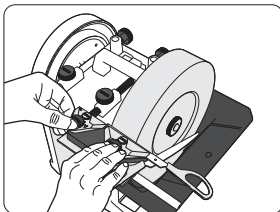

Place the Universal support plate horizontally and mount the support plate. Set the edge angle using one of the three methods described on page 4 to 6.

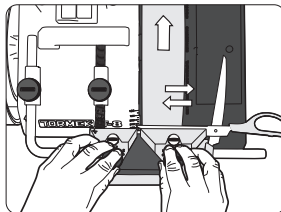

Sharpen by moving the holder back and forth across the grinding wheel, following the shape of the blade, while pressing it firmly against the support plate. Then dismount the scissors, flip them, mount the second blade, and sharpen it using the same procedure.

Larger scissors and hedge shears

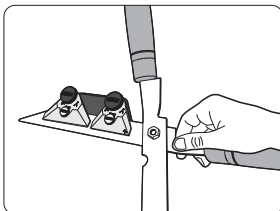
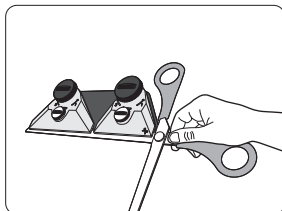

This is how to mount larger scissors and hedge shears in the holder.

Note Hedge shears often have a bevel angle of 35°–40°. Therefore, we do not recommend using the quick guide for a 60-degree edge angle for sharpening hedge shears, as it does not match the typical factory angle.

Wavy shears and pinking scissors

While the SC-60 Scissors Jig handles standard shapes with ease, it may have limitations when it comes to scissors with unconventional edges such as wavy shears or pinking scissors. You can experiment with different models with the machine turned off, and carefully see if your specific, unconventional scissors or shears will be sharpenable. We do not recommend using the SC-60 Scissors Jig to sharpen hair-dressing scissors due to their special geometry.

Important! Do not use diamond grinding wheels for sharpening wavy blades or pinking scissors.

Portable electric planer blades

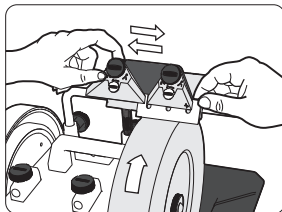

Portable electric planer blades are sharpened in the same way as scissors. Set the edge angle using the marker method or the WM-200 AngleMaster. Unlike scissors, both the bevel and the back of the blade should be honed. After sharpening, keep the blade in the holder and hone the bevel. Then remove the blade to hone the back. Alternate between the two sides until the burr is completely removed. We do not recommend sharpening planer blades made of tungsten carbide.

Using the SC-60 Scissors Jig on the Tormek T-2 Pro Kitchen Knife Sharpener

The SC-60 Scissors Jig is also compatible with the Tormek T-2 Pro Kitchen Knife Sharpener, allowing you to sharpen the most commonly used kitchen scissors.

1. Mounting the support plate

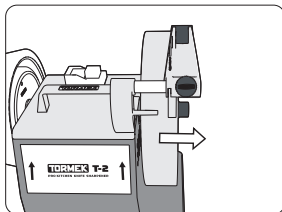

Remove the knife guide.

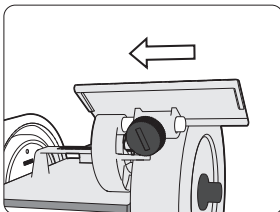

Slide the support plate onto the shaft.

The edge angle is set by adjusting the support plate. You can either set a general 60-degree angle using the jig's marked guide (2a) or repeat the existing angle (2b).

2a. Setting a 60 degree edge angle

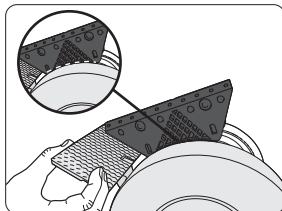

Position the holder against the support plate on the inside of the grinding wheel. Use the marked guide on the back of the holder to set a 60° edge angle.

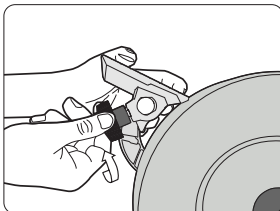

Secure the support plate using the knob.

2b. Repeat the existing edge angle

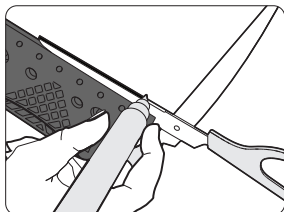

To repeat the edge angle, start by mounting the scissors as described in step 3 below. With the scissors mounted in the holder, color the bevel with a marker.

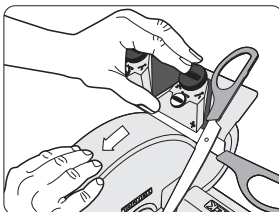

Place the holder against the support plate with the blade touching the grinding wheel. Rotate the grinding wheel by hand.

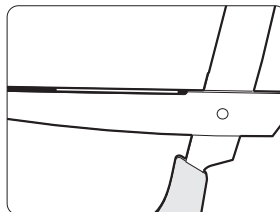

Check the bevel to see where the marker has worn off. Adjust the support plate until the grinding wheel removes the coloring from the entire width of the bevel.

3. Mounting the scissors in the holder

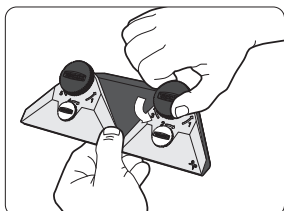

Loosen both knobs fully (1), without removing them.

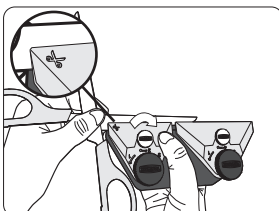

Place the base of the blade at the scissors symbol. Adjust the clamp to the thickness of the scissors using the screw on the smaller clamp (2).

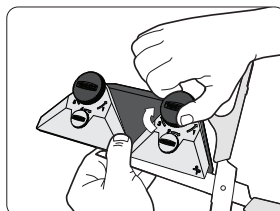

Tighten the knob (3) on the smaller clamp to secure the scissors. Repeat these steps for the larger clamp (4 and 5).

Important Make sure the scissors are open at least 90 degrees to prevent the other blade from coming into contact with the side of the grinding wheel. If necessary, disassemble the scissors and sharpen the blades separately.

Note To sharpen left-handed scissors, follow the mounting instructions on page 8.

4. Sharpening

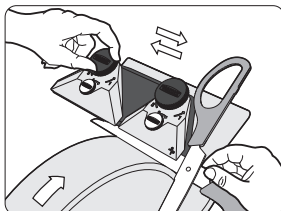

Place the holder on the support plate and keep it pressed against the plate at all times. Apply light pressure against the diamond grinding wheel.

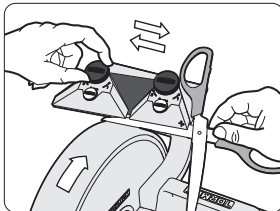

Move the holder back and forth across the grinding wheel while following the shape of the blade, until a burr forms along the entire edge.

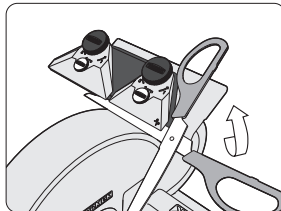

Dismount the scissors, flip them, mount the second blade, and sharpen it using the same procedure.

Note Because of the larger sharpening angle used for scissors, the burr can be less pronounced than you may be used to. Carefully inspect the entire edge to ensure you do not miss the burr before proceeding; this helps avoid unnecessary material removal.

Note On the Tormek T-2 Pro Kitchen, you can sharpen scissors with a blade length of up to 120 mm (measured from the pivot point to the tip). Scissors longer than this can only be sharpened if they can be disassembled, allowing each blade to be sharpened separately. On scissors with larger handles, the handle may come into contact with the honing wheel during sharpening. In that case, you can remove the honing wheel, reattach the washer and the nut, and then start sharpening.

No honing

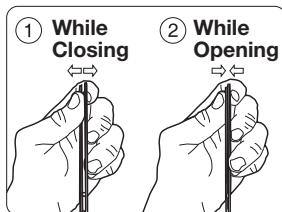

Do not hone the edge after sharpening scissors! There is no need for a finer surface—on the contrary, a slightly coarser edge actually improves the performance of the scissors. To remove the small burr created during sharpening, press the tips of the blades **apart** and **close** the scissors. Then **open** them again while pressing the blades gently **against** each other – this will help remove the burr.