

SXE 150-2.5 BL SXE 150-5.0 BL

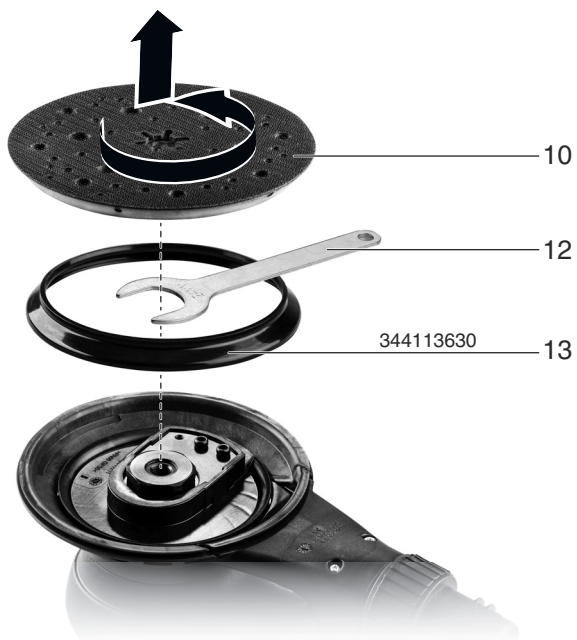

de Originalbetriebsanleitung 4
en Original operating instructions 8
fr Instructions d'utilisation originales 11
nl Originele gebruiksaanwijzing 15
it Manuale d'uso originale 19
es Manual de instrucciones original 23
pt Manual de instruções original 27
sv Original bruksanvisning 31

fi Alkuperäiskäyttöohje 34
no Original bruksanvisning 37
da Original brugsvejledning 40
pl Originalna instrukcja obsługi 43
el Πρωτότυπο οδηγιών λειτουργίας 47
hu Eredeti használati utasítás 51
ru Оригинальное руководство по эксплуатации 55

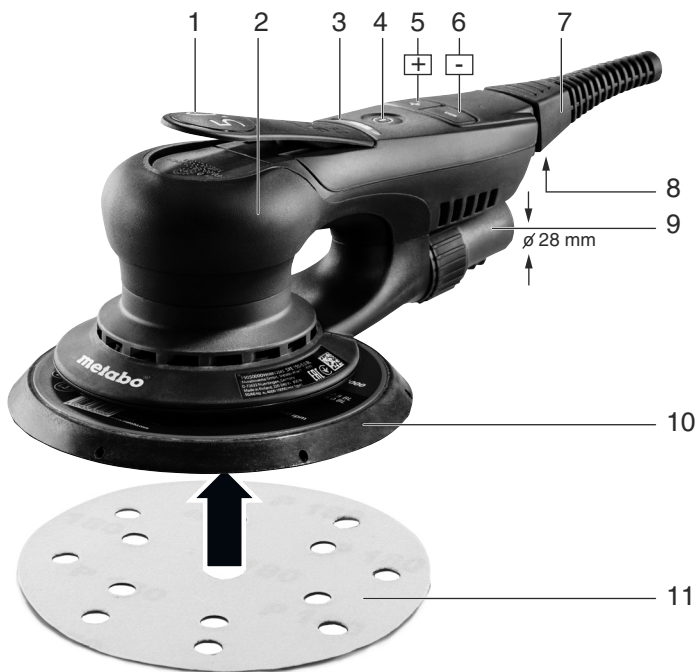

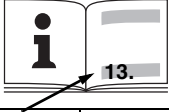
		SXE 150-2.5 BL *1) Serial Number: 15025..	SXE 150-5.0 BL *1) Serial Number: 15050..
D	mm (in)	150 (6)	
P₁	W	350	
n₀	min ⁻¹ (rpm)	4000 - 10000	
n₁	min ⁻¹ (rpm)	10000	
S	mm (in)	2,5 (³ / ₃₂)	5,0 (³ / ₁₆)
m	kg (lbs)	1,0 (2.2)	
a_{h,DS}/K_{h,DS}	m/s ²	2,4 / 1,5	3,4 / 1,5
L_{pA}/K_{pA}	dB(A)	71 / 3	
L_{WA}/K_{WA}	dB(A)	82 / 3	

CE *2) 2014/30/EU, 2006/42/EC, 2011/65/EU
*3) EN 62841:2015, EN 62841-2-4:2014, EN IEC 63000:2018

2021-07-22, Bernd Fleischmann *ppa. B.F.*
Direktor Produktentstehung & Qualität (Vice President Product Engineering & Quality)
*4) Metabowerke GmbH - Metabo-Allee 1 - 72622 Nuertingen, Germany

Original operating instructions

1. Declaration of Conformity

We, being solely responsible, hereby declare that these orbital sanders, identified by type and serial number *1), meet all relevant requirements of directives *2) and standards *3). Technical documents for *4) - see page 3.

For UK only:

UK We as manufacturer and authorized person to **CA** compile the technical file, see *4) on page 3, hereby declare under sole responsibility that these orbital sanders, identified by type and serial number *1) on page 3, fulfill all relevant provisions of following UK Regulations S.I. 2016/1091, S.I. 2008/1597, S.I. 2012/3032 and Designated Standards EN 62841:2015, EN 62841-2-4:2014, EN IEC 63000:2018.

2. Specified Conditions of Use

The machine is suitable for dry sanding of flat and elliptical surfaces, wood, plastics, non-ferrous metals, sheet metal and similar filled and painted surfaces.

The user bears sole responsibility for any damage caused by inappropriate use.

Generally accepted accident prevention regulations and the enclosed safety information must be observed.

3. General Safety Information



For your own protection and for the protection of your electrical tool, pay attention to all parts of the text that are marked with this symbol!



WARNING – Reading the operating instructions will reduce the risk of injury.



WARNING – Read all safety warnings, instructions, illustrations and specifications provided with this power tool. Failure to follow all instructions listed below may result in electric shock, fire and/or serious injury.

Save all warnings and instructions for future reference. Pass on your electrical tool only together with these documents.

4. Special Safety Instructions

Hold the power tool by insulated gripping surfaces, because the sanding surface may contact its own cord. Cutting a "live" wire may make exposed metal parts of the power tool "live" and could give the operator an electric shock.

Pull the plug out of the socket before making any adjustments, changing tools, carrying out maintenance or cleaning.

Secure the workpiece against slipping, e.g. with the help of clamping devices.

Wear ear protectors when working for long periods of time. High noise levels over a prolonged period of time may affect your hearing.

Hold the machine from the handles provided.

Reducing dust exposure:

! WARNING - Some dust created by power sanding, sawing, grinding, drilling, and other construction activities contains chemicals known to cause cancer, birth defects or other reproductive harm. Some examples of these chemicals are:

- Lead from lead-based paints,
- Crystalline silica from bricks and cement and other masonry products, and
- Arsenic and chromium from chemically treated lumber.

Your risk from these exposures varies, depending on how often you do this type of work. To reduce your exposure to these chemicals: work in a well ventilated area, and work with approved safety equipment, such as those dust masks that are specially designed to filter out microscopic particles.

This also applies to dust from other materials such as some timber types (like oak or beech dust), metals, asbestos. Other known diseases are e.g. allergic reactions, respiratory diseases. Do not let dust enter the body.

Observe the relevant guidelines and national regulations for your material, staff, application and place of application (e.g. occupational health and safety regulations, disposal).

Collect the particles generated at the source, avoid deposits in the surrounding area.

Use suitable accessories for special work. In this way, fewer particles enter the environment in an uncontrolled manner.

Use a suitable extraction unit.

Reduce dust exposure with the following measures:

- do not direct the escaping particles and the exhaust air stream at yourself or nearby persons or on dust deposits,
- use an extraction unit and/or air purifiers,
- ensure good ventilation of the workplace and keep clean using a vacuum cleaner. Sweeping or blowing stirs up dust.
- Vacuum or wash the protective clothing. Do not blow, beat or brush.

5. Overview

See page 2.

- 1 Lever
- 2 Handle
- 3 Electronic signal indicator
- 4 On/Off button
- 5 Button to increase the speed
- 6 Button to reduce the speed
- 7 Mains cable

- 8 Mains cable lock
- 9 Extractor connection piece
- 10 Support plate
- 11 Sanding disc
- 12 Open-end wrench
- 13 Braking ring of support plate brake

6. Initial Operation

 Before plugging in, check that the rated mains voltage and mains frequency, as stated on the type plate match your power supply.

 The machine must only be connected to a socket that has been properly earthed in accordance with regulations.

 Always install a universal current sensitive ground fault circuit interruptor (type B RCD) with a maximum trip current of 30 mA upstream.

If an extension cord is needed, it must be a three-core lead with a protective (earth) contactor that is properly connected to both the plug and the coupler of the cord.

6.1 Installation of sanding disc

Simple attachment and removal thanks to the hook and loop-type fastening. Simply press on the sanding disc so that the holes in the sanding disc (11) are aligned with the support plate (10).

6.2 Connect dust extraction

To optimise the dust extraction performance, fit the sanding disc (11) so that the holes on the sanding disc are aligned to the support plate (10).

Connect a suitable extraction device to the extractor connection piece (9).

6.3 Connect the mains cable at the device

Connection: Insert mains cable (7) until the stop. The mains cable lock engages.

Removal: Press mains cable lock (8) and remove mains cable (7).

Connect the mains cable to an earthed socket.

7. Use

7.1 On/Off switch, setting the speed

Switch on the machine by pressing the **On / Off key** (4). The electronic signal indicator (3) now lights up green.

The machine can now be put into operation by **pressing down the lever** (1).

The machine has 2 operating modes to set the speed. **To change between the operating modes, press key (5) and key (6) simultaneously.**

Operating mode 1:

The speed can be controlled in a linear manner by changing the lever position (1).

Operating mode 2:

By pressing the keys (5) or (6) the max. speed increases / reduces by 1000 min⁻¹ (rpm). This can also be done during operation.

The best way to determine the ideal setting is through a practical trial.

Switch off the machine after the grinding process, by pressing the **On / Off key** (4).

7.2 Working Directions

Bring the support plate (10) in contact with the workpiece and only then switch on the machine.

To end the grinding process, lift the support plate (10) off the workpiece and only then switch off the machine.

This prevents the formation of grooves in the surface due to excessive speeds of the grinding media.

8. Cleaning, maintenance

 Pull the plug out of the socket before making any adjustments, changing tools, carrying out maintenance or cleaning.

Regularly check the device, the support plate, the mains cable and the connections for wear.

The clean the machine regularly, frequently and thoroughly. This includes vacuum cleaning the ventilation louvres on the motor.

Clean the support plate as required (vacuum off the dust). This increases the service life of the hook and loop-type fastening.

Replacing a worn support plate

1. Put the open-end wrench (12) between support plate (10) and braking ring (13) and thus lock the spindle.
2. Turn the support plate (10) anti-clockwise (seen from below) to remove it.
3. Mount the new support plate (order no.: 6.30259000) always with the supplied, pre-mounted washers.
4. Remove the open-end wrench (12).

Replacing a support plate brake / braking ring

If the idle speed of the support plate increases in course of time, the braking ring (13) is worn and must be replaced.

Note: If abrasive material (e.g. gypsum, etc.) is being sanded, the braking ring inevitably wears faster.

Note: An excessive suction output of your extraction device may lead to a malfunction of the support plate brake.

1. Remove the support plate (10), as shown above.
2. Remove the old braking ring (13) from its groove and replace with a new braking ring (order no.: 344113630).
3. Reattach the support plate (10) as described above.

9. Troubleshooting

- **The electronic signal indicator (3) flashes red and green alternately:**

The machine is connected to a socket with incorrect voltage.

Before commissioning, check that the rated mains voltage, as stated on the type plate match your power supply.

- **The electronic signal indicator (3) does not light up when the machine is switched on:**

The mains cable (7) is not connected properly to the machine or mains socket.

Connect the machine properly.

- **Overload protection: The electronic signal indicator (3) lights red and the speed of the machine drops to 4000 min⁻¹ (rpm) during the grinding process:**

The temperature in the machine is too high. The pressure on the machine is too high for a longer time.

Exert less pressure on the machine for a moment, then the speed of the machine will increase again.

- **Overload protection: The electronic signal indicator (3) lights red and the speed of the machine decreases slightly:**

The pressure on the machine is too high for a short time.

Exert less pressure on the machine, then the LED indicator (3) automatically switches back to green.

- **Electronic safety shutdown: The electronic signal indicator (3) lights red and the machine has stopped:**

The machine is in safety mode due to the high temperature.

Wait until the machine has cooled down and the electronic signal indicator goes off.

- **The support plate brake does not work:**

Work braking ring (13) or damaged spindle bearing.

Check the braking ring (13) and replace if required (see chapter 8.). If the spindle bearing is defective, have it replaced (see chapter 11.).

10. Accessories

Use only genuine Metabo accessories.

Note: Metabo accessories are adapted to suit the machine's hook and loop-type fastening. This increases the service life of the hook and loop-type fastening.

Use only accessories which fulfil the requirements and specifications listed in these operating instructions.

See www.metabo.com or the catalogue for a complete range of accessories.

11. Repairs

 Repairs to electrical tools must be carried out by qualified electricians ONLY!

A defective mains cable must only be replaced with a special, original mains cable from metabo, which is available only from the Metabo service.

If you have Metabo electrical tools that require repairs, please contact your Metabo service centre. For addresses see www.metabo.com.

You can download spare parts lists from www.metabo.com.

12. Environmental Protection

Observe national regulations on environmentally compatible disposal and on the recycling of disused machines, packaging and accessories.



Only for EU countries: never dispose of power tools in your household waste! Used power tools must be collected separately and handed in for environmentally compatible recycling in accordance with European Directive 2012/19/EU on waste electrical and electronic equipment and its implementation in national legal systems.

13. Technical Specifications

Explanatory notes on the specifications on page 3. Changes due to technological progress reserved.

D	= Diameter of support plate
P ₁	= Rated input power
n ₀	= Idle speed
n ₁	= Speed at rated load
S	= Oscillating circuit diameter
m	= Weight without mains cable

Measured values determined in conformity with EN 62841.

~ AC Power

Machine in protection class I

The technical specifications quoted are subject to tolerances (in compliance with the relevant valid standards).



Emission values

These values make it possible to assess the emissions from the power tool and to compare different power tools. The actual load may be higher or lower depending on the operating conditions, the condition of the power tool or the accessories. Please allow for breaks and periods when the load is lower for assessment purposes. Arrange protective measures for the user e.g. organisational measures based on the adjusted estimates.

Vibration total value (vector sum of three directions) determined in accordance with EN 62841:

a_{h, DS} = Vibration emission value (surface grinding)

K_{h, DS} = Uncertainty (vibration)

Typical A-effective perceived sound levels:

L_{pA} = Sound-pressure level

L_{WA} = Acoustic power level

K_{pA}, K_{WA} = Uncertainty

The noise level can exceed 80 dB(A) during operation.



Wear ear protectors!