

Instruction Manual

— Dust collector

— SAA 2203 UT



SAA 2203 UT

SAA 2203 UT

Imprint

Product identification

Dust collector	Item number
SAA 2203 UT	5922123

Manufacturer

Stuermer Maschinen GmbH
 Dr.-Robert-Pfleger-Str. 26
 D-96103 Hallstadt

Fax: 0049 (0) 951 96555 - 55

E-Mail: info@holzstar.de
 Internet: www.holzstar.de

Information on the operating instructions

Original operating instructions
 according to DIN EN ISO 20607:2019
 Edition: 14.06.2022
 Version: 1.03
 Language: English
 Author: MS/FL

Copyright information

Copyright © 2022 Stürmer Maschinen GmbH, Hallstadt, Germany.

Technical changes and errors excepted.

Contents

1 Introduction	3
1.1 Copyright	3
1.2 Customer service	3
1.3 Limitation of liability	3
2 Safety	3
2.1 Symbol explanation	3
2.2 Responsibility of the operator	4
2.3 Staff qualification	4
2.4 Personal protective equipment	5
2.5 Safety markings on the Dust collector	5
2.6 General safety measures	6
2.7 Safety data sheets	6
3 Intended use	6
3.1 Reasonably foreseeable misuse	6
3.2 Residual risks	7
4 Technical data	7
4.1 Table	7
4.2 Dimension drawing	7
4.3 Type plate	7
5 Description of the device	8
5.1 Scope of delivery	8
5.2 Accessories	8
6 Transport, packing, storage	8
6.1 Delivery and Transport	8
6.2 Packaging	9
6.3 Storage	9
7 Set up and connection	9
7.1 Requirements for the installation site	9
7.2 Assembly of the exhaust system	9
7.3 Electrical connection	10
7.4 Static charge	10
7.5 Commissioning	11
8 Operation	11
8.1 Switch on	11
8.2 Switch off	11
8.3 Emptying the filter and dust bag	11
9 Care, maintenance and repair	11
9.1 Cleaning	12
10 Disposal, recycling of old equipment	12
10.1 Decommission	12
10.2 Disposal of electrical devices	12
10.3 Disposal via municipal collection points	12
11 Troubleshooting	13
12 Spare parts	13
12.1 Ordering spare parts	13
12.2 Spare parts drawing	14
12.3 Parts list	15
13 Electrical schematic	16
14 EC-Declaration of Conformity	17

1 Introduction

You have made a good choice by purchasing the Dust collector from HOLZSTAR.

Read the operating instructions carefully before commissioning.

It will inform you about the proper start-up, the intended use as well as the safe and efficient operation and maintenance of your Dust collector.

The operating manual is an integral part of the Dust collector. Always keep these operating instructions at the place of use of your Dust collector. In addition, observe the local accident prevention regulations and general safety regulations for the area of use of the Dust collector.

1.1 Copyright

The contents of these instructions are protected by copyright and are the sole property of Stürmer Maschinen GmbH. Their use is permitted within the scope of the use of the Dust collector. Any other use is not permitted without the written consent of the manufacturer.

Passing on as well as duplication of this document, utilization and communication of its contents are forbidden, as far as not expressly permitted. Violations will result in liability for damages. We register trademarks, patents and design rights for the protection of our products, patent and design rights, insofar as this is possible in individual cases. We emphatically oppose any infringement of our intellectual property.

1.2 Customer service

Please contact your specialist dealer if you have any questions about your extraction system or for technical information. They will be happy to provide you with expert advice and information.

Germany:

Stürmer Maschinen GmbH
Dr.-Robert-Pfleger-Str. 26
D-96103 Hallstadt

Repair service:

Fax: 0049 (0) 951 96555-111
E-Mail: service@stuermer-maschinen.de
Internet: www.holzstar.de

Ordering spare parts:

Fax: 0049 (0) 951 96555-119
E-Mail: ersatzteile@stuermer-maschinen.de

We are always interested in information and experiences that result from the application and can be valuable for the improvement of our products.

1.3 Limitation of liability

All information and notes in these instructions have been compiled taking into account the applicable standards and regulations, the state of the art and our many years of knowledge and experience.

The manufacturer accepts no liability for damage in the following cases:

- Non-observance of these instructions
- Non-intended use
- Use of untrained personnel
- Unauthorized modifications
- Technical modifications
- Use of unauthorized spare parts

The actual scope of delivery may deviate from the explanations and representations described here in the case of special versions, when additional order options are used or due to the latest technical changes.

The obligations agreed in the delivery contract, the general terms and conditions as well as the delivery conditions of the manufacturer and the legal regulations valid at the time of the conclusion of the contract shall apply.

2 Safety

This section provides an overview of all important safety packages for the protection of persons and for safe and trouble-free operation. Further task-related safety instructions are contained in the individual chapters.

2.1 Symbol explanation

Safety instructions

Safety instructions are identified in these operating instructions by symbols. The safety instructions are introduced by signal words that express the extent of the hazard.



DANGER!

This combination of symbol and signal word indicates an immediately dangerous situation. It will result in death or serious injury if not avoided.

WARNING!

This combination of symbol and signal word indicates an imminently hazardous situation which, if not avoided, will result in death or serious injury.

CAUTION!

This combination of symbol and signal word indicates a potentially hazardous situation which, if not avoided, may result in minor or moderate injury.

ATTENTION!

This combination of symbol and signal word indicates a possibly hazardous situation which, if not avoided, may result in damage to property and the environment.



NOTE!

This combination of symbol and signal word indicates a possibly hazardous situation which, if not avoided, may result in damage to property and the environment.

Tips and recommendations



Tips and recommendations

This symbol highlights useful tips and recommendations as well as information for efficient and trouble-free operation.

To reduce the risks of personal injury and damage to property and to avoid dangerous situations, the safety instructions given in these operating instructions must be observed.

2.2 Responsibility of the operator

The operator is the person who operates the machine himself for commercial or economic purposes or who makes it available to a third party for use or application and who bears the legal product responsibility for the protection of the user, personnel or third parties during operation.

Obligations of the operator:

If the machine is used in the commercial sector, the operator of the machine is subject to the legal obligations for occupational safety. Therefore, the safety instructions in this operating manual as well as the safety, accident prevention and environmental protection regulations valid for the area of application of the machine must be observed. The following applies in particular:

- The operator must inform himself about the applicable occupational health and safety regulations and, in a risk assessment, additionally determine hazards that result from the special working conditions at the place of use of the machine. He must implement these in the form of operating instructions for the operation of the machine.
- During the entire period of use of the machine, the operator must check whether the operating instructions he has created correspond to the current status of the regulations and, if necessary, adapt them.
- The operator must clearly regulate and define the responsibilities for installation, operation, troubleshooting, maintenance and cleaning.
- The operator must ensure that all persons handling the machine have read and understood these instructions. In addition, he must train the personnel at regular intervals and inform them about the dangers.
- The operator must provide the personnel with the required protective equipment and instruct them to wear the required protective equipment in a binding manner.

Furthermore, the operator is responsible for ensuring that the machine is always in technically perfect condition. Therefore, the following applies:

- The operator must ensure that the maintenance intervals described in these instructions are observed.
- The operator must have all safety devices checked regularly for functionality and completeness.

2.3 Staff qualification

The various tasks described in this manual place different demands on the qualifications of the persons entrusted with these tasks.



WARNING!

Danger in case of insufficient qualification of persons!

Insufficiently qualified persons cannot assess the risks when handling the machine and expose themselves and others to the risk of serious or fatal injuries.

- All work must be carried out by qualified personnel only.
- Keep insufficiently qualified persons and children away from the work area.

Only persons who can be expected to perform this work reliably are permitted to perform any work. Persons whose ability to react is influenced by drugs, alcohol or medication, for example, are not permitted.

In these operating instructions, the qualifications of the persons listed below are named for the various tasks:

Operator:

The operator has been instructed by the operator about the tasks assigned to him and possible dangers in case of improper behavior. The operator may only perform tasks that go beyond operation during normal operation if this is specified in these operating instructions and the operator has expressly entrusted him with this task.

Electrician:

Due to their professional training, knowledge and experience as well as knowledge of the relevant standards and regulations, qualified electricians are able to carry out work on electrical systems and to independently recognize and avoid potential hazards.

Specialized personnel:

Due to their professional training, knowledge and experience as well as knowledge of the relevant standards and regulations, the qualified personnel are able to carry out the work assigned to them and to recognize possible hazards independently and to avoid hazards.

Manufacturer:

Certain work may only be carried out by specialist personnel of the manufacturer. Other personnel are not authorized to perform this work. Contact our customer service department to carry out the work in question.

2.4 Personal protective equipment

The personal protective equipment serves to protect persons against impairments to safety and health during work. The personnel must wear personal protective equipment during the various work on and with the machine, which is referred to separately in the individual sections of these instructions.

The personal protective equipment is explained in the following section:



Respiratory protection

Respiratory protection is used to protect the respiratory tract and lungs from the ingestion of dust particles.



Hearing protection

Hearing protection protects against hearing damage caused by noise.



Safety goggles

The safety goggles are used to protect the eyes from flying parts.



Protective gloves

The protective gloves are used to protect the hands from sharp-edged components, as well as from friction, abrasions or deeper injuries.



Safety shoes

The safety shoes protect the feet from crushing, falling parts and slipping on slippery surfaces.



Protective work clothing

Protective work clothing is tight-fitting work clothing, without protruding parts, with low tear resistance.

2.5 Safety markings on the Dust collector

The following safety markings are attached to the Dust collector (Fig. 1), which must be observed and followed.



Fig. 1: Safety labels

The safety markings attached to the machine must not be removed. Damaged or missing safety markings can lead to incorrect actions, personal injury and damage to property.

They must be replaced immediately. If the safety markings are not recognizable and comprehensible at first glance, the machine must be taken out of operation until new safety markings have been applied.

2.6 General safety measures

- The extraction system may only be operated and maintained by persons who have read and understood these operating instructions. The operator must be sufficiently trained in the use, setting and operation.
- Do not switch on the machine until immediately before starting the extraction work. Do not leave the machine, which is ready for operation, unattended.
- Never open the protective covers while the extraction system is in operation.
- Keep the workplace and the floor in the vicinity of the extraction system free of any objects that could endanger your stability or pose a tripping hazard. Keep the workplace tidy. Disorder can result in accidents.
- Check the danger zone before and during work to ensure that no unauthorized persons are present.
- Do not use the machine in the vicinity of flammable gases, liquids and solids. There is a risk of explosion or fire due to possible flying sparks.
- Use the machine only in dry rooms or in dry surroundings and ensure that the working area is sufficiently illuminated.
- Protect the machine from moisture and humidity to avoid electrical hazards.
- Ensure that the extraction hose is connected to the extraction system and machine before starting it up.
- Wood dust is explosive and can be harmful to health. In particular, tropical woods and hard woods such as beech and oak are classified as hazardous to health.
- Only operate the machine with safety devices fully and correctly attached and do not modify anything on the machine that could affect safety.
- Always wear hearing protection when working with the extraction system. Wearing loose clothing (ties, scarves, open jackets and clothing that is not tight-fitting) is prohibited. If you have long hair, wear a hair net.
- Do not vacuum flammable gases or materials (e.g. paint or paint mist) or metallic parts.
- Only use original spare parts.

- To protect against electric shock, have the machine connected to a suitable and fused power supply only by a qualified electrician.
- Protect the power supply cable from heat, oil and sharp edges..
- Replace a damaged power cord immediately.
- When laying the power cable, make sure that it is not crushed, bent or wet.
- Only use chip and filter bags that are not damaged. Replace damaged chip and filter bags immediately.
- Check that all repair and adjustment tools have been removed before switching on.
- Before every maintenance and every change of chip and filter bags, the extraction system must be secured against start-up.
- A dust protection mask (filter mask with particle filter) must be worn when changing and emptying the chip bag.
- To avoid contact with the rotating fan wheel, unused extraction connections must always be covered.
- All protective and safety devices must be refitted immediately after repair or maintenance has been completed.

2.7 Safety data sheets

Safety data sheets on hazardous materials can be obtained from your specialist dealer or by calling +49 (0)951/96555-0. Specialist dealers can find safety data sheets in the download area of the partner portal.

3 Intended use

The dust collector is used for the extraction of milling, planing and sawing chips, which are produced during the processing of wood or wood-like materials.

The Dust collector may only be operated within the specified performance limits (Technical data).

The Dust collector is designed and built for use in a non-hazardous environment.

3.1 Reasonably foreseeable misuse

Possible misapplications may include:

- Use of the extraction unit in areas where there are aggressive, flammable or explosive substances or gases in the air (the extraction unit is not explosion-proof as standard).
- The use of an incompletely assembled unit.
- Modifications to the unit or the use of modified accessories.

- Installation of spare parts and use of accessories and equipment not approved by the manufacturer.
- Failure to observe the signs of wear and damage.
- Failure to follow the maintenance instructions.
- Deliberate or careless handling of the extraction system during operation.
- Service work carried out by untrained or unauthorized personnel.
- Misuse of the extraction system.
- Generation of negative pressure on closed systems.
- Use of the system for commercial purposes.
- Use of the extraction system for drying objects.
- Operating the unit even though the operating instructions have not been read.

Misuse of the suction unit can lead to dangerous situations.

Stürmer Maschinen GmbH accepts no liability in the event of design or technical modifications to the unit.

Claims of any kind for damage due to improper use are excluded.

3.2 Residual risks

When used as intended, residual risks may arise even if the relevant safety regulations are observed.

- Hearing damage when working on the machine for long periods without hearing protection
- Fire hazard
- Electrostatic discharge at the suction hose
- Danger from electric current due to use of non-standard electrical connections
- Danger from wood dust
- Hazard to the upper limbs in case of accidental contact with the fan wheel

4 Technical data

4.1 Table

Model	SAA 2203 UT
Length	1540 mm
Width / Depth	550 mm
Height	750 mm
Weight	50 kg
Supply voltage	400 V
Nominal volume flow	2200 m³/h
Negative pressure max.	2200 Pa
Nominal size outside Suction connection Inlet	120 mm
Nominal size outside Suction connection Outlet	120 mm
Connection diameter filter bag	500 mm
Sound power level max.	96 dB(A)
Sound pressure level max.	89 dB(A)
Output power	1,65 kW
Absorbed power	2,2 kW

4.2 Dimension drawing

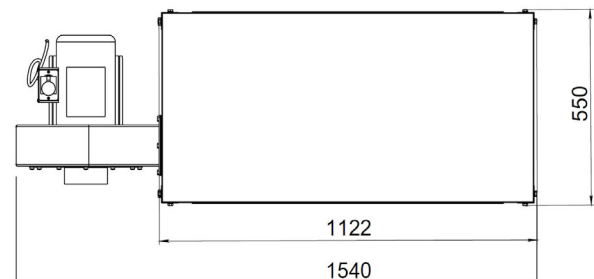

Fig. 2: Dimension drawing

4.3 Type plate





Absauganlage Dust collector		  	
Typ Type	SAA 2203 UT	Serien-Nr. Serial no.	
Artikel-Nr. Item no.	5922123	Baujahr <small>Monat/Jahr</small> Year of manufacture <small>month/year</small>	
Aufnahmeleistung Input power	2,2 kW	Netzanschluss Power connection	400 V / 3 ~ / 50 Hz
Abgabeleistung Output power	1,65 kW	Stutzen Eingang Nozzle inlet	Ø 120 mm
Max. Luftstrom Max. Airflow	2200 m³/h	Schalldruckpegel Sound pressure level	89 dB(A)
Gewicht Weight	50 kg		
 www.holzstar.de		Stürmer Maschinen GmbH Dr.-Robert-Pfleger-Str. 26, 96103 Hallstadt Deutschland / Germany	

Fig. 3: Type plate

5 Description of the device

Illustrations in these operating instructions are for basic understanding and may differ from the actual design.

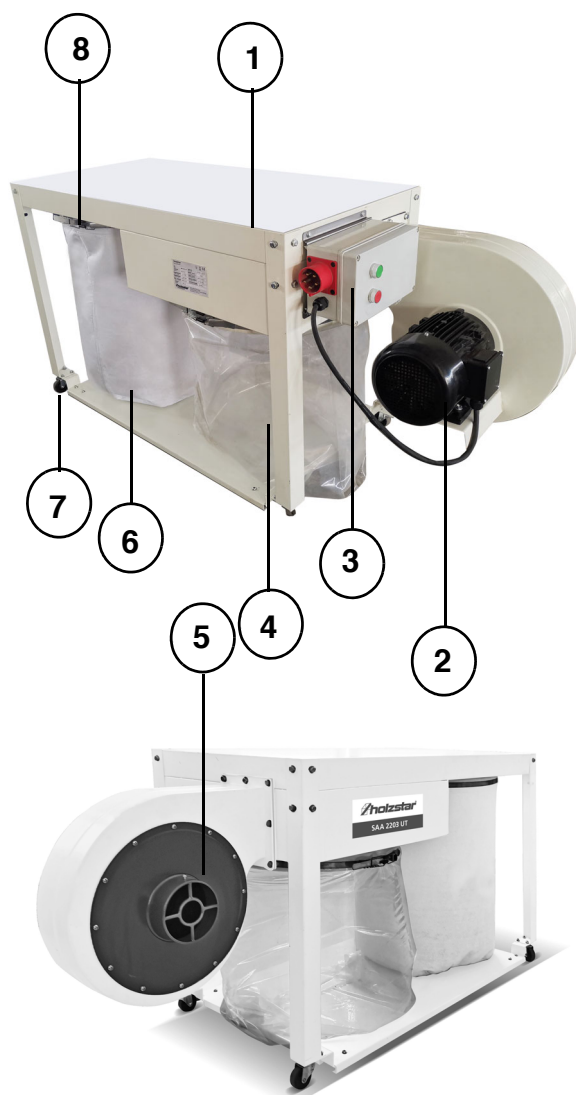

Fig. 4: Dust collector

- 1 Machine body
- 2 Motor
- 3 On / Off switch
- 4 Dust bag
- 5 Connection suction hose
- 6 Filter bag
- 7 Rollers
- 8 Tension belt Filter bag

5.1 Scope of delivery

- Machine body
- Filter bag
- Dust bag
- 4x Rollers
- 2x Tension belt

5.2 Accessories

Designation	Item number
Filter bag	5932123
Chip bag (1 pack = 10 pieces)	5932124
Polyurethane flexible hose NW 120mm - length 2.5 meters	5142504-2,5
Polyurethane flexible hose NW 120mm - length 5 meter	5142504-5
Polyurethane flexible hose NW 120mm - length 10 meters	5142504
Reducing coupling Ø-A 100 mm / Ø-I 120 mm	5148015

6 Transport, packing, storage

6.1 Delivery and Transport

Delivery

Check the Dust collector for visible transport damage after delivery. If you discover any damage to the Dust collector, report it immediately to the transport company or the dealer.

Transport



CAUTION!

Risk of injury from equipment falling over and off the forklift, lift truck or transport vehicle.

Only use transport vehicles and load slinging equipment that can take the total weight.

Improper transport of individual devices, packed or unpacked unsecured devices stacked on top of or next to each other is liable to cause accidents and may result in damage or malfunctions for which we do not grant any liability or warranty.

Transport the scope of delivery to the installation site secured against shifting or tipping with a sufficiently dimensioned industrial truck.

General hazards during in-house transport



CAUTION: DANGER OF TIPPING

The device may be lifted a maximum of 2cm without being secured. Employees must be outside the danger zone, the reach of the load.

Warn employees and point out the danger to employees.

Transport may only be carried out by authorized and qualified persons. When transporting, act responsibly and always consider the consequences. Refrain from daring and risky actions.

Slopes and inclines (e.g. driveways, ramps and the like) are particularly dangerous. If driving on such passages is unavoidable, special care must be taken.

Before starting transport, check the transport route for possible danger spots, unevenness and trouble spots as well as for sufficient strength and load-bearing capacity.

Danger points, unevenness and faults must be inspected before transport. The removal of hazardous points, unevenness and faults at the time of transport by other employees leads to considerable hazards.

Careful planning of in-house transport is therefore essential.

6.2 Packaging

All packaging materials and packaging aids used by Dust collector are recyclable and must always be recycled.

Packaging components made of cardboard should be shredded and taken to the waste paper collection.

The films are made of polyethylene (PE) and the padding parts of polystyrene (PS). These materials should be taken to a collection point for recyclable materials or to your local waste disposal company.

6.3 Storage

The Dust collector must be stored thoroughly cleaned in a dry, clean and frost-free environment. Cover the machine with a protective tarpaulin.

Transport and storage conditions: -25°C to +55°C.

7 Set up and connection

7.1 Requirements for the installation site

In order to achieve good function and a long service life of the Dust collector, the installation site should meet the following criteria:

- The surface must be level, firm and vibration-free.
- The installation or work area must be dry and well ventilated.
- Do not set up or operate the machine in a damp or wet environment. The humidity should be in the range of 30% to 95% and the measured ambient temperature should be between +5°C to +50°C.

- There must be sufficient space for the operating personnel, for material transport and for adjustment and maintenance work.
- Mains voltage and frequency should correspond to the characteristics of the machine's motor.

7.2 Assembly of the exhaust system



Wear protective gloves!



Wear safety shoes!



Wear protective work clothing!



DANGER!

The mains plug must be disconnected before all maintenance, conversion and assembly work on the extraction system!

Step 1: Unpack the machine and check that the scope of delivery is complete.

Step 2: Screw the cross struts to the base frame..

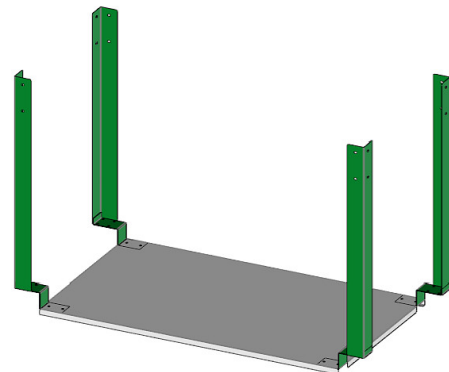

Fig. 5: Screw on cross struts

Step 3: Screw the base plate to the cross struts and base frame.

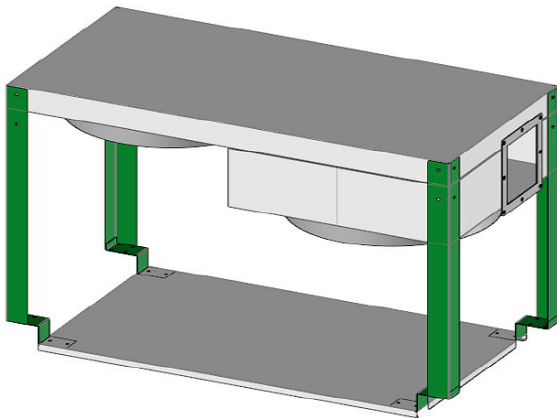

Fig. 6: Screw base plate

Step 4: Mount the suction connection to the base plate.

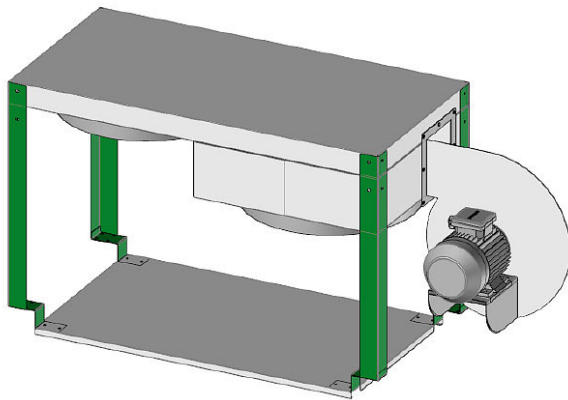

Fig. 7: Mount suction connection

Step 5: Insert the filter and dust bag using the tensioning straps.

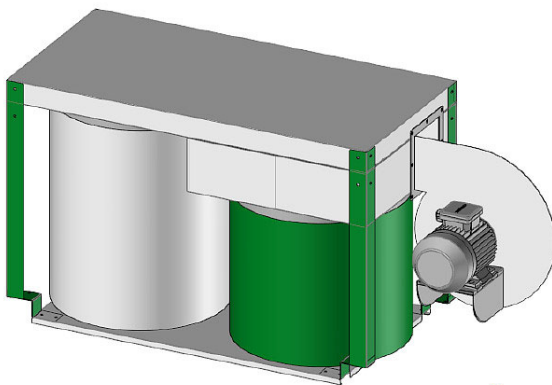

Fig. 8: Insert filter and dust bag

7.3 Electrical connection



DANGER!

Danger to life from electric shock!

Danger to life due to electric current!

In case of contact with live components, there is an immediate danger to life due to electric shock.

- The extraction system may only be connected by qualified electricians.
- Work on the electrical system may only be carried out by qualified electricians.

Connect the extraction unit to the mains in the following steps:

Step 1: Connect the extraction system to a woodworking machine.

Step 2: Connect the extraction system to a socket.

Step 3: Check that all safety devices are installed.

Step 4: Switch on the extraction system.

Step 5: Check that the direction of rotation of the motor is correct.

7.4 Static charge

Due to friction in the suction hose, a static charge can occur.

To prevent sparks from causing a dust explosion or fire, the static charge must be dissipated via the grounding. For this purpose, it is recommended that an exhaust hose with metal wire is used. The ends of the metal wire are then connected to the conductive housing of the extraction system and the machine to be extracted.

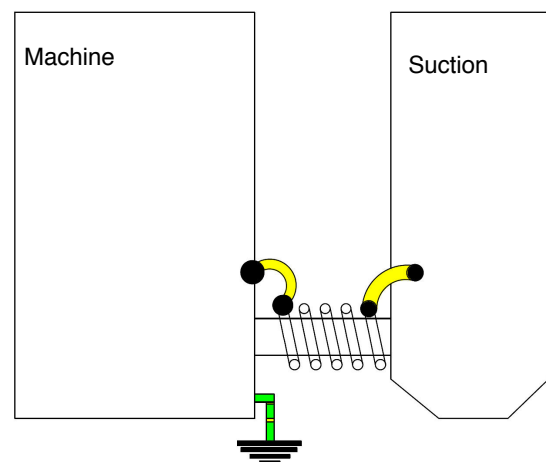

Fig. 9: Connection machine and exhaust system

7.5 Commissioning

Step 1: Check that the suction hose is firmly connected to the suction unit and to the suction connection of the woodworking machine.

Step 2: Check that the filter bag and dust bag are securely fastened.

8 Operation

8.1 Switch on

- Switch on the suction unit by pressing the green "I" key.
- Switch on the woodworking machine.

8.2 Switch off

- Switch off the woodworking machine.
- Switch off the extraction system by pressing the red "O" key..

8.3 Emptying the filter and dust bag

- Check and empty the filter and dust bag regularly.
ATTENTION: Pull out the mains plug!
- Hold the filled filter and dust bag with one hand.
- Open the tension belt.
- Remove the filter and dust bag and dispose of the contents in an environmentally friendly manner.
- Replace the empty filter and dust bag and secure it with the tensioning strap.

9 Care, maintenance and repair



Tips and recommendations

To ensure that the extraction system is always in good operating condition, regular care and maintenance work must be carried out.



DANGER!

Danger to life due to electric shock!

There is a danger to life in the event of contact with live components.

- Before starting cleaning and maintenance work, switch off the machine and disconnect the power plug.
- Connections and repairs of the electrical equipment may only be carried out by a qualified electrician.



WARNING!

Danger in case of insufficient qualification of persons!

Insufficiently qualified persons cannot assess the risks during repair work on the extraction system and expose themselves and others to the risk of serious or fatal injuries.

Have all maintenance work performed only by persons qualified to do so.

Daily care and maintenance

- Clean the machine after each use.
- Replace damaged safety devices immediately.

Weekly care and maintenance

- Clean the housing and machine surfaces.
- Clean guards, air vents, and motor housing.
- Change and empty the filter and dust bag.

Monthly maintenance

- Check the fastening screws of the machine and tighten them if necessary.
- Check electrical safety devices and guards and replace immediately if necessary.

9.1 Cleaning

Cleaning instructions for the extraction system

- Wear a dust mask (particle filter - filter class 2) when cleaning the machine and when emptying and changing the filter and dust bag.
- Clean the motor and switch with a dry cloth. Never use water!
- Clean housing and machine surfaces only with a damp cloth and some cleaning agent. Do not use solvents. These could attack the plastic parts of the machine. Make sure that no water can get into the interior of the machine.
- Keep guards, air slots and motor housings as free of dust and dirt as possible. Rub them with a clean cloth or blow out dust and dirt with compressed air at low pressure.
- Caution: Wear protective goggles when working with compressed air!
- Knock out the filter and dust bag beforehand when changing them.

10 Disposal, recycling of old equipment

In your own interest and in the interest of the environment, please ensure that all components of the machine are disposed of only via the designated and approved channels.

10.1 Decommission

Discarded devices must be taken out of service immediately in a professional manner in order to avoid later misuse and the endangerment of the environment or persons.

Step 1: Remove all environmentally hazardous operating materials from the old machine.

Step 2: If necessary, dismantle the machine into manageable and recyclable assemblies and components.

Step 3: Route the machine components and operating materials to the designated disposal channels.

10.2 Disposal of electrical devices

Please note that electrical equipment contains a variety of recyclable materials as well as components that are harmful to the environment.

Help to ensure that these components are disposed of separately and properly. If in doubt, please contact your municipal waste disposal service.

If necessary, enlist the help of a specialized disposal company for reprocessing.

10.3 Disposal via municipal collection points

Disposal of used electrical and electronic equipment (To be applied in the countries of the European Union and other European countries with a separate collection system for this equipment).



The symbol on the product or its packaging indicates that this product should not be treated as normal household waste, but must be taken to a collection point for the recycling of electrical and electronic equipment. By helping to dispose of this product correctly, you are protecting the environment and the health of those around you. Environment and health are endangered by incorrect disposal. Material recycling helps to reduce the consumption of raw materials. For more information about recycling this product, contact your local municipality, municipal waste disposal service or the store where you purchased the product.

11 Troubleshooting



DANGER!

If any of the following errors occur, stop working with the machine immediately. Serious injuries could result. All repairs or replacement work may only be carried out by qualified and trained personnel.

Fault	Possible cause	Remedy
Extraction unit does not switch on	<ol style="list-style-type: none"> 1. Power connection interrupted. 2. Motor connection not correct. 3. Switch defective 4. Motor defective. 	<ol style="list-style-type: none"> 1. Check power connection. 2. Check and correct motor connection 3. Repair or replace switch 4. Check motor and repair or replace
Strong vibrations	<ol style="list-style-type: none"> 1. Loose component 2. Loose or broken motor suspension 3. Motor bearing worn out 	<ol style="list-style-type: none"> 1. Check all connections, tighten bolts and nuts. 2. Fix or replace suspension. 3. Replace bearing
Poor suction.	<ol style="list-style-type: none"> 1. Filter or dust bag is full 2. Suction line undersized. 3. Suction line too long 	<ol style="list-style-type: none"> 1. Empty filter and dust bag. 2. Use a larger suction line. 3. Place the suction unit closer to the machine.

12 Spare parts



DANGER!

Risk of injury due to the use of incorrect spare parts!

The use of incorrect or faulty spare parts can result in danger to the operator and cause damage and malfunctions.

- Only original spare parts from the manufacturer or spare parts approved by the manufacturer are to be used.
- In case of any uncertainties, always contact the manufacturer.



NOTE!

Use of non-approved spare parts will void the manufacturer's warranty.

12.1 Ordering spare parts

The spare parts can be obtained from the specialist dealer. Specify the following key data when making inquiries or ordering spare parts:

- Device type
- Item number
- Position number
- Year of manufacture
- Quantity
- desired shipping method (mail, freight, sea, air, express)
- Shipping address

Spare parts orders without the above information cannot be considered. In the absence of information on the shipping method, shipping will be at the discretion of the supplier.

Information on the device type, article number and year of manufacture can be found on the type plate attached to the machine.

Example

The motor for the Dust collector SAA 2203 UT must be ordered. The motor has the number 28 in the spare parts drawing 1.

When ordering spare parts, send a copy of the spare parts drawing (1) with the marked component (motor) and marked item number (28) to the authorized dealer or to the spare parts department and provide the following information:

- Type of device: **Dust collector SAA 2203 UT**
- Item number: **5922123**
- Drawing number: **1**
- Position number: **28**

The following drawing should help to identify necessary spare parts in case of service. To order, send a copy of the parts drawing with the marked components to your authorized dealer.

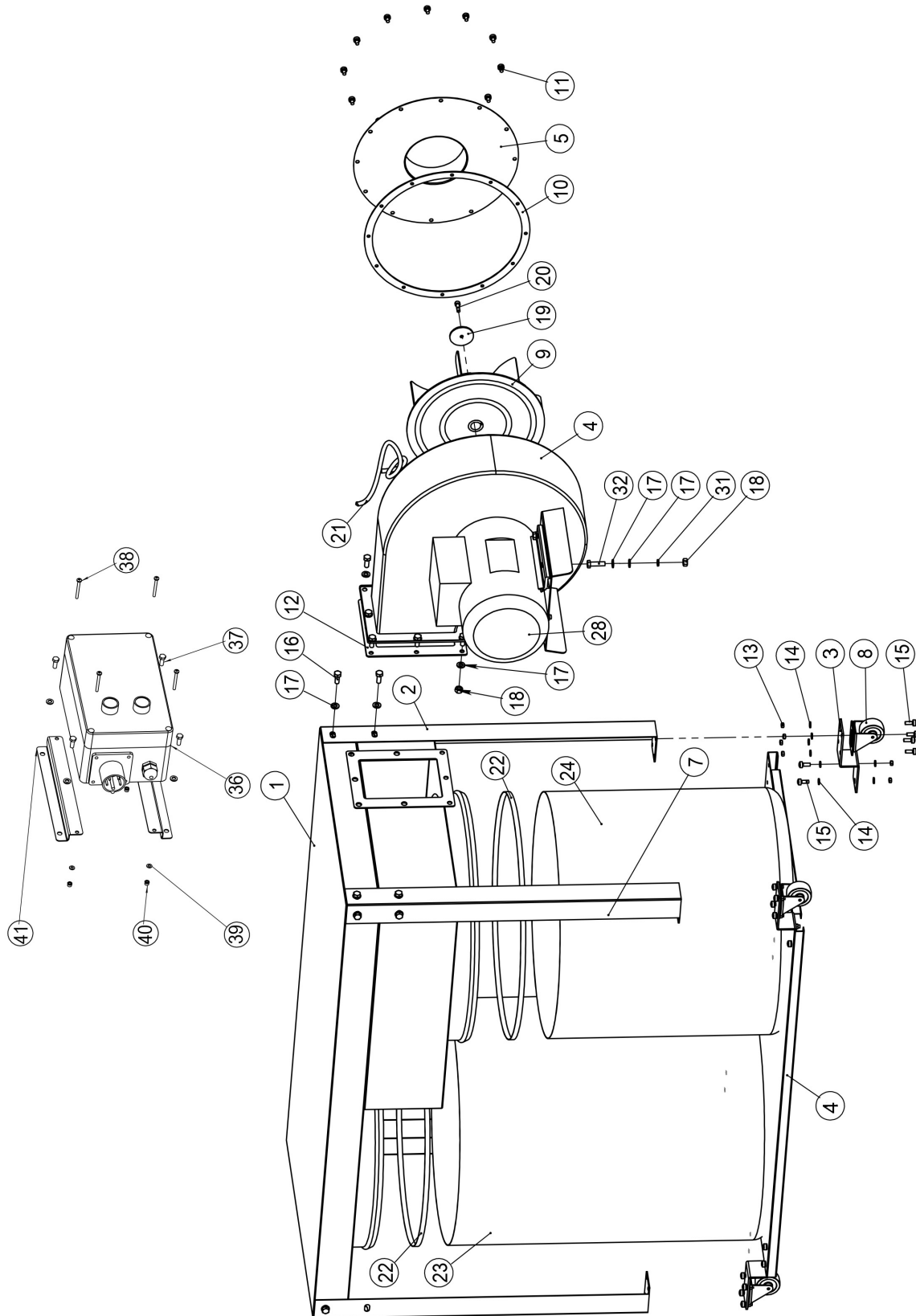

SAA 2203 UT | Version 1.03

12.3 Parts list

Position number	Description	Quantity
1	Welding body	1
2	Left support leg	2
3	Z type plate	4
4	Base plate	1
5	Impeller housing	1
6	Inlet cover	1
7	Right support leg	2
8	Castor	4
9	Impeller	1
10	Inlet gasket	1
11	Pan head screw M6x10	12
12	Packing	1
13	Nut M6	24
14	Washer	32
15	Pan head screw M6x16	24
16	Hex. head bolt M8x20	20
17	Washer	31
18	Nut M8	7
19	Packing	1
20	Allen screw M6x20(LH)	1
21	Power cable	1
22	Bag strap	2
23	Filter bag	1
24	Dust bag	1
28	Engine	1
29	Washer	4
30	Screw M10x16	4
31	Washer	4
32	Screw M8x30	4
36	Control box complete	1
37	Screw M6x16	4
38	Screw M6x10	4
39	Washer	8
40	Nut M4	4
41	Mounting plate	2

13 Electrical schematic

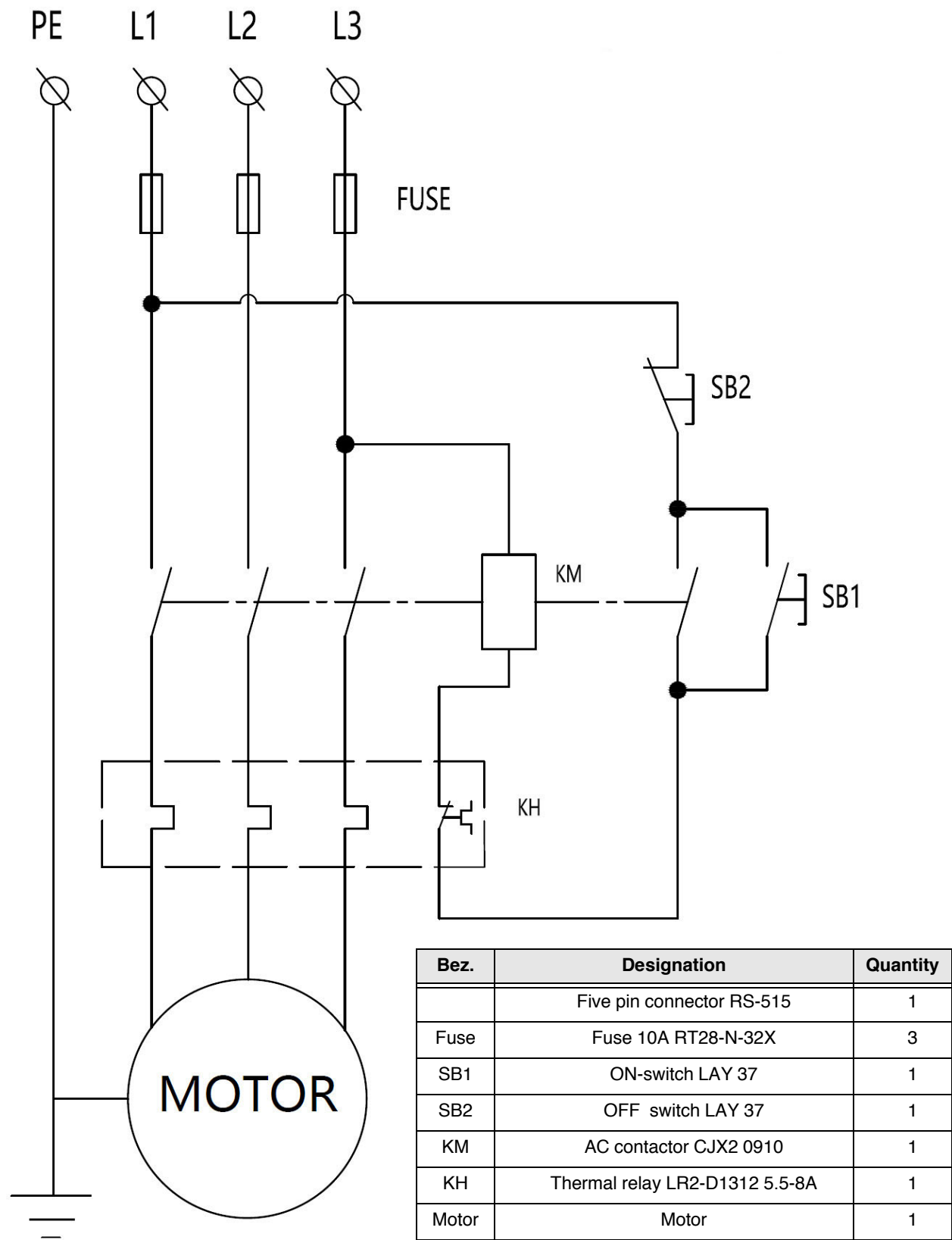

Fig. 11: Electrical schematic

14 EC-Declaration of Conformity

According to Machinery Directive 2006/42/EC Annex II 1.A

Manufacturer/carrier: Stürmer Maschinen GmbH
Dr.-Robert-Pfleger-Str. 26
D-96103 Hallstadt

hereby declares that the following product

Product group: Holzstar® Woodworking machines

Machine type: Dust collector

Designation of the machine: SAA 2203 UT

Item number: 5922123

Serial number*: _____

Year of manufacture*: 20____

*fill in these fields according to the information on the type plate

complies with all relevant provisions of the above-mentioned directive and the other directives applied (hereinafter) - including their amendments in force at the time of the declaration.

Applicable EU directives:	2014/30/EU	EMC-Directive
	2011/65/EU	RoHS-Directive
	2012/19/EU	WEEE-Directive

Applicable EU regulations: 1907/2006/EU REACH-Regulation

The following harmonized standards have been applied:

DIN EN 60335-1:2020-08	Household and similar electrical appliances - Safety - Part 1: General requirements
DIN EN 60335-2-69:2015-07	Household and similar electrical appliances - Safety - Part 2-69: Particular requirements for wet and dry vacuum cleaners, including power brush for commercial use
DIN EN 62233:2008-11	Measurement methods for electromagnetic fields of household appliances and similar apparatus with regard to human exposure
DIN EN 55014-1:2018-08	Electromagnetic compatibility - Requirements for household appliances, electric tools and similar apparatus - Part 1: Emission
DIN EN 55014-2:2016-01	Electromagnetic compatibility - Requirements for household appliances, electric tools and similar apparatus - Part 2: Immunity - Product family standard
DIN EN 61000-3-2:2019-12	Electromagnetic compatibility (EMC) - Part 3-2: Limits - Limits for harmonic current emissions (equipment input current ≤ 16 A per phase)
DIN EN 61000-3-3:2020-07	Electromagnetic compatibility (EMC) - Part 3-3: Limits - Limitation of voltage changes, voltage fluctuations and flicker in public low-voltage supply systems, for equipment with rated current ≤ 16 A per phase and not subject to conditional connection

Responsible for documentation: Kilian Stürmer, Stürmer Maschinen GmbH,
Hallstadt, 26.05.2021 Dr.-Robert-Pfleger-Str. 26, D-96103 Hallstadt



Kilian Stürmer
Manager



