

# Operating instructions

—— Wet/dry grinder

—— NTS 201

—— NTS 256



NTS 201



NTS 256

NTS-SERIE

# imprint

## Product identification

Wet/dry grinder

NTS 201	5750201
NTS 256	5750256

## Manufacturer

Stürmer Maschinen GmbH  
Dr.-Robert-Pfleger-Str. 26  
D-96103 Hallstadt

Fax: 0049 (0) 951 - 96555-55

E-mail: info@holzkraft.de  
Internet: www.holzkraft.de

## Information on the operating instructions

Original operating instructions  
according to DIN EN ISO 20607:2019

Output: March 12, 2024  
Version: 1.01  
Language: German

author RL

## Copyright information

Copyright © 2024 Stürmer Maschinen GmbH, Hallstadt, Germany.

Technical changes and errors excepted.

## Contents

<b>1 Introduction .....</b>	<b>3</b>
1.1 Copyright.....	3
1.2 Customer Service.....	3
1.3 Limitation of Liability.....	3
<b>2 Security .....</b>	<b>3</b>
2.1 Explanation of symbols.....	3
2.2 Operator's Responsibility .....	4
2.3 Safety data sheets.....	4
2.4 Qualifications of personnel .....	5
2.5 Personal protective equipment .....	5
2.6 General safety instructions .....	6
<b>3 Intended use.....</b>	<b>6</b>
3.1 Reasonably foreseeable misuse ....	6
3.2 Residual risks.....	7
<b>4 Technical data.....</b>	<b>7</b>
4.1 Environmental conditions .....	8
4.2 Type plate .....	8
<b>5 Transport, packaging, storage.....</b>	<b>8</b>
5.1 Delivery and transport .....	8
5.2 Packaging .....	8
5.3 Storage .....	8
<b>6 Machine description .....</b>	<b>9</b>
6.1 Representation .....	9
6.2 Scope of delivery.....	9
<b>7 Operation .....</b>	<b>9</b>
7.1 Structure and Functionality .....	9
7.2 Installation location.....	13
7.3 Electrical connection .....	13
7.4 Working with the machine.....	13
<b>8 Care, maintenance and repair/Repair.....</b>	<b>14</b>
8.1 Care through cleaning .....	14
8.2 Maintenance and repair.....	14
<b>9 Troubleshooting .....</b>	<b>15</b>
<b>10 Disposal, recycling of old devices.....</b>	<b>16</b>
10.1 Decommissioning .....	16
10.2 Disposal of electrical devices.....	16
10.3 Disposal of lubricants .....	16
10.4 Disposal via municipal collection points.....	16
<b>11 Spare parts .....</b>	<b>16</b>
11.1 Spare parts drawings .....	17
<b>12 Electrical circuit diagrams.....</b>	<b>21</b>
<b>13 EU Declaration of Conformity.....</b>	<b>23</b>

## 1 introduction

By purchasing the HOLZKRAFT wet/dry sander you have made a good choice.

**Please read the operating instructions carefully before commissioning.**

This is an important component and must be kept near the machine and accessible to every user.

The operating instructions inform you about the proper commissioning, the intended use as well as the safe and efficient operation and maintenance of the wet/dry grinder.

In addition, observe the local accident prevention regulations and general safety regulations for the area of application of the wet/dry grinder.

### 1.1 Copyright

The contents of this manual are protected by copyright and the sole property of Stürmer Maschinen GmbH. Their use is permitted within the scope of the device's intended use. Any other use is prohibited without the written permission of the manufacturer.

The distribution and reproduction of this document, as well as the use and communication of its contents, are prohibited unless expressly permitted. Violations will result in damages. To protect our products, we register trademark, patent, and design rights wherever possible. We vigorously oppose any infringement of our intellectual property rights.

### 1.2 Customer service

If you have any questions about your wet/dry grinder or for technical information, please contact your authorized dealer. They will be happy to provide you with expert advice and information.

#### **Germany:**

Stürmer Maschinen GmbH  
Dr.-Robert-Pfleger-Str. 26  
D-96103 Hallstadt

#### **Repair service:**

Fax: 0951 96555-111  
E-mail: [service@stuermer-maschinen.de](mailto:service@stuermer-maschinen.de)

#### **Ordering spare parts:**

Fax: 0951 96555-119  
E-mail: [ersatzteile@stuermer-maschinen.de](mailto:ersatzteile@stuermer-maschinen.de)

We are always interested in information and experiences that arise from use and can be valuable for improving our products.

### 1.3 Limitation of liability

All information and instructions in this manual have been compiled taking into account the applicable standards and regulations, the state of the art and our many years of knowledge and experience.

The manufacturer assumes no liability for damages in the following cases:

- Failure to follow these instructions
- Improper use
- Use of non-qualified and unprofessional personnel
- Unauthorized modifications
- Technical changes
- Use of unauthorized spare parts

The actual scope of delivery may differ from the explanations and illustrations described here in the case of special designs, the use of additional ordering options or due to the latest technical changes.

The obligations agreed in the supply contract, the general terms and conditions as well as the delivery conditions of the manufacturer and the legal regulations valid at the time the contract is concluded apply.

## 2 Security

This section provides an overview of all important safety packages for the protection of personnel and for safe, trouble-free operation. Further task-specific safety instructions are included in the sections on the individual life cycle phases.

### 2.1 Explanation of symbols

#### **Safety instructions**

Safety instructions in this manual are marked with symbols. The safety instructions are introduced by signal words that express the extent of the hazard.



### **DANGER!**

This combination of symbol and signal word indicates an immediately dangerous situation which, if not avoided, will result in death or serious injury.

### **WARNING!**

This combination of symbol and signal word indicates a potentially dangerous situation which, if not avoided, will result in death or serious injury.

### **CAUTION!**

This combination of symbol and signal word indicates a potentially dangerous situation which, if not avoided, may result in minor or light injuries.

### **DANGER!**

This combination of symbol and signal word indicates a potentially dangerous situation which, if not avoided, could result in property damage and environmental damage.



### **A NOTICE!**

This combination of symbol and signal word indicates a potentially dangerous situation which, if not avoided, could result in property damage and environmental damage.

### **Tips and recommendations**



### **Tips and recommendations**

This symbol highlights useful tips and recommendations as well as information for efficient and trouble-free operation.

To reduce the risk of personal injury and property damage and to avoid dangerous situations, you must observe the safety instructions listed in this operating manual.

## **2.2 Operator's responsibility**

The operator is the person who operates the machine himself for commercial purposes or who makes it available to a third party for use or application and who bears legal product responsibility for the protection of the user, personnel or third parties during operation.

### **Operator's obligations:**

If the machine is used in a commercial setting, the operator is subject to legal obligations regarding occupational safety. Therefore, the safety instructions in this manual, as well as the safety, accident prevention, and environmental protection regulations applicable to the machine's area of use, must be observed. The following applies in particular:

- The operator must familiarize himself with the applicable occupational health and safety regulations and, in a risk assessment, identify additional hazards arising from the specific working conditions at the machine's location. These must be implemented in the form of operating instructions for the machine.
- The operator must check throughout the entire service life of the machine whether the operating instructions he has drawn up comply with the current regulations and adapt them if necessary.
- The operator must clearly regulate and define the responsibilities for installation, operation, troubleshooting, maintenance and cleaning.
- The operator must ensure that all persons handling the machine have read and understood these instructions. Furthermore, the operator must train personnel at regular intervals and inform them of the hazards involved.
- The operator must provide the necessary protective equipment to the personnel and instruct them to wear the necessary protective equipment.

Furthermore, the operator is responsible for ensuring that the machine is always in perfect technical condition. Therefore, the following applies:

- The operator must ensure that the maintenance intervals described in this manual are observed.
- The operator must have all safety devices checked regularly for functionality and completeness.

## **2.3 Safety data sheets**

Safety data sheets for hazardous goods are available from your specialist dealer or by calling +49 (0)951/96555-0. Specialist dealers can find safety data sheets in the download area of the partner portal.

## 2.4 Qualifications of staff

The various tasks described in this manual place different demands on the qualifications of the persons entrusted with these tasks.



### WARNING!

#### **Danger if people are not sufficiently qualified!**

Insufficiently qualified persons cannot assess the risks involved in operating the machine and expose themselves and others to the risk of serious or fatal injuries.

- Have all work carried out only by qualified persons.
- Keep insufficiently qualified persons away from the work area.

Only persons who can be expected to perform the work reliably are permitted to perform any work. Persons whose reaction time is impaired, for example, by drugs, alcohol, or medication are not permitted.

In this operating manual, the qualifications of the persons for the various tasks are listed below:

#### **Operator:**

The operator has been instructed by the owner about the tasks assigned to him and the potential dangers associated with improper use. The operator may only perform tasks that go beyond normal operation if specified in these operating instructions and if the owner has expressly authorized him to do so.

#### **Qualified electrician:**

Due to their professional training, knowledge and experience as well as knowledge of the relevant standards and regulations, the qualified electrician is able to carry out work on electrical systems and to independently identify and avoid potential hazards.

#### **Specialist staff:**

Due to their professional training, knowledge and experience as well as knowledge of the relevant standards and regulations, the specialist personnel are able to carry out the work assigned to them and to independently identify possible dangers and avoid hazards.

#### **Manufacturer:**

Certain work may only be performed by the manufacturer's qualified personnel. Other personnel are not authorized to perform this work. Please contact our customer service department to have the required work performed.

## 2.5 Personal protective equipment

Personal protective equipment is designed to protect people from risks to their safety and health at work. Personnel must wear personal protective equipment while performing various tasks on and with the machine, as specifically indicated in the individual sections of this manual.

The following section explains personal protective equipment:

Version 1.01 Version 1.01 Version 1.01 Version 1.01



#### **Hearing protection**

Hearing protection protects against hearing damage caused by noise.



#### **Safety glasses**

The safety goggles are used to protect the eyes from flying debris.



#### **dust mask**

The dust mask protects the respiratory tract from dust.



#### **Suitable protective gloves**

The protective gloves are designed to protect your hands from sharp-edged components, as well as from friction, abrasions or deeper injuries.



#### **Safety shoes**

The safety shoes protect the feet from crushing, falling objects and slipping on slippery surfaces.



#### **protective work clothing**

Protective work clothing is tight-fitting work clothing, without protruding parts, with low tear resistance.

## 2.6 General safety instructions

- The grinder may only be operated and maintained by persons who have read and understood these operating instructions. The operator must be adequately trained in its use, adjustment, and operation.
- Only switch on the machine immediately before starting work. Do not leave the machine unattended while it is running.
- Never open the protective covers while the wet/dry grinder is in operation.
- Keep the work area and the floor around the wet/dry grinder clear of any objects that could compromise your stability or pose a tripping hazard. Keep your work area tidy. Clutter can lead to accidents.
- Before and during work, check the danger area to ensure that no unauthorized persons are present there.
- When laying the power cable, make sure that it is not crushed or wet.
- If the power cable is damaged, stop using the machine immediately and have it replaced by a qualified electrician.
- Protect the machine from moisture and humidity to avoid the risk of short circuits or electric shock.
- Do not use the machine near flammable gases, liquids, or solids. Flying sparks may cause explosions or fires.
- Only use the machine in dry rooms or in dry environments and ensure that the work area is sufficiently lit.
- Only operate the machine with all safety devices fully and correctly installed and do not modify the machine in any way.
- Hearing protection must always be worn when working with the device. Loose clothing (ties, scarves, open jackets, and loose-fitting garments) is prohibited. If you have long hair, a hairnet must be worn.
- Use only original spare parts.
- Before operation, check all workpieces for foreign objects such as nails and screws.
- Do not use abrasives that have cracks or are deformed.
- Wear suitable gloves when changing abrasives.
- Before switching on, check that all repair and adjustment tools have been removed.
- Before any maintenance or repair, the wet/dry grinder must be secured against operation.
- Do not use compressed air to clean the machine or remove chips.
- All protective and safety devices must be reinstalled immediately after repair or maintenance has been completed.

## 3 Intended use

The wet/dry sander is designed exclusively for sanding wood or wood-like materials and is universally applicable for schools, craft businesses, workshops and for do-it-yourselfers.

Proper use also includes compliance with all information in this manual.

### 3.1 Reasonably foreseeable misuse

Any use beyond the intended use or any use other than that intended is considered misuse.

Possible misuses may include:

- Use of the wet/dry sander on materials other than wood (e.g. processing metal).
- Use of the wet/dry sander with parameters that are not permitted for processing wood.
- Operating the wet/dry grinder without the provided safety devices functioning.
- Bridging or modifying the protective devices.
- Failure to comply with maintenance instructions.
- Failure to observe signs of wear and damage.
- Service work by untrained or unauthorized personnel.
- Maintenance work on an unsecured machine.
- Careless handling of the machine during operation.
- Installation of spare parts and use of accessories and operating materials not approved by the manufacturer.
- Processing several workpieces simultaneously in one work step.
- Machining of oversized workpieces.
- Modifications to the machine or the use of modified tool systems.

Misuse of the wet/dry grinder can lead to dangerous situations. Stürmer Maschinen GmbH assumes no liability for design or technical modifications to the machine. Claims of any kind for damages resulting from improper use are excluded.

### 3.2 Residual risks

Even if all safety regulations are observed and the machine is used correctly, there are still residual risks, which are listed below.

- Hearing impairments when working for long periods without hearing protection or if the protection is inadequate.
- Electrical hazards due to contact with parts and high voltage (direct contact) or with parts that are under high voltage due to a defect in the device (indirect contact).
- Heat development on components can lead to burns and other injuries.
- Risk of injury to fingers and hands from the tool or workpiece, e.g. when changing tools.
- Danger of inhaling wood dust (if necessary, an extraction system must be used in accordance with legal regulations).
- Risk of eye injury from flying debris, even when wearing protective goggles.

## 4 Technical data

Model	NTS 201	NTS 256
Dimensions	480 x 340 x 375 mm	460 x 340 x 410 mm
Dimensions (Packaging)	440 x 390 x 365 mm	450 x 420 x 390 mm
Weight	9.2 kg	14.2 kg
Connection voltage	230 V	230 V
Phase(s)	1	1
Type of current	AC	AC
Mains frequency	50 Hz	50 Hz
Grindstone diameter knife	200 mm	250 mm
Grindstone width	40 mm	50 mm
Honing discs diameter	200 mm	200 mm
Grit grinding disc	K 220	K 220
Honing discs width	30 mm	30 mm
speed	115 rpm	90-160 rpm
Sound pressure level	77 dB(A)	77 dB(A)
Output power (kW)	S1: 0.12 0.57 A	S1: 0.09 1 A
Recording power (kW)	S2: 0.15 0.69 A	S6: 40%: 0.15 1.38A
Protection class drive motor	IP44	IP44
Nominal operating mode drive motor	S1, S2	S1, S6
Engine speed	1490 rpm	1790 rpm
Total power consumption taking	0.57A / 0.69A	1.00 A / 1.38 A

\* The sound pressure level of this machine can exceed 82 dB(A) at the workplace. Hearing protection is recommended.



#### 4.1 Environmental conditions

Working temperature	1 °C to 40 °C
humidity	max. 90%
Operating height	max. 1000 m
Working environment	dry, non-flammable
Work light	> 500 LUX

#### 4.2 Nameplate

<b>Nass-Schleifsystem</b> Wet-grinding system			
Typ Type	NTS 201	Serien-Nr. Serial no.	
Artikel-Nr. Item no.	5750201	Baujahr Year of manufacture	
Motorleistung Motor power	150 W	Netzanschluss Power connection	230 V/1~/50 Hz
Gewicht Weight	9,2 kg	Drehzahl Schleifstein Grinding speed	115 min <sup>-1</sup>
 Stürmer Maschinen GmbH Dr.-Robert-Pfleger-Str. 26, 96103 Hallstadt Deutschland / Germany			

Fig. 1: Type plate

## 5 Transport, packaging, storage

### 5.1 Delivery and transport

#### delivery

Upon delivery, inspect the wet/dry grinder for visible transport damage. If any damage is found, report it immediately to the shipping company or dealer.

#### transport

Improper transport is prone to accidents and can cause damage or malfunctions to the machine, for which we assume no liability or guarantee.

Transport the delivery contents to the installation site using a sufficiently dimensioned industrial truck or a crane, ensuring they cannot be moved or tipped over.



#### WARNING!

Severe injuries can occur if machine parts tip over or fall from a forklift, pallet truck, or transport vehicle. Observe the instructions and information on the transport crate.

Please note the total weight of the machine. The weight of the machine is specified in the "Technical Data" of the machine. When the machine is unpacked, the weight can also be read on the rating plate.

Only use transport equipment and load lifting devices that can support the total weight of the machine.

### 5.2 Packaging

All packaging materials and packaging aids used for the wet/dry grinder are recyclable and must be recycled.

Shred cardboard packaging components and dispose of them in the waste paper collection.

The films are made of polyethylene (PE), and the padding is made of polystyrene (PS). These materials can be disposed of at a recycling center or with your local waste disposal company.

### 5.3 Storage

The wet/dry grinder must be thoroughly cleaned before storage in a dry, clean, and frost-free environment. To prevent rust formation, all unpainted metal surfaces must be treated with a suitable rust protection. Then, cover the machine with a protective tarpaulin.



## 6 Machine description

### 6.1 Representation

Illustrations in this operating manual may differ from the original.

#### NTS 201

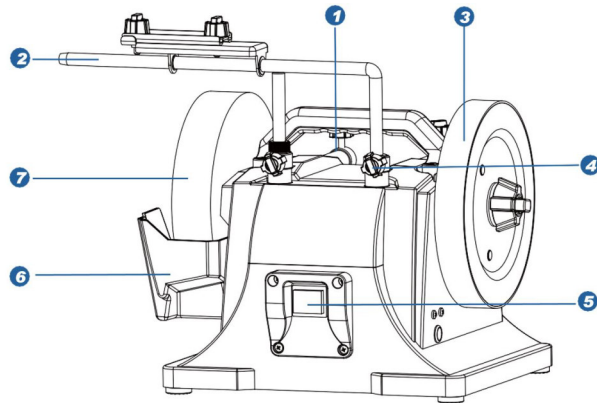

- 1 Horizontal brackets with buttons
- 2 Universal mounting bracket Leather
- 3 wiper disc
- 4 Clamping screws for mounting bracket
- 5 power switch (ON/OFF)
- 6 Water collection container
- 7 whetstone

#### NTS 256

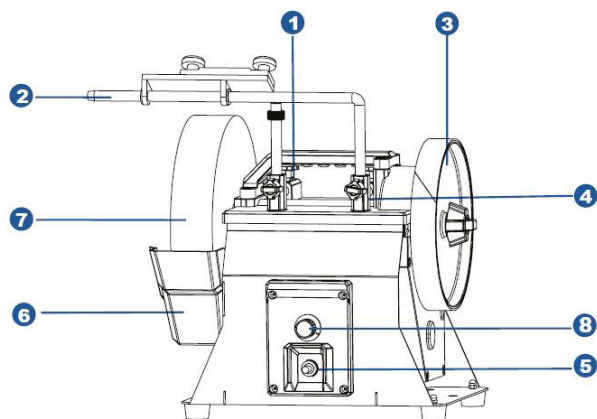

- 1 Horizontal brackets with buttons
- 2 Universal mounting bracket Leather
- 3 wiper disc
- 4 Clamping screws for mounting bracket
- 5 power switch (ON/OFF)
- 6 Water collection container
- 7 whetstone
- 8 Speed control

### 6.2 Scope of delivery

#### NTS 201 and NTS 256

- Water collection container
- Stripping paste
- Angle gauge
- Universal grinding device

#### Optional accessories:

- Sanding belts
- Sanding disc with Velcro pad
- Divider plate

## 7 Operation

### 7.1 Structure and function

#### Install wet grinding stone

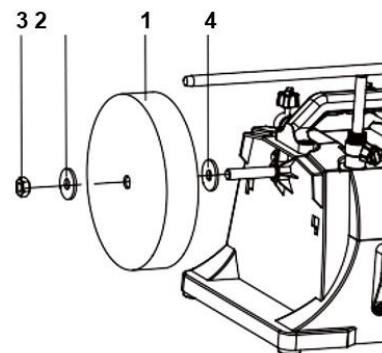

Make sure the device is unplugged before installing the whetstone.

- Remove the nut (3) and the outer flange (2) from the main shaft,
- Slide the wet grinding stone (1) onto the shaft.
- Mount the washer (2) and the hex nut (3) to fix the stone.

#### Install wet grinding stone

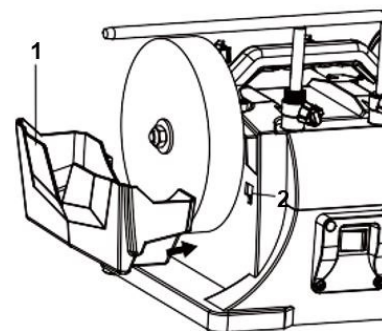

- Slide the recesses of the water tank (1) into the mounting slots (2).

- Model NTS 256:  
With this model, there are two options for positioning the water collection container. For new grinding stones, select the lower mounting position (2).

### Install star grip screw

- Place the hexagon nut (1) in the recess.
- Screw the second hexagon nut (2) onto the thread of the star grip screw (3).
- Now screw the star grip screw (3) hand-tight onto the hexagon nut (1) until a slight resistance is felt
- Now counter both nuts (1 + 2) to fix the screw.

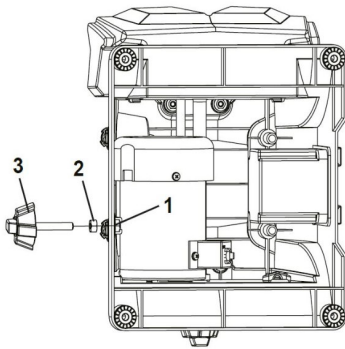

### Install mounting bracket

- The mounting bracket (1) serves both as a work surface and as a mounting arm for various devices. The mounting bracket can be installed in either the vertical (A) or horizontal (B) position.

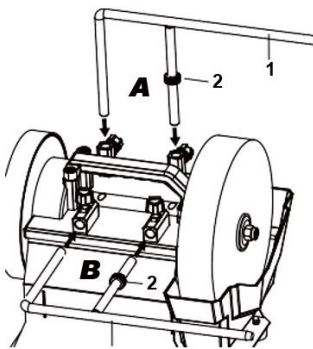

- Position A - Against the wheel rotation:  
Working in the opposite direction of rotation removes larger amounts of material quickly. Use this method to shape blades or sharpen axes. The grinding wheel rotates toward you.
- Position B - In direction of rotation:  
Working in the rotational direction is preferable for more precise work that requires less material removal. For fine grinding of tools such as knives, scissors, or other cutting tools, grind

In the direction of rotation. Use the bidirectional switch to change the direction of rotation of the grinding wheels. Remove the workpiece from the machine before changing the direction of rotation.

### Mount the mounting bracket

- Select the desired position for mounting the mounting bracket. Position the support so that the support arm extends beyond the wheel you want to work with.
- Loosen the clamping screws of the bracket and slide the universal support into the designated mounting sockets.
- Adjust the height of the universal support to suit your workpiece and application.
- Use the fine adjustment nut (2) on the threaded rod to fine-tune the support. Ensure that the support arm is completely parallel and level with the wheel surface, whether vertical or horizontal.
- Secure the support by tightening the two clamping screws.

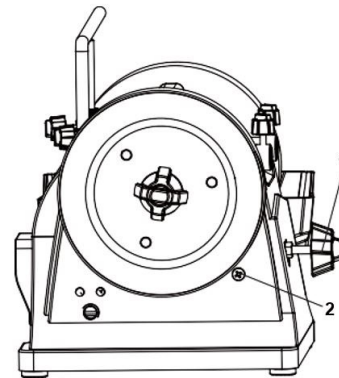

### DANGER!

Before commissioning, be sure to remove the transport locking screw (2)

The brush wheel can be adjusted using the star grip screw on the back of the grinder.

Using the star grip screw (1) on the back of the grinder, you can adjust the contact pressure on the stop. This may be necessary if the leather honing wheel or whetstone stops moving during sharpening or honing. Turn the star grip clockwise to increase the tension. Tighten the star grip only until you feel slight resistance. Do not overtighten.



### A NOTICE!

- Before reversing, the star grip screw (1) must be readjusted.
- After working with the machine, the back of the star grip screw (1) must always be loosened counterclockwise so that the motor shaft no longer presses against the wheel.

### Grinding against the direction of rotation

The device is equipped with an electric toggle switch. Depending on the switch's position, the grinding wheel can rotate forward or backward. (Definition: Forward = clockwise, Reverse = counterclockwise)

Model NTS 201:

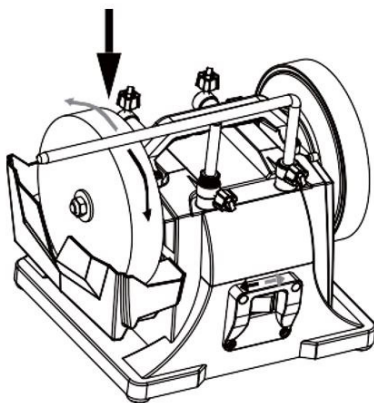

- Tilt position left: grinding wheel rotates forward.
- Tilt position right: grinding wheel rotates backwards.

Model NTS 256:

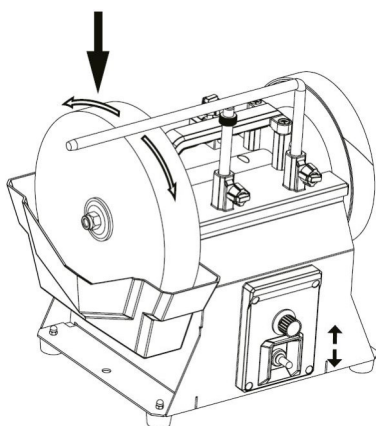

- Tilt position up: grinding wheel rotates forward.
- Tilt position down: grinding wheel rotates backwards.

### Rotation speed (only for model NTS 256)

Depending on the device model, the rotation speed of the grinding wheel can be continuously adjusted:

- To increase the speed, turn the knob (1) clockwise.
- To decrease the speed, turn the knob (1) counterclockwise.

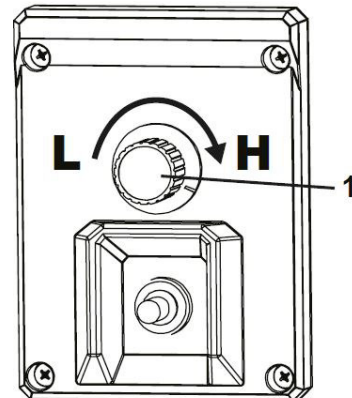

### Grinding JIP

The fixture supplied with the grinder can be used as a universal attachment for a variety of tools and can be positioned to grind with and against the rotation of the grinding wheel.

- Remove the power plug from the socket to disconnect the device from the power supply.
- Insert the tool into the fixture and adjust the grinding angle using the guide.
- Once you have set the desired angle, fix the two locking knobs to

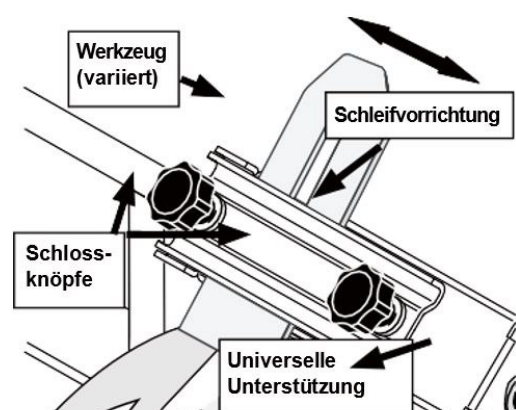

### Water collection container

The wet grinding stone is designed for wet grinding only and should never be used for dry grinding without water.

- The container's fastening tabs serve as hooks for hanging into the container's fastening slots.
- To fill and position the container, remove the container and fill it with water up to just below the V-shaped recess.
- Hang the container in the designated place on the device.

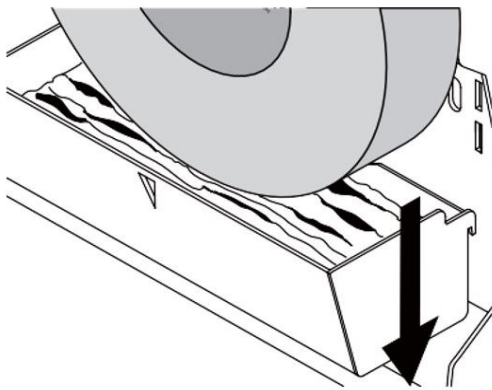

#### A NOTICE!

- Always switch the grinder to "OFF" when not in use.
- Remove the water collection container and empty the container when the grinder is not in use.



#### A NOTICE!

- Check the water level in the container before each use and ensure that the grinding stone is sufficiently wetted with water when wet grinding.
- Rinse and refill the container regularly to prevent metal and stones from accumulating in the container.
- To avoid damage/accumulation of dirt etc., never leave the whetstone in water for long periods of time.

### Angle guide

The sharpener comes with an angle guide to help determine and maintain the cutting angle for a variety of tools.

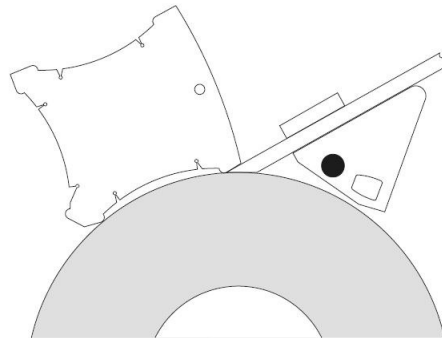

Measure the angle of the workpiece by comparing the cutting edge with the notches. Then adjust the measured angle on the tool by adjusting the height of the workpiece support. To do so, follow these steps:

- First clamp the tool into the fixture and place the fixture on the workpiece support
- Then hold the protractor to the tool tip at the desired angle.
- Now adjust the height of the workpiece support so that the front end of the protractor rests directly against the grinding stone. Make sure the protractor is always aligned with the tool tip.



#### A NOTICE!

The values indicated on the protractor are guidelines only. You can, of course, adjust these values to suit your needs.

### Dressing the grinding wheel

Depending on the type of grinding operation, the grinding wheel must be dressed regularly. A variety of dressing tools (not included) are available to restore the abrasion resistance of the wheel surface and return the grinding wheel to its proper shape. Detailed information on properly dressing a grinding wheel can be found in the instructions included with your dressing accessories.

Metal objects heat up quickly during grinding. It's important to repeatedly move the material being ground back and forth across the surface of the grinding wheel and to cool it regularly with coolant.

## Sharpen

Many tools can be sharpened with the leather honing wheel and the included honing paste.



### A NOTICE!

A slight flutter during rotation is normal and does not affect performance.

## Prepare the leather scraper disc

- Apply a light machine oil evenly to the leather wheel. Use oil sparingly to create a thorough coating, but not so much that the leather becomes saturated and drips.
- Apply a thin layer of polishing paste to the leather disc using a wooden spatula or similar tool. Spread the paste evenly by rotating the disc by hand while applying.
- Connect the device to the power supply, turn it on, and continue spreading the paste, still using a wooden spatula. Move the spatula lightly in circular motions over the wheel.
- Once the paste is evenly distributed, start sharpening.

These preparations are sufficient for sharpening five to ten tools. If you notice a decline in sharpening performance or have completed more than ten sharpenings, repeat the above steps.

## 7.2 Installation location

The wet/dry grinder must be placed on a level and stable surface. This prevents the machine from falling and causing injury.



### A NOTICE!

After installation, remove any grease that has been applied to protect the bare metal parts.

- Use common solvents for this purpose.
- Do not use water, nitro solvents or similar!

Ensure sufficient freedom of movement for work, adjustment, and maintenance. There must be at least 1 m of clearance on each side from the wall to the grinder.

## 7.3 Electrical connection

Check the electrical connection, cables and contacts before commissioning.



### DANGER!

#### Danger of death from electric shock!

Contact with live components is life-threatening. Live electrical components can move uncontrollably and cause serious injuries. All work on electrical installations may only be performed by a qualified electrician.

It is important to ensure that

- the power connection has the same characteristics (voltage, mains frequency, phase position) as the motor and is connected to a protective contact socket with a properly installed and functional protective contact,
- the mains voltage of 230 V (15A fuse) is used,
- a cable cross-section of at least 1.5 mm<sup>2</sup> is used for the supply line.

## 7.4 Working with the machine



### Wear hearing protection!



### Wear protective goggles!

Do not press the material to be ground too hard against the grinding wheel when grinding. Especially with small workpieces, there is a risk that the workpiece cannot be gripped properly and will fly off! Ensure the grinding wheel is in good condition and replace worn grinding wheels promptly. Only with flawless tools can you achieve good grinding quality!

## 8 Care, maintenance and repair



### DANGER!

- Before starting any cleaning or maintenance work, switch off the machine and unplug it.
- Connections and repairs may only be carried out by qualified personnel.



### A NOTICE!

After care, maintenance and repair work, check that all panels and protective devices are properly reattached to the machine and that no tools are left inside or in the working area of the wet/dry grinder.

### 8.1 Care through cleaning



**Wear protective goggles!**



**Wear suitable protective gloves!**



### A NOTICE!

Never use harsh cleaning agents for any cleaning work. This may damage or destroy the device.

The wet/dry grinder must always be kept clean.

The machine should always be cleaned after each use. Remove chips and dust with a hand brush or brush while the machine is turned off. Cleaning with compressed air is prohibited, as the fine chips can easily fly into the eyes and cause injury.

## 8.2 Maintenance and repair

Check the general condition of the device before each use:

- Check switches and safety devices for wear or damage
- Check abrasives for wear or damage
- Check parts for tight fit

If any of the above conditions apply, the device must not be used until parts have been replaced or the device has been properly repaired.

If the wet/dry grinder does not function properly, contact a specialist dealer or our customer service.

All protective and safety devices must be reinstalled immediately after repair and maintenance work has been completed.

### 8.2.1 Functional test

A functional test should be carried out before each use.

Step 1: The grinding wheel must rotate freely and must not do not clamp.

Step 2: Check the connecting cable for damage.

### 8.2.2 Moving parts

All moving parts must be cleaned with a soft brush after 500 hours of operation.

Then apply a thin layer of oil or grease to the moving parts.



## 9 Troubleshooting

Mistake	Possible causes	Elimination
The wet/dry grinder does not start.	The on/off switch is defective.	Have the grinder checked by an electrician and replace any damaged parts.
The wet/dry sander slows down when sanding.	The user presses the workpiece too hard against the grinding surface.	Reduce the contact pressure.
Short service life of the Abrasives	Abrasive (belt or disc) with too fine grain	Use abrasives with coarser grain
Poor sanding pattern	Abrasives with too coarse a grain	Use abrasives with finer grain
Grinding angle does not fit	Set angles on the work table or stop angle do not fit	Check angle and readjust if necessary
Grinding wheel appears to be running unevenly	Grinding wheel applied off-center	Apply grinding disc centrally
The sanding belt runs off the rollers.	The sanding belt path is incorrectly adjusted.	Adjust the sanding belt path correctly.
The wood becomes dark or burns during processing.	1. The sanding belt is worn or clogged with sanding dust. 2. Too much contact pressure is applied with the workpiece on the grinding surface.	1. Change the sanding belt. 2. Reduce the contact pressure.



## 10 Disposal, recycling of old devices

In the interest of the environment, all components of the machine must be disposed of only via the designated and approved methods.

### 10.1 Decommissioning

Obsolete equipment must be professionally taken out of service immediately to prevent future misuse and danger to the environment or people.

Step 1: Remove all environmentally hazardous operating materials from remove from the old device.

Step 2: If necessary, pack the device into manageable and dismantle reusable assemblies and components.

Step 3: The device components and operating materials to the designated disposal routes.

### 10.2 Disposal of electrical equipment

Electrical devices contain a variety of recyclable materials as well as environmentally harmful components. Separate these components and dispose of them properly. If in doubt, contact your local waste disposal service. If necessary, seek the assistance of a specialized waste disposal company for recycling.

### 10.3 Disposal of lubricants

The lubricant manufacturer provides disposal instructions for the lubricants used. If necessary, ask for the product-specific data sheets.

### 10.4 Disposal via municipal collection points

Disposal of used electrical and electronic equipment (Applicable in the countries of the European Union and other European countries with a separate collection system for these devices).



The symbol on the product or its packaging indicates that this product shall not be treated as normal household waste. Instead, it shall be taken to the applicable collection point for the recycling of electrical and electronic equipment. By ensuring this product is disposed of correctly, you will help protect the environment and the health of others. Incorrect disposal of this product endangers both the environment and human health. Recycling of materials helps to reduce the consumption of raw materials. For more information about recycling of this product, please contact your local council, your household waste disposal service, or the shop where you purchased the product.

## 11 Spare parts



### DANGER!

#### Risk of injury due to the use of incorrect spare parts!

The use of incorrect or faulty spare parts may endanger the operator and cause damage and malfunctions.

- Only original spare parts from the manufacturer or spare parts approved by the manufacturer may be used.
- If you have any questions, please always contact the manufacturer.



### Loss of warranty

The use of unauthorized spare parts will void the manufacturer's warranty.

Spare parts can be purchased from your authorized dealer. Please provide the following information when ordering spare parts:

- Device type
- Serial number
- Crowd
- Designation
- desired shipping method (mail, freight, sea, air, express)
- Shipping address

Spare parts orders without the above information cannot be considered. If the shipping method is not specified, shipping will be at the supplier's discretion. Information about the device type, article number, and year of manufacture can be found on the rating plate attached to the device.

### Example

The drive roller for the BTS 200 belt and disc sander must be ordered. The drive roller is numbered 17 in spare parts drawing 1.

When ordering spare parts, send a copy of the spare parts drawing (1) with the component (drive roller) and marked position number (17) to the authorized dealer and provide the following information:

- Device type: **Grinding machine NTS 201**
- Item number: **5750201**
- Drawing number: **1**
- Position number: **17**

## 11.1 Spare parts drawings

The following drawing is intended to help you identify the necessary spare parts in the event of a service call. If necessary, send a copy of the parts drawing with the marked components to your authorized dealer.

### Spare parts drawing NTS 201

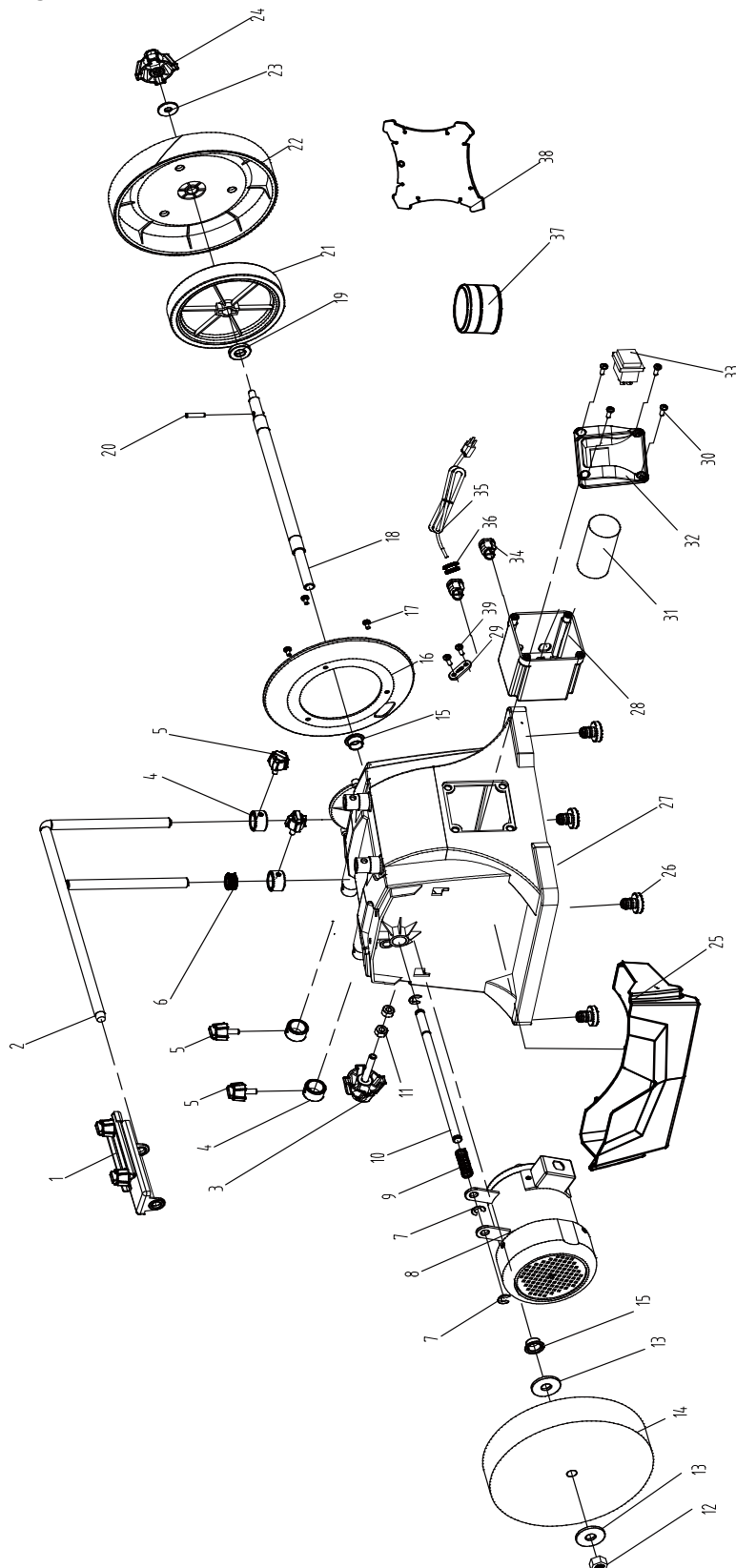

Fig. 2: Spare parts drawing NTS 201

## Spare parts list NTS 201

Pos.	Designation	Crowd
1	Grinding device	1
2	Universal support	1
3	Star grip screw	1
4	sleeve	4
5	Locking button	4
6	adjusting nut	1
7	retaining plate	3
8	Motor	1
9	compression spring	1
10	Motor shaft	1
11	Hexagon nut M8	2
12	Hexagon nut M12	1
13	flange	2
14	wet grinding wheel	1
15	spindle slide	2
16	Wheel protection	1
17	Phillips screw M4x6	3
18	Main shaft	1
19	spacers	1
20	cylindrical pin 5x22	1
21	friction wheel	1
22	Leather honing wheel	1
23	Large washer D8	1
24	Fixing button	1
25	water tank	1
26	rubber foot	4
27	base	1
28	capacitor box	1
29	relief plate	1
30	Phillips screw ST4.2 x16.4	4
31	capacitor	1
32	Protective cover switch	1

Pos.	Designation	Crowd
33	Power switch	1
34	cable clamp	2
35	Power cable	1
36	Cable feedthrough	1
37	Stripping paste	1
38	Angle guide	1
39	Phillips screw M4x12	2

This diagram is an exploded view of a mechanical assembly, likely a portable electronic device or a small machine. The components are numbered 1 through 56. The assembly includes a main housing (1), a base (2), a top cover (3), a side panel (4), a front panel (5), a rear panel (6), a top cover (7), a side panel (8), a front panel (9), a rear panel (10), a top cover (11), a side panel (12), a front panel (13), a rear panel (14), a top cover (15), a side panel (16), a front panel (17), a rear panel (18), a top cover (19), a side panel (20), a front panel (21), a rear panel (22), a top cover (23), a side panel (24), a front panel (25), a rear panel (26), a top cover (27), a side panel (28), a front panel (29), a rear panel (30), a top cover (31), a side panel (32), a front panel (33), a rear panel (34), a top cover (35), a side panel (36), a front panel (37), a rear panel (38), a top cover (39), a side panel (40), a front panel (41), a rear panel (42), a top cover (43), a side panel (44), a front panel (45), a rear panel (46), a top cover (47), a side panel (48), a front panel (49), a rear panel (50), a top cover (51), a side panel (52), a front panel (53), a rear panel (54), a top cover (55), a side panel (56), a front panel (57), a rear panel (58).

NTS Series | Version 1.01

## Spare parts list NTS 256

Pos.	Designation	Crowd
1	Base unit	1
2	bearing housing	1
3	bearing block	2
4	Wave spring washer D35	1
5	Main shaft	1
6	Ball bearing 6003-2RZ	2
7	V-belt pulley	1
8	key 5x5x25	1
9	Phillips screw M5x10	2
10	Motor	1
11	Engine pulley	1
12	Large washer D5	2
13	V-belt	1
14	Phillips screw M6x16	12
15	Phillips screw M4x10	14
16	rubber foot	4
17	Phillips screw M5x20	6
18	Screw M5	4
19	grinding wheel	1
20	Power cable terminal 6P4	3
21	Phillips screw M4x7	2
22	Rubber housing sealing ring	1
23	Protective cover switch	1
24	Power switch	1
25	Rotary knob for speed control	1
26	Screw M4x8	1
27	flange	2
28	grinding wheel	1
29	Hexagon nut M12	1
30	water tank	1
31	bearing plate	1
32	bearing shaft	1

Pos.	Designation	Crowd
33	Washer D10	1
34	Ball bearing 6200-2RS	2
35	Phillips screw M5x35	1
36	Hexagon nut M5	1
37	Hexagon nut M4	1
37	tension spring	1
39	Belt cover plate	1
40	Pin 6x22	1
41	polishing disc	1
42	Large washer A8	1
43	Locking knob M8	1
44	Phillips screw ST4.2x16.4	4
45	handle	1
47	socket	1
48	Phillips screw M3x20	2
49	Locking knob M6x16	4
50	Universal support	1
51	Adjusting nut	1
52	circuit board	1
53	Power cable	1
54	Stripping paste	1
55	sanding template	1
56	Angle guide	1



Electrical diagram NTS 256

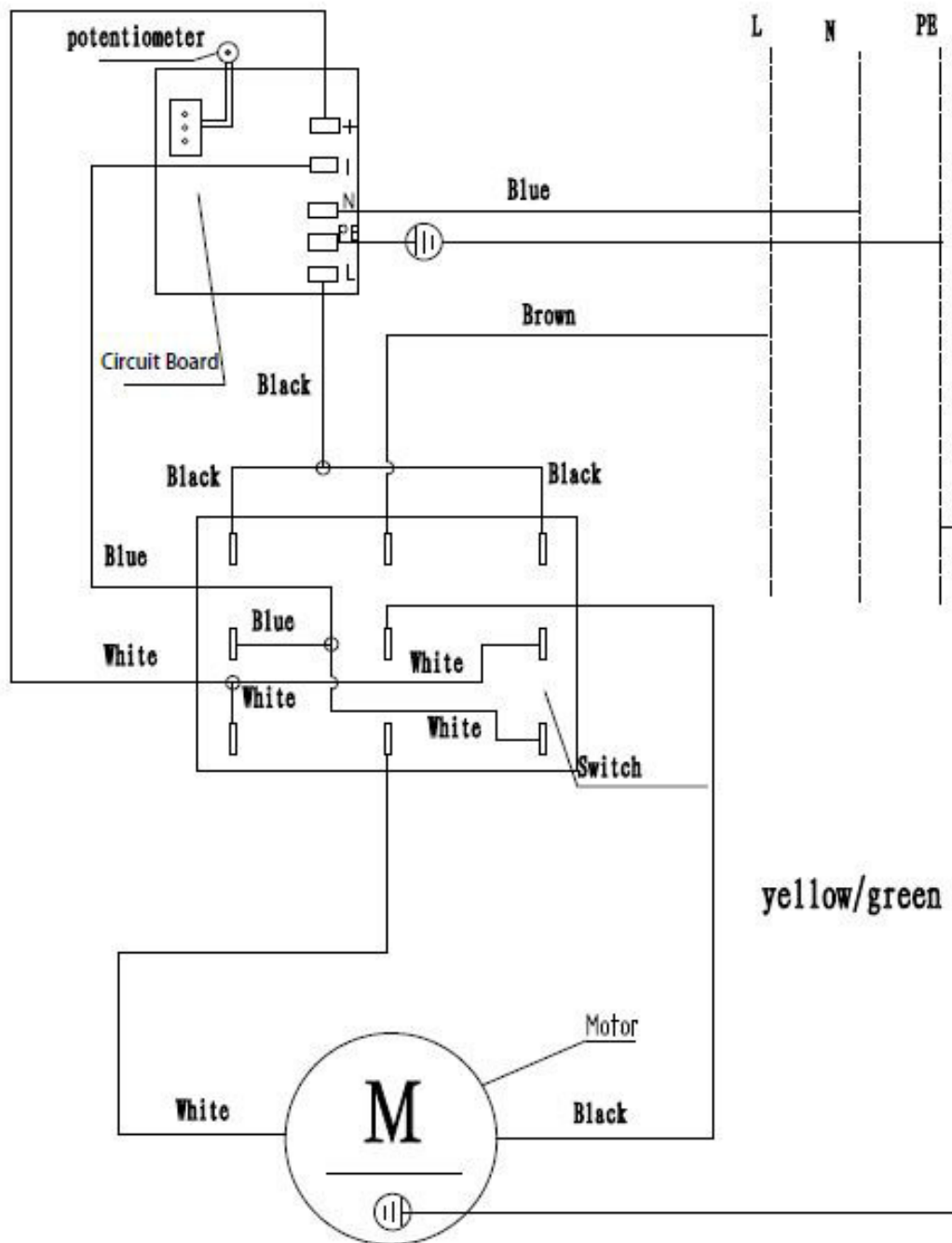

Fig. 5: Circuit diagram NTS 256



## 13 EU Declaration of Conformity

According to Machinery Directive 2006/42/EC Annex II 1.A

**Manufacturer/distributor:** Stürmer Maschinen GmbH  
Dr.-Robert-Pfleger-Str. 26  
D-96103 Hallstadt

hereby declares that the following product

**Product group:** Holzkraft® woodworking machines

**Name of the machine:** ☐ NTS 201 **Item number:** 5750201  
☐ NTS 256 5750256

**Machine type:** Wet/dry grinder

**Serial number\*:** \_\_\_\_\_

Year of manufacture\*:

20\_\_\_\_

\* Fill in these fields according to the information on the type plate

complies with all relevant provisions of the above-mentioned Directive and the other Directives applied (hereinafter) — including any amendments thereto in force at the time of the declaration.

**Other applicable EU directives:** 2014/30/EU EMC Directive  
2012/19/EU WEEE Directive

### The following harmonized standards were applied:

EN ISO 12100:2010	Safety of machinery - General principles for design - Risk assessment and risk reduction (ISO 12100:2010)
EN 62841-1:2015 + AC:2015 + A11:2022	Electric motor-operated hand-held tools, transportable tools and lawn and garden machinery - Safety - Part 1: General requirements
EN IEC 55014-1:2021	Electromagnetic compatibility - Requirements for household appliances, electric tools and similar equipment - Part 1
EN IEC 55014-2:2021	Electromagnetic compatibility - Requirements for household appliances, electric tools and similar equipment - Part 2: Immunity
EN IEC 61000-3-2:2019 + A1:2021	Electromagnetic compatibility (EMC) - Part 3-2: Limits - Limits for harmonic currents (equipment input current ≤ 16 A per phase)
EN 61000-3-3:2013 + A1:2019 + A2:2021 + A2:2021/AC:2022	Electromagnetic compatibility (EMC) - Part 3-3: Limits - Limitation of voltage changes, voltage fluctuations and flicker in public low-voltage supply systems for equipment with a rated current ≤ 16 A per phase and not subject to special connection conditions

**Documentation Responsible:** Kilian Stürmer, Dr.-Robert-Pfleger-Str. 26, D- 96103 Hallstadt

Hallstadt, March 21, 2024



Kilian Stürmer  
Managing Director



