

de	Originalbetriebsanleitung - Absaugmobil	8
en	Original Instructions - Mobile dust extractors	13
fr	Notice d'utilisation d'origine - Aspirateurs mobile	18
es	Manual de instrucciones original - Sistemas móviles de aspiración	23
it	Istruzioni per l'uso originali - Unità mobili d'aspirazione	28
nl	Originele gebruiksaanwijzing - Mobiele afzuigapparaten	33
sv	Originalbruksanvisning - Dammsugare	38
fi	Alkuperäiset käyttöohjeet - Siirrettävät imurit	43
da	Original brugsanvisning - Støvsugere	48
nb	Originalbruksanvisning - Mobil støv-/våtsuger	53
pt	Manual de instruções original - Aspiradores móveis	58
ru	Оригинал Руководства по эксплуатации - Пылеудаляющие аппараты	63
cs	Originál návodu k obsluze - Mobilní vysavače	69
pl	Oryginalna instrukcja eksploatacji - Odkurzacze mobilne	74

CTL SYS

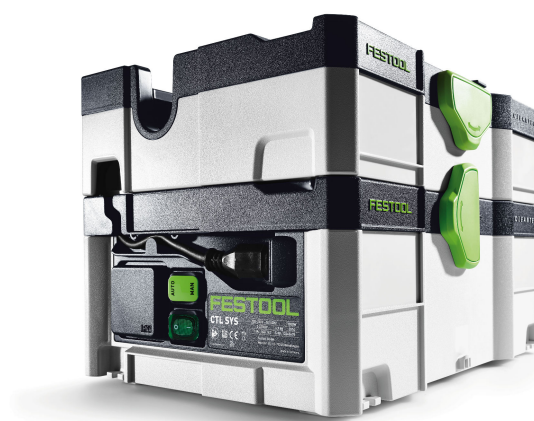

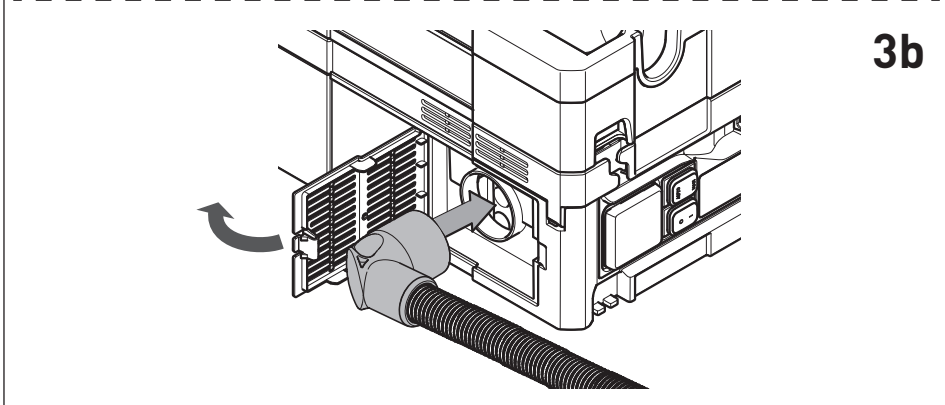
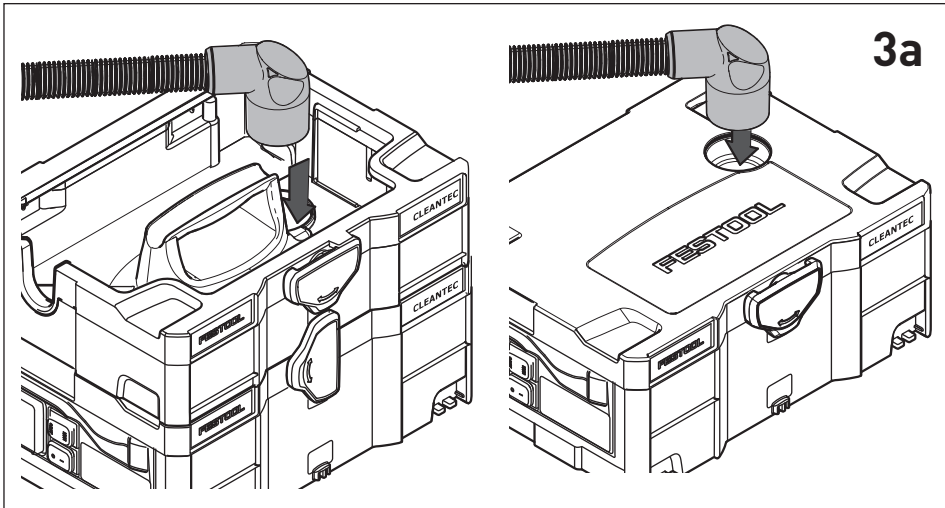
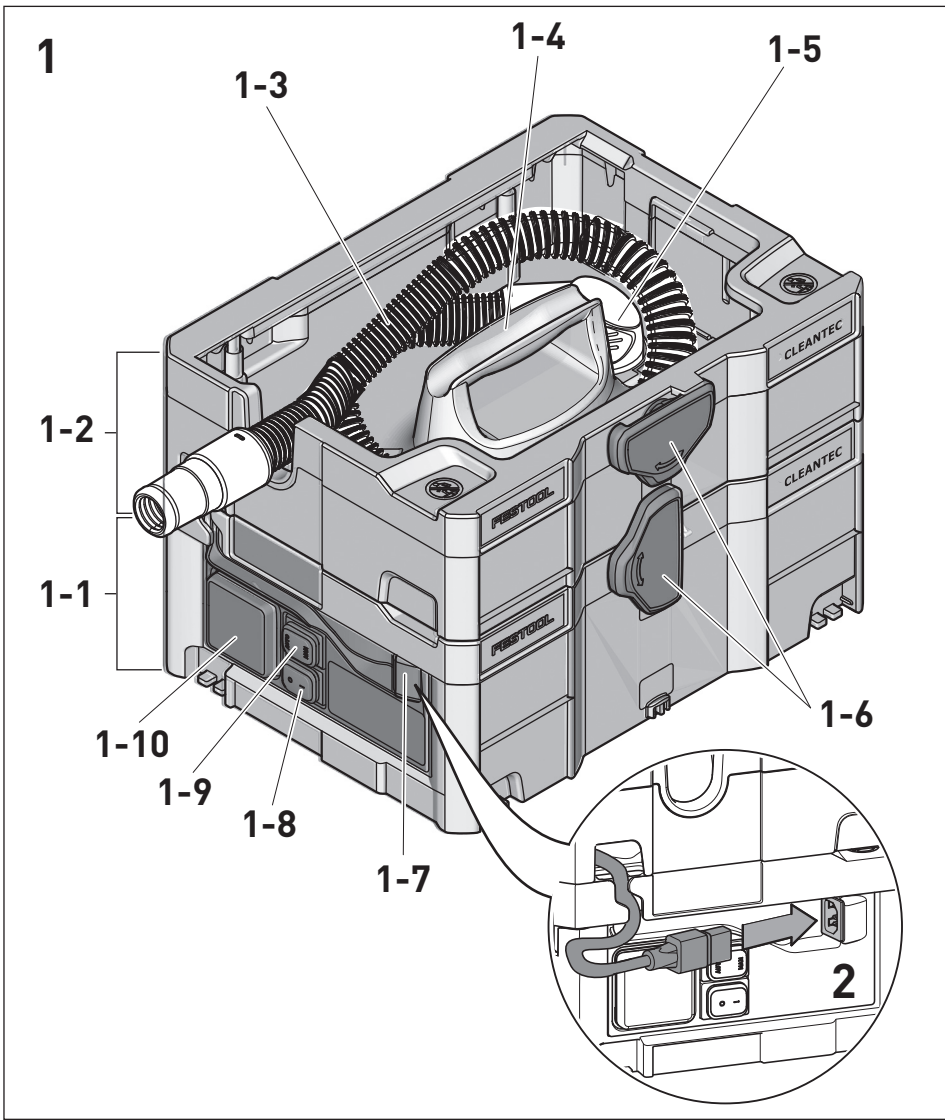

4a

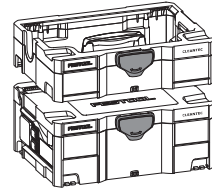
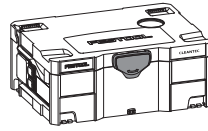
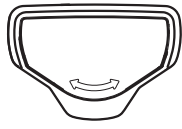

4b

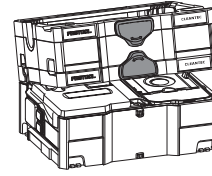
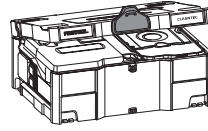
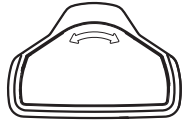

4c

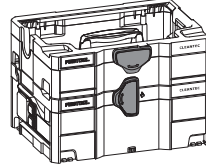
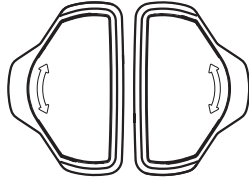

5a

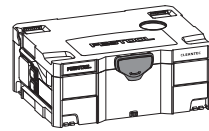
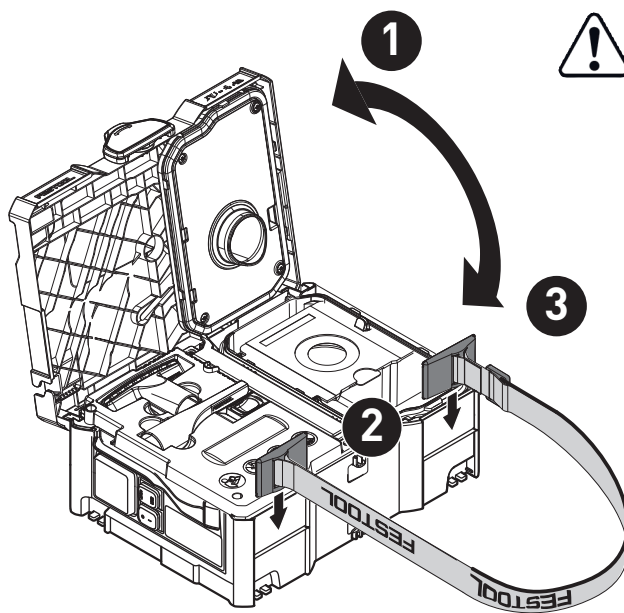

5b

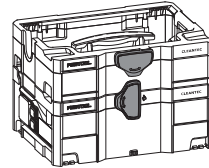
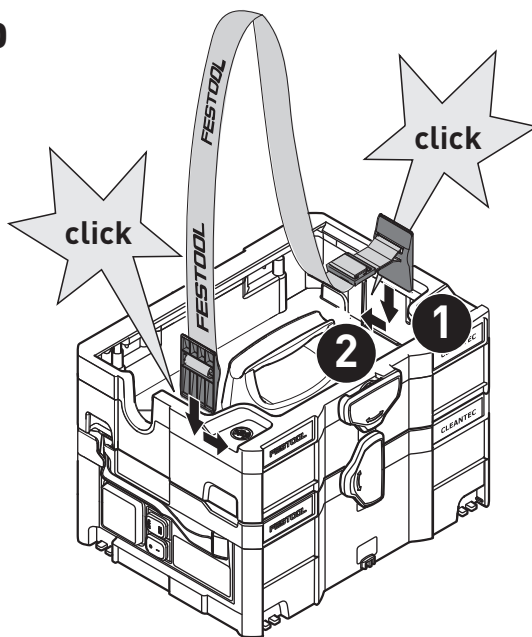

5c

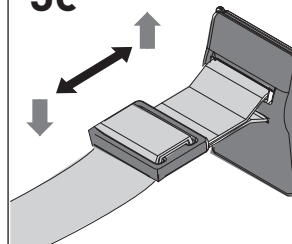

6

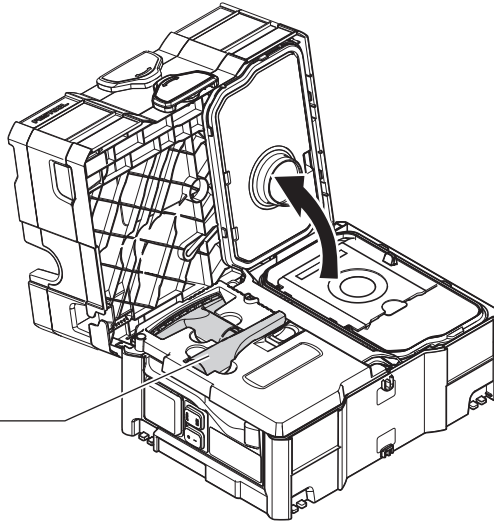

6-1

7

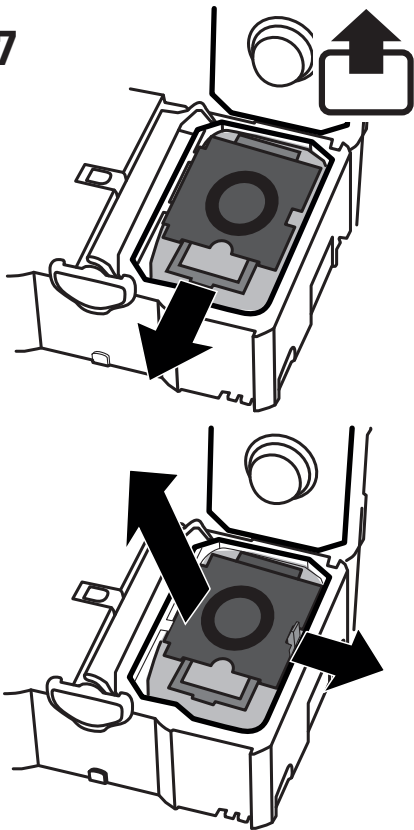

8

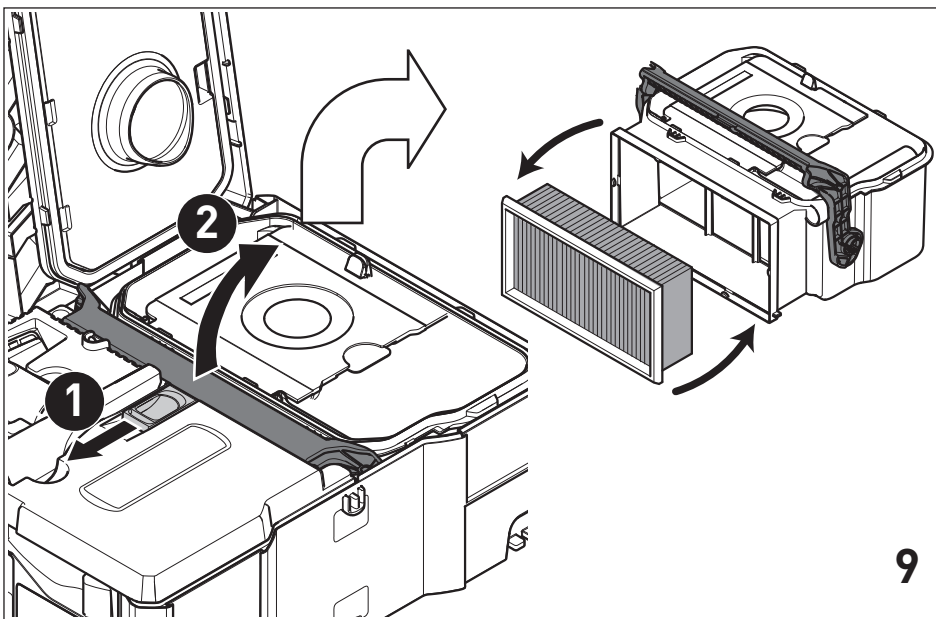
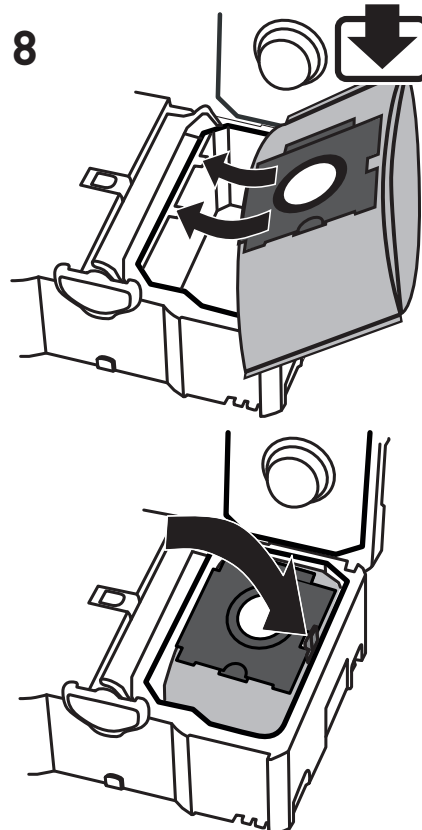

9

Declaration of Conformity

We as the manufacturer Festool GmbH, Wertstraße 20, 73240 Wendlingen, Germany declare under our sole responsibility that the product(s):

Designation: **Mobile dust extractor**
Designation of Type(s): **CTL SYS**
Serial number(s) ¹⁾: **500922**

fulfills all the relevant provisions of the following UK Regulations:

- S.I. 2008/1597 Supply of Machinery (Safety) Regulations 2008
- S.I. 2016/1091 Electromagnetic Compatibility Regulations 2016
- S.I. 2012/3032 Restriction of the Use of Certain Hazardous Substances in Electrical and Electronic Equipment Regulations 2012

and are manufactured in accordance with the following designated standards:

- BS EN 60335-1:2012 + A2:2019
- BS EN 60335-2-69:2012
- BS EN 55014-1:2017
- BS EN 55014-2:2015
- BS EN IEC 61000-3-2:2019
- BS EN 61000-3-3:2013
- BS EN IEC 63000:2018

¹⁾ in the specified serial number range (S-Nr.) from 400000000 – 499999999



Place and date of declaration: Wendlingen, 03.05.2021

Signed on behalf of and in name of Festool GmbH

A handwritten signature in black ink, appearing to read 'ppa. Stark', followed by a long horizontal flourish.

Markus Stark
Head of Productdevelopment

A handwritten signature in blue ink, appearing to read 'i. V. R. Brandt'.

Ralf Brandt
Head of Productconformity

Absaugmobil	Seriennummer *
Mobile dust extractors	Serial number *
Aspirateurs	N° de série *
	(T-Nr.)
CTL SYS	500162, 500164, 500165, 500922

de EU-Konformitätserklärung. Wir erklären in alleiniger Verantwortung, dass dieses Produkt mit allen relevanten Anforderungen folgender EU-Richtlinien übereinstimmt, und folgende Normen oder normative Dokumente zugrunde gelegt wurden:

en EU Declaration of Conformity. We declare under sole responsibility that this product complies with all the relevant requirements in the following EU Directives, and following standards and normative documents were applied:

fr Déclaration de conformité de l'UE. Nous déclarons, sous notre seule responsabilité, que ce produit satisfait à toutes les exigences pertinentes des directives UE suivantes et repose sur les normes ou documents normatifs suivants :

es Declaración UE de conformidad. Declaramos bajo nuestra responsabilidad que este producto cumple todos los requisitos relevantes de las siguientes directivas de la UE y que se han tomado como base las siguientes normas o documentos normativos:

it Dichiarazione di conformità UE. Dichiariamo sotto nostra unica responsabilità che il presente prodotto sia conforme a tutti i requisiti di rilevanza definiti dalle seguenti Direttive UE e che siano stati applicati le seguenti norme o i seguenti documenti normativi:

nl EU-conformiteitsverklaring. Wij verklaren en stellen ons ervoor verantwoordelijk dat dit product volledig voldoet aan alle volgende EU-richtlijnen en volgende normen of normatieve documenten daaraan ten grondslag gelegd werden:

sv EU-försäkran om överensstämmelse. Vi förklarar på eget ansvar att denna produkt uppfyller alla relevanta krav enligt följande EU-direktiv och baseras på följande normer eller normgivande dokument:

fi EU-vaatimustenmukaisuusvakuutus. Vakuutamme yksinomaisella vastuulla, että tämä tuote täyttää seuraavien EU-direktiivien kaikki olennaiset vaatimukset ja se on seuraavien standardien tai standardiasiakirjojen mukainen:

da EU-overensstemmelseserklæring. Vi erklærer med eneansvar, at dette produkt er i overensstemmelse med alle relevante krav i følgende EU-direktiver, og at følgende standarder eller normative dokumenter danner grundlag for det:

nb EU-samsvarserklæring. Vi erklærer under eneansvar at dette produktet oppfyller alle relevante krav i følgende EU-direktiver og at følgende standarder eller normative dokumenter er blitt lagt til grunn:

pt Declaração de conformidade UE. Sob nossa inteira responsabilidade, declaramos que este produto está de acordo com todas as exigências relevantes das seguintes diretivas UE, tendo sido tomadas por base as seguintes normas ou documentos normativos:

ru Декларация о соответствии ЕС. Мы со всей ответственностью заявляем, что данная продукция соответствует всем применимым требованиям следующих Директив ЕС, стандартов и нормативных документов:

cs Prohlášení o shodě EU. Prohlašujeme s veškerou odpovědností, že tento výrobek splňuje všechny příslušné požadavky následujících směrnic EU a že byly použity následující normy nebo normativní dokumenty:

pl Deklaracja zgodności UE. Niniejszym oświadczamy na własną odpowiedzialność, że produkt ten spełnia wszystkie obowiązujące wymagania następujących dyrektyw UE, norm lub dokumentów normatywnych.

2006/42/EG, 2014/30/EU, 2011/65/EU

EN 60335-1:2012, EN 60335-2-69:2012,
EN 55014-1: 2016, EN 55014-2: 2015,
EN 61000-3-2: 2015, EN 61000-3-3: 2014,
EN 50581: 2012

CE Festool GmbH
Wertstr. 20, 73240 Wendlingen, GERMANY
Wendlingen, 2017-08-08

ppa. W. Zondler

Wolfgang Zondler
Head of Research, Development and Technical
Documentation

i.v. R. Brandt

Ralf Brandt
Head of Standardization & Approbation

* im definierten Seriennummer-Bereich (S-Nr.) von 40000000 - 49999999

in the specified serial number range (S-Nr.) from 40000000 - 49999999

dans la plage de numéro de série (S-Nr.) de 40000000 - 49999999

Contents

1	Safety warnings.....	13
2	Symbols.....	13
3	Intended use.....	14
4	Technical data.....	14
5	Parts of the machine.....	14
6	Commissioning.....	15
7	Settings.....	15
8	Working.....	16
9	Service and maintenance.....	16
10	Troubleshooting.....	17
11	Transportation.....	17
12	Environment.....	17
13	General information.....	17

1 Safety warnings



Warning! Read and observe all instructions and safety warnings. Failure to observe the instructions and safety warnings may lead to electric shocks, fires and/or serious injuries.

Keep all safety warnings and instructions for future reference.

- This appliance must not be used by persons (including children) with reduced physical, sensory or mental capabilities, or lack of experience and knowledge. **Children** need to be supervised to ensure they do not play with the device.



- **Warning** Device may contain hazardous dust. Only have the device maintained and emptied, and only have the filter replaced by an authorised specialist using suitable protective equipment.
- Always operate with the filter system installed!



WARNING

This machine is only intended for dry applications.



CAUTION

This machine is only intended for indoor applications. This machine must always be stored indoors.

- **Risk of explosion and fire: Do not extract:**
 - Sparks or hot dust;

- combustible or explosive materials (e.g. magnesium, aluminium, petrol, diluting agents);
- aggressive materials (e.g. acid, alkaline solutions, solvents);
- chemically reactive materials, which lead to the generation of heat, acids/bases, gases, etc. (e.g. reactive two-component materials, aluminium and water).
- Observe all national safety regulations as well as the material manufacturer's specifications!
- Always use suitable protective equipment!
- If intact following a visual inspection, work in a dry environment according to instructions!
- Only use the electrical outlet module on the device for its stated purpose.
- Check the plug, cable and socket regularly to avoid hazards and have them replaced by an authorised after-sales service workshop if they become damaged.
- Do not lift or transport the device using a crane hook or lifting gear.
- Risk of tilting, do not place on sloped areas!
- This machine must not be used by people who might have a particularly adverse reaction to an electric shock (e.g. **people with cardiac pacemakers**), because the possibility of the machine building up a static charge cannot be excluded.
- **Pay attention to the work environment and watch out for your own safety and the safety of others when transporting or working with the machine.**
In this way, you can for example prevent tripping hazards caused by the suction hose or mains cable.
- Use only the original Festool suction hose.
- **Keep packaging film away from children.**
There is a risk of suffocation.

2 Symbols

Symbol Meaning



Warning of general danger



Risk of electric shock



Read the operating manual and safety warnings.

Symbol Meaning



Wear a dust mask.



Tip or advice



Handling instruction

**Warning!** The machine may contain hazardous dust!

Climbing prohibited



Do not leave in the rain!



Do not absorb any water or liquids!



Risk of tilting!



UKCA marking: The United Kingdom Conformity Assessed symbol is a marking for products being placed on the market in the United Kingdom. It is a manufacturer's indication that the product is in conformance with the relevant regulations in the UK.

3 Intended use

Dust extractor suitable for

- extracting dust with limit values up to 1 mg/m³ corresponding to dust class L,
- for increased loads during commercial use, according to IEC/EN 60335-2-69.

Dust extractor **not recommended** for continuous extraction of fine dust, such as cement dust or filler.



The user is liable for improper or non-intended use.

4 Technical data

Dust-extractor		
Power consumption		1000 W
Max. electrical outlet module connected load	EU	1200 W
	CH, DK, GB	1300 W
	AUS	1400 W
Max. suction capacity (air), extractor/turbine		108 m ³ /h / 180 m ³ /h
Max. vacuum, turbine		200 hPa
Filter surface area		5357 cm ²
Suction hose		D 27 mm x 3.0 m-AS
Mains power cable length		5.0 m
Sound pressure level as per EN 60704-2-1/uncertainty K		67 dB(A)/3 dB
Vibration value at the cleaning nozzle/instability		< 2.5 m/s ² / 1.5 m/s ²
Type of protection		IP X0
Container capacity		4,5 l
Dimensions L x W x H	CTL SYS with storage box	396 x 296 x 270 mm
	only CTL SYS	396 x 296 x 162 mm
Weight	CTL SYS with storage box	6.9 kg

5 Parts of the machine

[1-1] Dust-extractor

[1-2] Storage box

[1-3] Extractor hose

[1-4] Handle

[1-5] Angle piece

- [1-6]** T-Loc lock for Systainers
- [1-7]** Cold-device plug
- [1-8]** On/off switch
- [1-9]** AUTO/MAN switch
- [1-10]** Electrical outlet module

The specified figures appear at the beginning of the operating manual.

6 Commissioning



WARNING

Unauthorised voltage or frequency!

Risk of accidents

- ▶ Observe the specifications on the machine's name plate.
- ▶ Observe country-specific regulations.

6.1 Connect dust extractor



WARNING

Risk of injury from tools starting up unexpectedly

- ▶ Before switching on ensure that the connected tool is switched off.
- ▶ Insert the mains power cable in the cold-device connector [2] and in an earthed socket.
- ▶ Lay the mains cable through the recess [2].

The switch [1-8] serves as an on/off switch.

Using the [1-9] switch, switch between the AUTO and MAN settings.

"MAN" switch position

Appliance socket [1-10] is not connected to the power, the dust extractor starts.

"Auto" switch position

Appliance socket [1-10] is connected to the power, the dust extractor starts when the connected tool is switched on.



Pull the plug from the socket when the machine is not in use and prior to maintenance and cleaning work.

6.2 Connecting electric power tools



WARNING

Risk of injury

- ▶ Observe the maximum appliance socket connected load (see chapter "Technical data")
- ▶ Switch off the electric power tool.
- ▶ Connect the electric power tool to the appliance socket .

6.3 Connecting the suction hose

at the extraction opening [3a]

- ▶
- ▶ Connect the suction hose to the elbow at the extraction opening.

at the exhaust opening [3b]

- ▶ Open flap at rear of dust extractor.
- ▶ Connect suction hose to elbow at exhaust opening.

7 Settings

7.1 Temperature monitoring

Before reaching a critical temperature, the temperature monitor switches off the dust extractor.

- ▶ Before reaching a critical temperature, the temperature monitor switches off the dust extractor.
- ▶ Switch off the dust extractor, allow to cool for about 5 minutes, then switch on again.

 Not possible to switch on: Contact Festool customer service workshop.

7.2 Connect with the T-Loc

The dust extractor can be closed, opened and connected by turning the T-Loc:

- Close dust extractor [4a].
- Open dust extractor [4b].
- Connect dust extractor to storage box [4c].



Before lifting, always close the T-Loc at the dust extractor or connect to the storage box and check for secure holding.

Max. load for connection to other Systainers: 20 kg

7.3 Use/Adjust carrying strap

Max. permissible load of carrying strap: 20 kg

The carrying strap can be attached in two different positions:

- Carrying the dust extractor: Carrying strap at dust extractor [5a]

- Carrying storage box with dust extractor:
Carrying strap at storage box **[5b]**

 Before lifting, check the carrying strap for proper functionality and put T-loc at dust extractor into corresponding position.

Adjust the length of the carrying strap at the adjusting tab **[5c]**.

7.4 Connecting sleeve

The bypass function of the connecting sleeve prevents strong suction from sanding machines and floor nozzles on smooth surfaces.

Open

- ▶ Turn the adjusting ring to the "OPEN" position.

Close

- ▶ Turn the adjusting ring to the "CLOSE" position.

8 Working



CAUTION

Hazardous dust

Damage to the respiratory passage

- ▶ Always use a filter bag!

 Two cleaning nozzles are stored in the inside of the dust extractor **[6-1]**.

Observe the following information:

- The dust extractor is a stationary system and not suitable for pulling at the cable and hose. Use handle **[1-4]**.
- A static charge may build up if no antistatic suction hose is used. The user may receive an electric shock.

 When extracting dust that exceeds the limit value, only extract from one dust source (power or compressed-air tool).

Observe the following when extracting dust generated by operating power tools:

Ensure there is adequate ventilation! Observe regional regulations!

Limit values: Exhaust air max. 50% of the fresh air volume

Equation: Room volume V_R x air renewal rate L_W

Please note the following after the work:

- ▶ Switch off the dust extractor and pull out the mains plug.
- ▶ Wind up the mains power cable.
- ▶ Empty the dirt trap.

- ▶ Place suction hose **[1-3]** and mains power cable in storage box.
- ▶ Clean inside and outside of dust extractor by applying vacuum and wipe.
- ▶ Place the dust extractor in a dry room inaccessible to unauthorised users.

9 Service and maintenance



WARNING

Risk of injury, electric shock

- ▶ Always pull the mains plug from the socket before performing any servicing and maintenance work.
- ▶ All maintenance and repair work which requires the motor housing to be opened should always be carried out by an authorised service workshop.



Customer service and repairs must only be carried out by the manufacturer or service workshops: Find the nearest address at: www.festool.com/service



Always use original Festool spare parts. Order no. at: www.festool.com/service

- ▶ Regularly replace the filter bag and clean the container and seals.

Observe the following information:

- Dust-related inspection (e.g. for filter damage, tightness of the machine and function of the control devices) by the manufacturer or an instructed person at least once a year.
- Dispose of components that cannot be cleaned. Use impermeable bags to do so. Observe the applicable disposal provisions!

9.1 Changing the filter bag

- ▶ Open dust extractor with T-Loc **[6]**. **Attention: Risk of tilting!**
- ▶ Changing the filter bag:
 - ▷ Remove filter bag **[7]**.
 - ▷ Insert a filter bag **[8]**.
- ▶ Close dust extractor with T-Loc.

9.2 Changing the filter element [9]

NOTICE

Motor damage

- ▶ Never operate the extractor without a filter element fitted as the motor may become damaged.
- ▶ Open dust extractor with T-Loc [6]. **Attention: Risk of tilting!**
- ▶ Unlock and fold down lever.
- ▶ Remove container upwards.
- ▶ Remove used filter element and replace with a new one.
- ▶ Dispose of the used filter element in accordance with statutory regulations.
- ▶ Clean container and seals.
- ▶ Insert container. Fold up and lock lever.
- ▶ Close dust extractor with T-Loc.

 The order numbers for accessories, filters and consumables can be found in the Festool catalogue or on the internet at www.festool.com.

10 Troubleshooting

Flow noise during dust extraction

Automatic bypass: A valve opens that supplies the turbine with cooling air:

Cause Blocked filter element, filter bag full or blocked suction hose

Solution Empty container, replace or clean filter element, replace filter bag, check suction hose for blockage and remove, if necessary

11 Transportation

Observe the following information:

- Before transportation, always close the T-Loc at the dust extractor or connect to the storage box.
- For transportation in vehicles, secure the device against slipping and tilting in accordance with the valid guidelines.

12 Environment



Do not dispose of the device in the household waste! Recycle devices, accessories and packaging. Observe applicable national regulations.

EU only: In accordance with the European Directive on waste electrical and electronic equipment and implementation in national law, used power tools must be collected separately and handed in for environmentally friendly recycling.

Information on REACH: www.festool.co.uk/reach

13 General information

Imported into the UK by

Festool UK Ltd
1 Anglo Saxon Way
Bury St Edmunds
IP30 9XH
Great Britain