



- Patented handle design makes every job faster and easier
- Durable GorillaGrip® handle is stronger than steel handles
- Precision cut and chamfered tip ensures full tool engagement in the screw

### Color-Coded

- Inch
- Metric
- TORX®
- Inch/Metric
- Motorcycle
- Utility

**BONDHUS**  
**LIFETIME WARRANTY**  
 If any Bondhus® tool breaks or fails to meet your expectations in any way, simply return it. We will replace it free of charge.

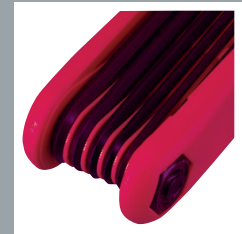

Individual spacers between tools allow for easy selection of one tool at a time.



Blades are accessed from both the top and bottom, eliminating the constant 'unstacking' of blades.

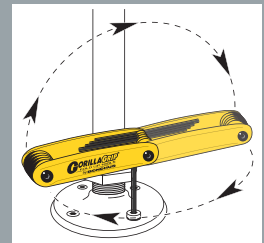

Turn & Flip Feature eliminates constant removal and repositioning in screw head when working against obstructions.

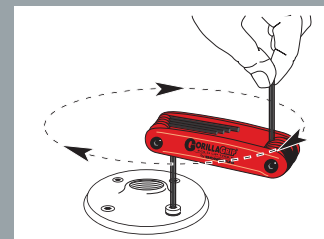

90° stop converts the tool into a non-stop, time saving, speed wrench.

## ProFanium® High Torque Steel:

Up to 20% stronger, with more torque and twice the wear resistance of standard grades of steel.

### FINISH OPTIONS:

**ProGuard DST** Corrosion-resistant finish:  
 Environmentally safe, provides better tool grip, resists solvents and is 5 times more corrosion resistant than competitor finishes.

**BriteGuard FINISH** Next generation chrome finish:  
 Traditional plated tool look with superior protection and durability.

**GoldGuard FINISH** Real 14 karat gold finish:  
 Superior protection and durability over traditional chrome and the look and shine of real gold.