

de	Originalbetriebsanleitung	7	lv	Originālā lietošanas pamācība	39
en	Original instructions	9	nb	Original bruksanvisning	41
fr	Notice d'utilisation d'origine	11	nl	Originele gebruiksaanwijzing	43
es	Manual de instrucciones original	13	pl	Oryginalna instrukcja obsługi	45
bg	Оригинална инструкция за експлоатация	15	pt	Manual de instruções original	47
cs	Původní návod k obsluze	17	ro	Manualul de utilizare original	49
da	Original brugsanvisning	19	ru	Оригинальное руководство по эксплуатации	51
el	Πρωτότυπο οδηγίων χρήσης	21	sk	Originálny návod na obsluhu	53
et	Originaalkasutusjuhend	23	sl	Originalna navodila za uporabo	55
fi	Alkuperäiset käyttöohjeet	25	sr	Originalno uputstvo za rad	57
hr	Originalne upute za uporabu	27	sv	Originalbruksanvisning	59
hu	Eredeti használati utasítás	29	tr	Orijinal işletme kılavuzu	61
is	Þýðing notendahandbókar úr frummáli	31	zh	原版使用说明书	63
it	Istruzioni d'esercizio originali	33			
ko	원본 사용 설명서	35			
lt	Originali naudojimo instrukcija	37			

AH-ES-ETS/ ETSC

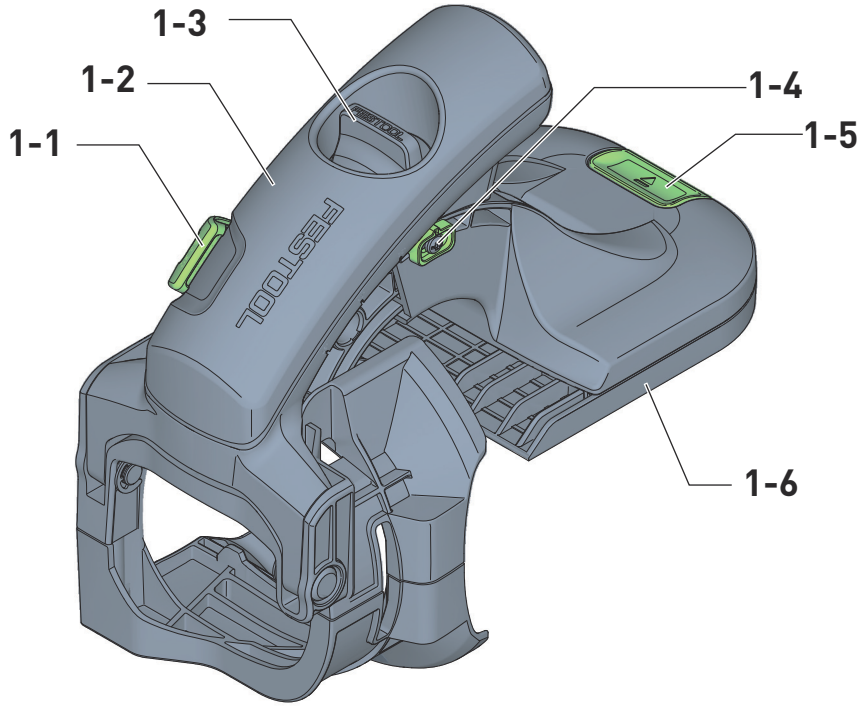

1



2

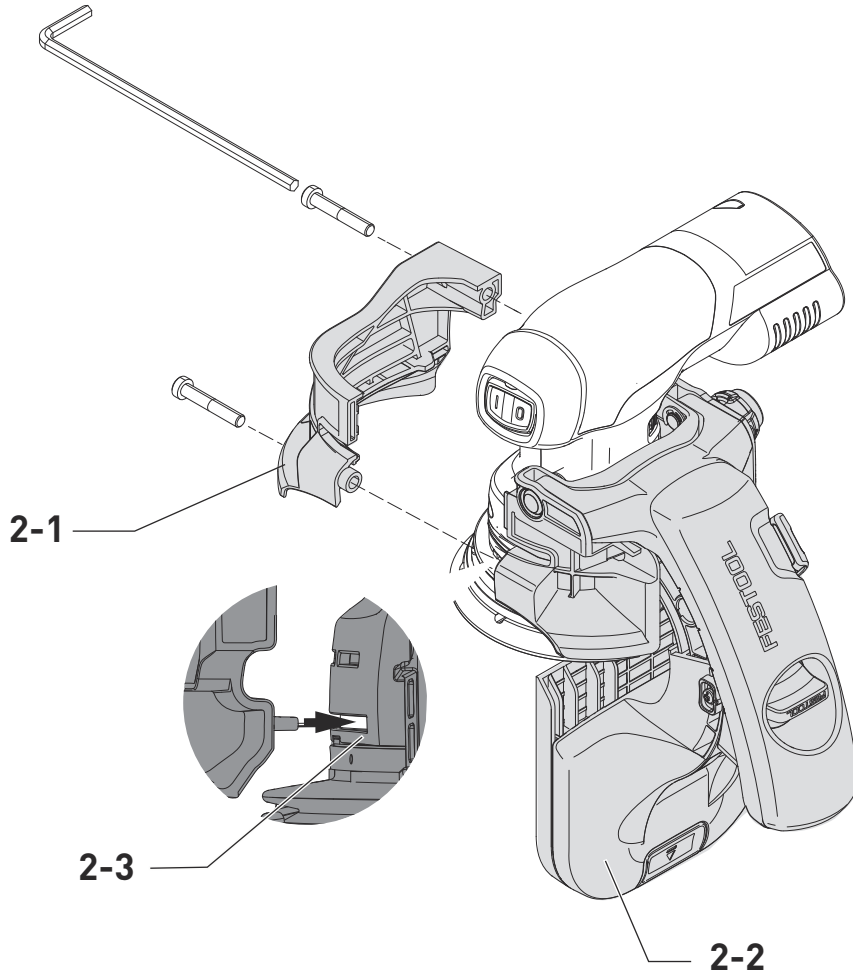
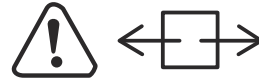

3

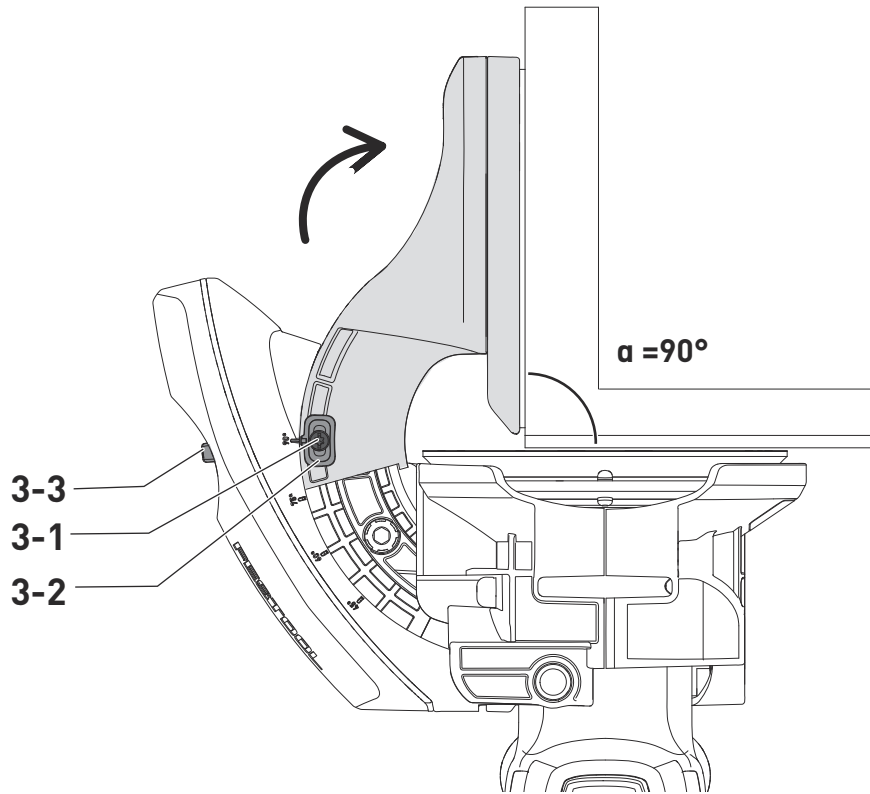
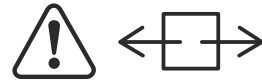

4a

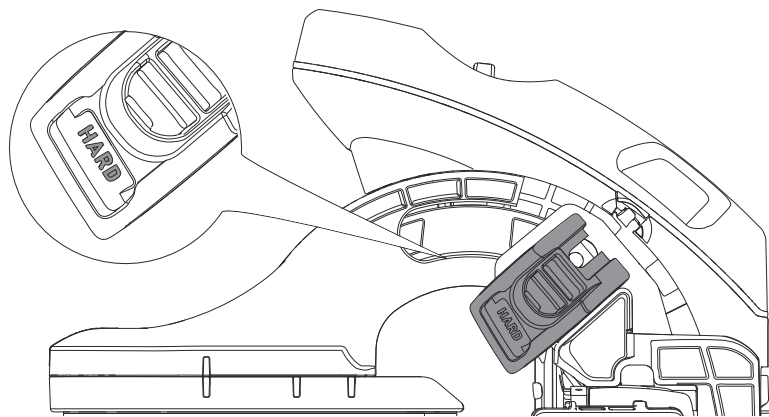

4b

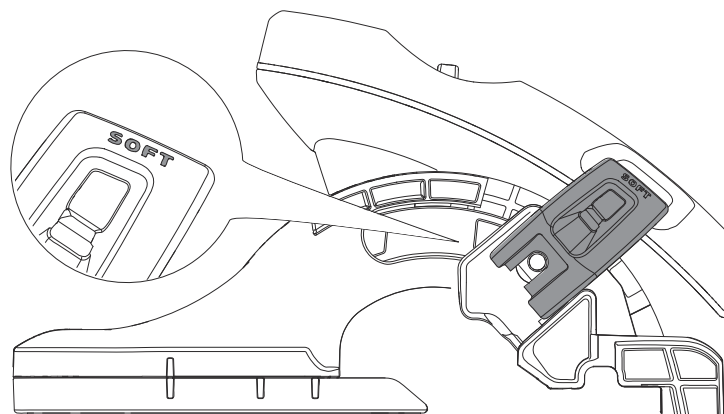

5

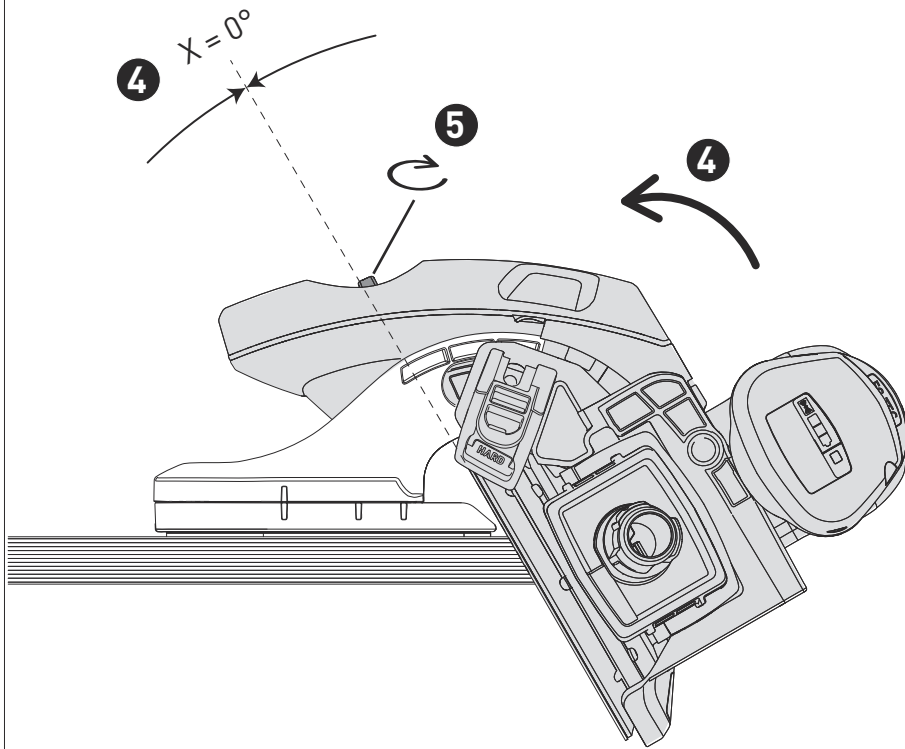
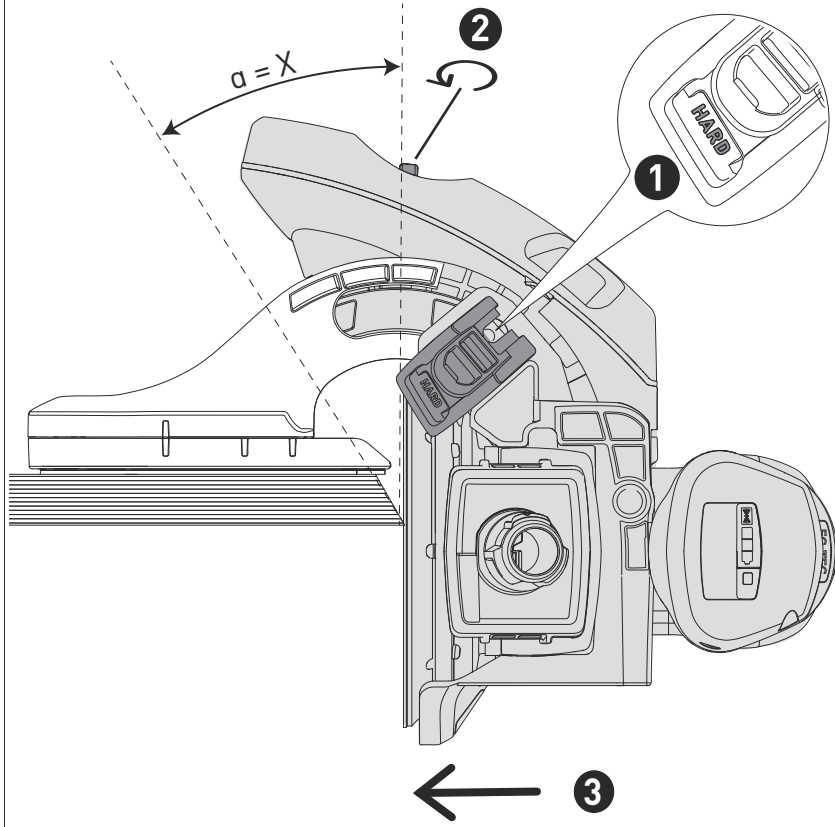
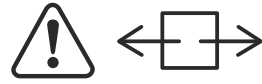

6

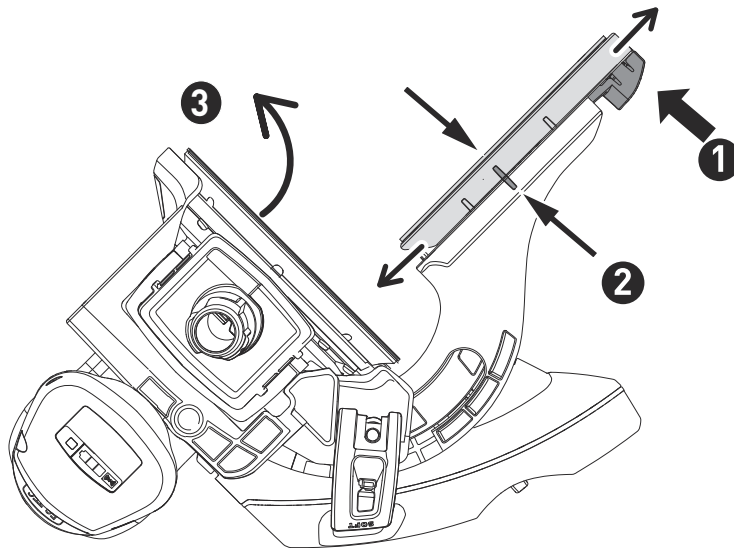

7a

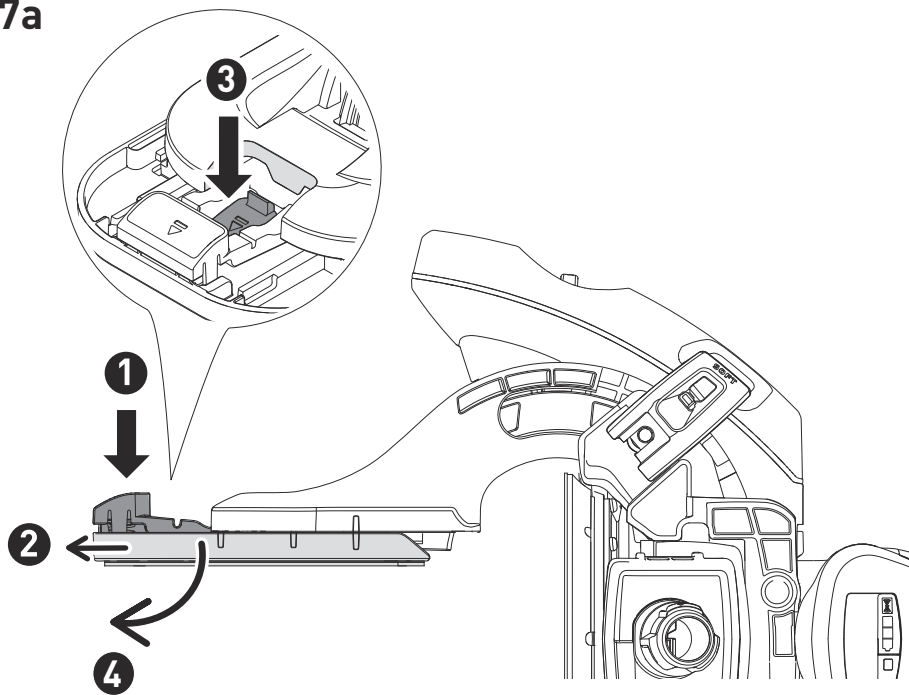

7b

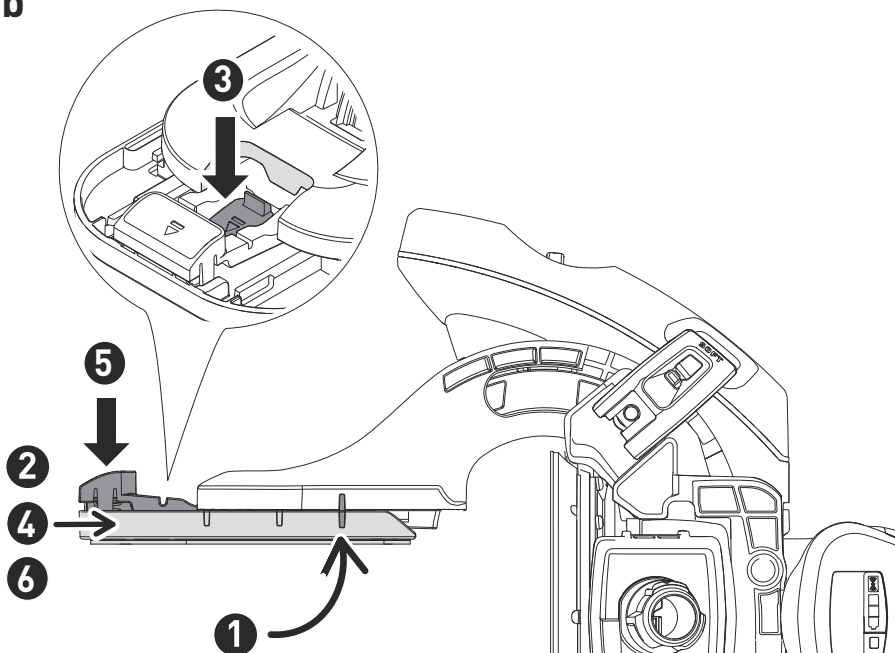

8

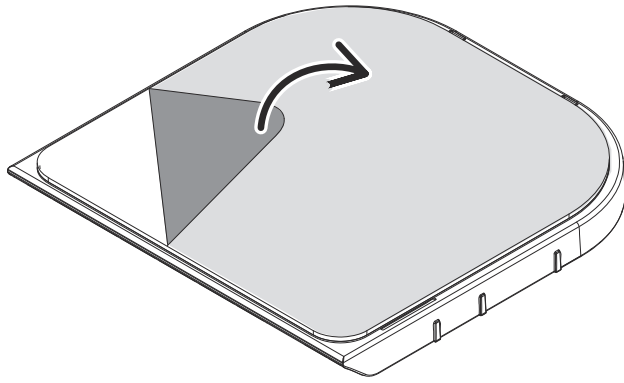

9

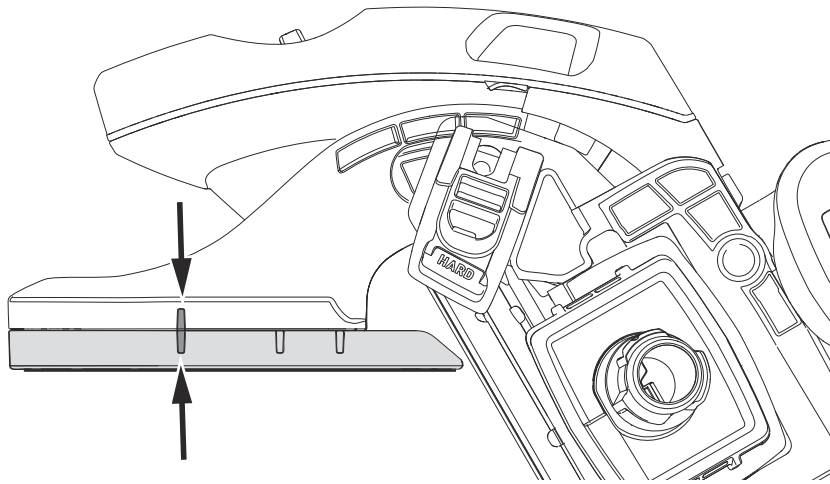

10

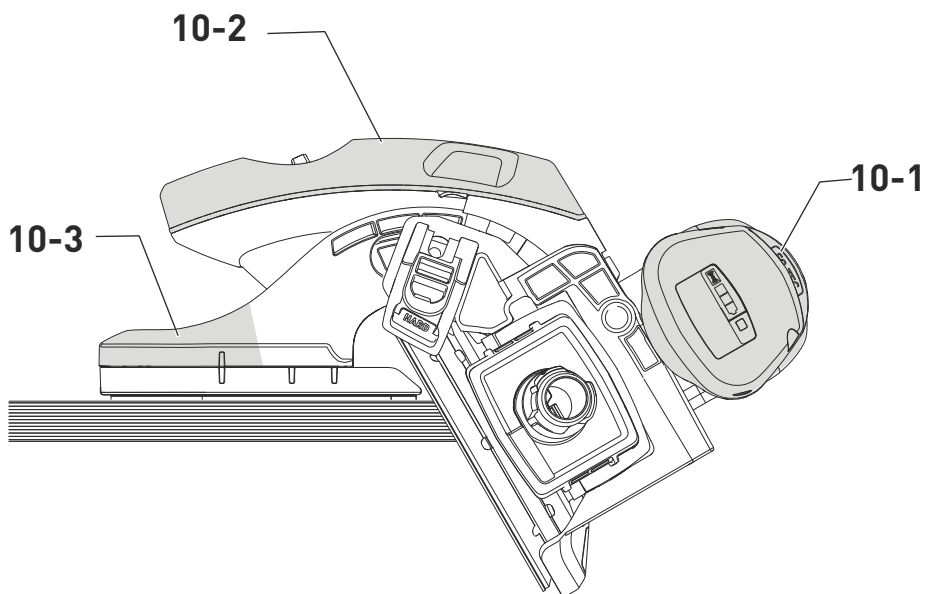

1 Symbols



Warning of general danger



Read the operating instructions and safety instructions.



Do not dispose of it with domestic waste.



Disconnecting the mains power cable



Tip or advice

▶ Handling instruction

2 Safety warnings



WARNING! Read all safety warnings, instructions, illustrations and specifications provided with this power tool. Failure to follow all instructions listed below may result in electric shock, fire and/or serious injury.

Save all warnings and instructions for future reference.

The term "power tool" in the warnings refers to your mains-operated (corded) power tool or battery-operated (cordless) power tool.

Observe the operating manual of the power tool.

3 Intended use

The AH-ES-ETS/ETSC is intended for sanding edges in connection with the ETS 125 REQ, ETSC 125 Li power tools.

The AH-ES-ETS/ETSC must **not** be used in conjunction with the ETS 125 EQ power tools or any orbital sanders/delta sanders (DTS 400, RTS 400, DTSC 400, RTSC 400).



Do not use the AH-ES-ETS/ETSC with the ST-STF 125/8-M4-J SW sanding pad. The larger size of the sanding pad can cause the abrasive to collide with the base runner.

4 Parts of the device

- [1-1] Sanding mode setting
- [1-2] Handle
- [1-3] Angle lock rotary knob
- [1-4] Angle display

[1-5] Base runner button

[1-6] Base runner

The specified illustrations appear at the beginning of the Operating Instructions.

5 Assembly

5.1 AH-ES-ETS/ETSC Assembling on the power tool [2]

- ▶ Insert the housing shell [2-2] into the protector groove [2-3] of the power tool.
- ▶ Place the counterpart housing shell [2-1] on top.
- ▶ Connect the housing shells with the two enclosed screws and a hex key.

5.2 Calibrating the angle display [3]

The machine has an adjustable angle display. After first assembling it on your power tool, the angle display must be calibrated to your power tool.

- ▶ Set the sanding mode to "Hard" (see Section 6.1).
- ▶ Release the angle lock rotary knob [3-3].
- ▶ Use a measuring tool to set the angle to 90°.
- ▶ Tighten the angle lock rotary knob.
- ▶ Loosen the angle calibration locking screw [3-1].
- ▶ Move the angle display [3-2] until the display points to the 90° mark.
- ▶ Tighten the angle calibration locking screw.

6 Settings



WARNING

Risk of injury, electric shock

- ▶ Always disconnect the mains plug from the socket before performing any work on the machine.

6.1 Sanding mode setting

Hard mode [4a]

In Hard mode (setting for pre-sanding), the edge is sanded according to the set angle.

Soft mode [4b]

In Soft mode (setting for intermediate sanding), the AH-ES-ETS/ETSC adapts exactly to the existing surface so that paint or filler is not sanded through.

6.2 Setting the sanding angle

See figure [5].

6.3 Changing the abrasives

See figure [6].

6.4 Changing the base runner

- ▶ Removing the base runner [7a].
- ▶ Inserting the base runner [7b].

i Use

- the enclosed LAS-H-ES base runner for rough surfaces,
- the LAS-W-ES base runner with hook-and-loop fastening and a velour slideway lining for delicate surfaces.

6.5 Changing the slideway lining

See figure [8].

The GB-LAS-STF-ES/5 slideway lining can be purchased as a consumable.

- i** When sanding different materials, use a separate slideway lining for each material (e.g. one slideway lining for oiled surfaces and another slideway lining for painted surfaces). This avoids errors in the surface coating.

7 Working with the electric power tool

- i** When working, never push down the power tool so firmly that the sanding pad can no longer rotate.

7.1 Base runner working position

See figure [9]

7.2 Working position for hands

When working, always hold the machine with one hand on the power tool [10-1]. We recommend placing the other hand on the handle part [10-2] or over the base runner [10-3].

8 Accessories

Refer to the Festool catalogue for the order numbers of accessories and tools or find them online at www.festool.co.uk.

9 Environment



Do not dispose of the device in the household waste! Recycle devices, accessories and packaging. Observe applicable national regulations.

EU only: In accordance with the European Directive on waste electrical and electronic equipment and implementation in national law, used power tools must be collected separately

and handed in for environmentally friendly recycling.

Information on REACH: www.festool.com/reach