

# Operating Instructions

—— Mobile gantry crane

—— PK 1



PK 1

PK 1

## Imprint

### Product identification

Mobile gantry crane      Item number  
PK 1                              6172100

### Manufacturer

Stürmer Maschinen GmbH  
Dr.-Robert-Pfleger-Str. 26  
D-96103 Hallstadt

Fax:                      0049 (0) 951 96555 - 55

E-Mail:                info@unicraft.de  
Internet:              www.unicraft.de

### Indications regarding the operating instructions

Original instructions

Edition:              02.10.2019  
Version:               1.03  
Language:            English

Author:                MS/FL

### Indications regarding the copyright

Copyright © 2019 Stürmer Maschinen GmbH, Hallstadt, Germany.

The contents of these operating instructions are the sole property of the company Stürmer. Passing on as well as copying of this document, the use and distribution of its content are prohibited if not explicitly permitted. Contraventions are liable to compensation.

Subject to technical modifications and error.

## Contents

<b>1 Introduction .....</b>	<b>3</b>
1.1 Copyright.....	3
1.2 Customer service.....	3
1.3 Limitation of liability .....	3
<b>2 Safety.....</b>	<b>3</b>
2.1 Symbol explanation .....	3
2.2 Obligations of the operating company .....	4
2.3 Requirements to staff.....	5
2.4 Personal protective equipment.....	5
2.5 General safety regulations.....	5
2.6 Safety information for operating personnel .....	6
2.7 Safety marking on the gantry crane .....	6
2.8 Checks.....	6
<b>3 Intended use .....</b>	<b>6</b>
3.1 Predictable misuse .....	6
3.2 Residual risks .....	6
<b>4 Technical Data .....</b>	<b>7</b>
4.1 Table.....	7
4.2 Type plate.....	7
<b>5 Transport, packaging, storage.....</b>	<b>7</b>
5.1 Transport .....	7
5.2 Packaging.....	7
5.3 Storage .....	7
<b>6 Description of the device.....</b>	<b>7</b>
<b>7 Assembly .....</b>	<b>8</b>
<b>8 Operation .....</b>	<b>9</b>
8.1 Operating conditions .....	9
8.2 Workflow .....	9
<b>9 Care, maintenance and repair .....</b>	<b>11</b>
9.1 Care by cleaning .....	11
9.2 Maintenance .....	11
<b>10 Checking the gantry crane .....</b>	<b>11</b>
<b>11 Disposal, recycling of used devices.....</b>	<b>11</b>
11.1 Decommissioning .....	11
<b>12 Spare parts.....</b>	<b>12</b>
12.1 Ordering spare parts .....	12
12.2 Spare parts drawing .....	13
<b>13 EC Declaration of Conformity .....</b>	<b>14</b>
<b>14 Notes .....</b>	<b>15</b>

## 1 Introduction

You have made a good choice by purchasing the UNICRAFT Mobile gantry crane.

**Read the operating manual thoroughly before commissioning the machine.**

It gives you information about the proper commissioning, intended use and safe and efficient operation and maintenance of your Mobile gantry crane.

The operating manual is part of the Mobile gantry crane package. Always keep this operating manual in the location where your Mobile gantry crane is being operated. All local accident prevention regulations and general safety instructions for the operating range of your Mobile gantry crane must also be complied with.

### 1.1 Copyright

The contents of these instructions are copyright. They may be used in conjunction with the operation of the machine. Any application beyond those described is not permitted without the written approval of Stürmer GmbH. For the protection of our products, we shall register trademark, patent and design rights, as this is possible in individual cases. We strongly oppose any infringement of our intellectual property.

### 1.2 Customer service

Please contact your dealer if you have questions concerning your device or if you need technical advice. They will help you with specialist information and expert advice.

**Germany:**

Stürmer Maschinen GmbH  
Dr.-Robert-Pfleger-Str. 26  
D-96103 Hallstadt

**Repair service:**

Fax: 0049 (0) 951 96555-111  
E-Mail: service@stuermer-maschinen.de

**Spare part orders:**

Fax: 0049 (0) 951 96555-119  
E-Mail: ersatzteile@stuermer-maschinen.de

We are always interested in valuable experience and knowledge gained from using the application-which then could be shared and be valuable to develop our products even further.

## 1.3 Limitation of liability

All information and notes in these operating instructions were summarised while taking applicable standards and rules, the state-of-the-art technology and our long-term knowledge and experiences into consideration.

In the following cases the manufacturer is not liable for damages:

- Non-observance of the operating instructions,
- Inappropriate use
- Use of untrained staff,
- Unauthorised modifications
- Technical changes,
- Use of not allowed spare parts.

The actual scope of delivery may deviate from the explanations and presentations described here in case of special models, when using additional ordering options or due to latest technical modifications.

The obligations agreed in the delivery contract, the general terms and conditions as well as the delivery conditions of the manufacturer and the legal regulations at the time of the conclusion of the contract are applicable.

## 2 Safety

This section provides an overview of all important safety packages for the protection of operating personnel as well as for safe and fault-free operation. Other task-based safety notes are included in the paragraphs of the individual phases of life.

### 2.1 Symbol explanation

**Safety instructions**

The safety notes in these operating instructions are highlighted by symbols. The safety notes are introduced by signal words which express the concern of the risk.



**DANGER!**

This combination of symbol and signal words indicates an imminently dangerous situation which may lead to death or severe injury if not avoided.



**WARNING!**

This combination of symbol and signal words indicates a potentially dangerous situation which may lead to death or severe injury if not avoided.



### CAUTION!

This combination of symbol and signal words indicates a potentially dangerous situation which may lead to slight or minor injury if not avoided.



### ATTENTION!

This combination of symbol and signal words indicates a possibly dangerous situation which may lead to property and environmental damages if they are not avoided.



### NOTE!

This combination of symbol and signal words indicates a potentially dangerous situation which may lead to material or environmental damage if not avoided.

### Tips and recommendations



### Tips and recommendations

This symbol highlights useful tips and recommendations as well as information for an efficient and trouble-free operation.

It is necessary to observe the safety notes written in these operating instructions in order to reduce the risk of personal injuries and damages to property.

## 2.2 Obligations of the operating company

### of the operator

The operating company is the person who operates the device for business or commercial reasons by her-self, or leaves it to a third party for use or application, and who bears the legal product responsibility for the protection of the user, the staff or for third parties.

### Obligations of the operating company

If the device is used for commercial purposes, the operating company of the device must comply with the legal working safety regulations. Therefore, the safety notes in this operating manual, as well as the safety, accident prevention and environment protection regulations applying for the area of application of the device must be met. The following applies in particular:

- The operating company must be informed about the applying industrial safety regulations and further analyse hazards resulting from the special working conditions at the place of use of the device. She must implement these in form of operating manuals for the operation of the device.
- During the entire lifetime of the device, the operating company must verify whether the operating manuals prepared by her correspond to the current status of the regulations, and must adapt these if necessary.
- The operating company must unambiguously regulate and determine the responsibilities for installation, operation, troubleshooting, maintenance and cleaning.
- The operating company must ensure that all persons who work with the device, have read and understood this manual. Furthermore she must instruct the staff in regular intervals and inform them about the hazards.
- The operator must provide the necessary protective equipment to the staff and order the use of the necessary protective equipment in a binding way.

Furthermore the operating company is responsible to keep the device always in a technically flawless state. Thus, the following applies:

- The operator must ensure that the maintenance intervals described in this manual are kept.
- The operator must have all safety devices checked regularly for their good working order and their integrity.

## 2.3 Requirements to staff

### Qualifications

The different tasks described in this manual represent different requirements to the qualification of the persons entrusted with these tasks.



#### **WARNING!**

#### **Danger in case of insufficient qualification of the staff!**

Insufficiently qualified persons cannot estimate the risks while using the device and expose themselves and others to the danger of severe or lethal injuries.

- Have all works only performed by qualified persons.
- Keep insufficiently qualified persons out of the working area.

Only persons reliable working procedures can be expected from, are allowed to perform all works. Persons the responsiveness of which is affected by e. g. drugs, alcohol or medication, are not allowed to work with the machine.

The qualifications of the personnel for the different tasks are mentioned below:

### Operator

The operator is instructed by the operating company about the assigned tasks and possible risks in case of improper behaviour. Any tasks which need to be performed beyond the operation in the standard mode must only be performed by the operator if it is indicated in these instructions and if the operating company expressly commissioned the operator.

### Qualified personnel

Due to their professional training, knowledge and experience as well as their knowledge of relevant regulations the specialist staff is able to perform the assigned tasks and to recognise and avoid any possible dangers themselves.

### Manufacturer

Certain works may only be performed by specialist personnel of the manufacturer. Other personnel is not authorized to perform these works. Please contact our customer service for the execution of all arising work.

## 2.4 Personal protective equipment

The personal protective equipment serves to protect persons against impairments of safety and health while working. The staff member has to wear personal protective equipment while performing different tasks on and with the machine which are indicated in the individual paragraphs of these instructions.

The personal protective equipment is explained in the following paragraph:



### **Head protection**

The industrial helmet protects the head against falling objects and hitting on fixed objects.



### **Protective gloves**

The protective gloves serve to protect the hands against sharp components as well as against friction, abrasions or deep injuries.



### **Safety boots**

Safety boots protect the feet from being crushed, falling parts and slipping over on slippery ground.



### **Protective clothes**

Protective clothes are made of a tightly fitted fabric without the protruding parts of low tear strength.

## 2.5 General safety regulations



### **NOTE!**

In each case, the regulations or guidelines and standards valid in the country of use must be observed (in the respectively valid version).

In Germany at the moment  
DIN EN 1494: 2000 + A1: 2008: Mobile or portable lifting equipment and related equipment; EC Machinery Directive 2006/42 / EC

Upgrading, conversion, maintenance and inspection activities may only be carried out by trained, qualified personnel when the machine is not in use. Unauthorized modifications and modifications to the gantry crane are not permitted for safety reasons.

The operating staff must always make sure that the max. Carrying capacity is not exceeded.

When using the gantry crane make sure that the load is correctly and safely connected to the chain and that it is securely connected to the gantry crane.

Stopping under a suspended load should be avoided as loose objects may fall off at any time.

The transport and lifting of persons is prohibited. It is not permitted to enter the lifting device.

## 2.6 Safety information for operating personnel

It is necessary to refrain from any work that affects the safety of the gantry crane.

The operator must also ensure that no unauthorized persons work with the gantry crane. The operator is obliged to inspect the gantry crane at least once before use (daily) for externally visible damage and defects. Any changes that impair safety must be reported immediately. Damaged or heavily worn parts must be replaced immediately.

The operator has to ensure that the gantry crane is always operated in perfect condition. If necessary, the operator must oblige operating personnel to wear protective clothing, etc.

In principle, no safety equipment may be dismantled or taken out of operation (already here is concretely to warn of impending hazards, so for example on imminent severe bruising, loss of sight, danger to life). If the disassembly of safety equipment is required during set-up, repair and maintenance, the safety equipment must be reassembled immediately after completion of the maintenance or repair work.

## 2.7 Safety marking on the gantry crane

The following safety signs are attached to the gantry crane (Fig. 1), which must be observed and followed.



Fig. 1: Safety labels

The safety labels attached to the portal crane must not be removed. Damaged or missing safety signs can lead to malfunctions, personal injury and property damage. They are to be replaced immediately.

If the safety signs are not immediately recognizable and comprehensible, the gantry crane should be taken out of operation until new safety signs have been attached.

## 2.8 Checks

The gantry crane is a testable suspension. It must be tested by a qualified person for operational safety before commissioning for the first time and, if required, at intervals of no more than 1 year in accordance with the provisions of the German Industrial Safety Ordinance and DGUV Rule 100-500, Chapter 2.8.

## 3 Intended use

The gantry crane is used exclusively for loading and unloading, for assembly, repair or storage work on level, smooth and sufficiently load-bearing floors in workshops and halls. The specified maximum load must not be exceeded. The gantry crane must be secured against rolling away.

The gantry crane may only be operated by instructed persons.

Proper use also includes compliance with all information in this manual. Any use beyond the intended use or otherwise is considered misuse. The lifting of persons is strictly prohibited. Use of the device in other areas is considered improper use.

For structural and technical changes to the gantry crane, the company Stürmer Maschinen GmbH assumes no liability. Claims of any kind due to damage due to improper use are excluded.

### 3.1 Predictable misuse

With the gantry crane, if the intended use is observed, no reasonably foreseeable misuse is possible which could lead to dangerous situations with personal injury.

### 3.2 Residual risks

Even if all safety regulations are adhered to, the residual risks described below remain with the operation of the gantry crane.

All persons working with the gantry crane must be aware of these residual risks and follow the instructions that prevent these residual risks leading to accidents or damage:

- During operation there is a risk of crushing the upper and lower limbs.

## 4 Technical Data

### 4.1 Table

Type	PK 1
Load-carrying capacity	1,0 t
Height min.	2200 mm
Height max.	3600 mm
Clear width	2400 mm
Double-T bars (W x H)	74 x 120 mm
Length	2500 mm
Width	1200 mm
Height	2520 mm
Weight	128 kg

### 4.2 Type plate

<b>Portalkran</b> Gantry crane			
<b>Type</b> Type	PK 1	<b>Serien-Nr.</b> Serial no.	
<b>Artikel-Nr.</b> Item no.	6172100	<b>Baujahr</b> Year of manufacture	
<b>Gewicht</b> Weight	128 kg	<b>Tragkraft</b> Capacity	1 t
 www.unicraft.de		Stürmer Maschinen GmbH Dr.-Robert-Pfleger-Str. 26, 96103 Hallstadt Deutschland / Germany	

Fig. 2: Type plate Mobile gantry crane PK 1

## 5 Transport, packaging, storage

### 5.1 Transport

Check the Mobile gantry crane on delivery for any visible transportation damage. If you notice any damage to the device please report this immediately to the carrier or dealer.



#### NOTE!

The device should be protected from humidity.

### 5.2 Packaging

All used packaging materials and packaging aids are recyclable and should be taken to a materials recycling depot to be disposed of.

The delivery packaging is made of cardboard, so please dispose carefully by having it chopped up and given to the recycling collection.

The film is made of polyethylene (PE) and the cushioned parts of polystyrene (PS). Deliver these substances to a collection point for recyclable materials or to the waste disposal company which looks after your region.

### 5.3 Storage

The Mobile gantry crane should be lubricated and then stored in a dry, frost-free environment. Do not set anything down on the Mobile gantry crane.

## 6 Description of the device

Illustrations in these operating instructions may deviate from the original.

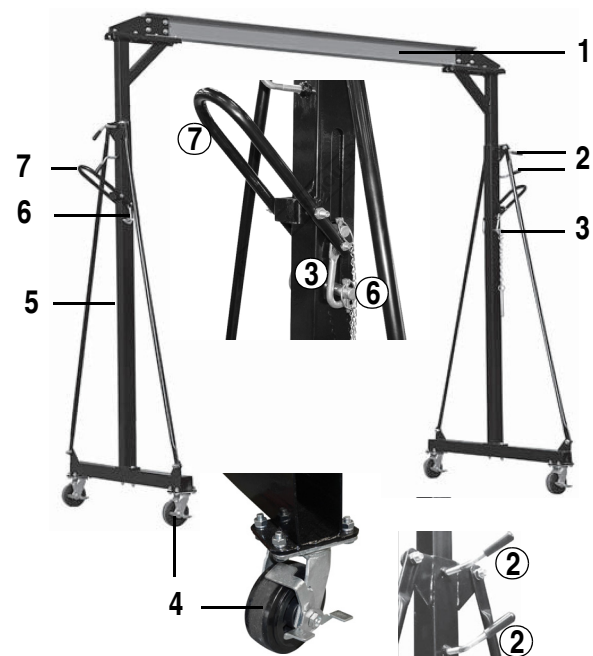

Fig. 3: Description

- 1 Rail
- 2 Clamping levers per carrier support
- 3 Carrying hooks
- 4 Swivel castors with parking brakes
- 5 Support support
- 6 Securing bolts per carrier support
- 7 Lever for height adjustment



## 7 Assembly



**Use protective gloves!**



**Use protective boots!**



**Wear protective clothes!**



**CAUTION!**

**Risk of crushing!**

Injuries to hands and fingers may result from improper use of the Mobile gantry crane.

Equipment that is not used in a fixed location must be installed in such a way that it is horizontal and that no crushing or shearing points can occur between the machine and parts of the environment. Furthermore, it must be ensured that intended activities can be carried out without hindrance.

Mount the gantry crane by using the exploded view (Fig. 6).



**DANGER!**

For safety reasons, some installation steps must be carried out by 2 or more persons!

Before the assembly of all parts is not completed, the connecting screws must not be tightened yet.

It is recommended that the parts be laid, aligned and mounted on the ground before they are tightened and the gantry crane is erected.

Step 1: Attach one plate (20) to each side of the track (19) with the screws (1), washers (2), spring washers (3) and nuts (4). Likewise for the other end of the track.

Step 2: Attach the two vertical brackets (21) to the track (19) with eight sets of screws, washers, spring washers and nuts (1, 2, 3, 4).

Step 3: Attach the four castors (27) to the trolleys (26) with the screws (15), spring washers (16) and nuts (17). Fill the bearing housings with grease over the grease nipple.

Step 4: Attach the vertical beams (23) to the chassis beams. Mount the screws (14) from above and secure with the washers (2), spring washers (3) and nuts (4).

Step 5: Attach the cross braces (22) to the chassis beam and the vertical beam using screws (5), washers (6), spring washers (7) and nuts (8). Proceed with the other chassis carrier and vertical carrier as well.

Step 6: Slide the vertical support (21) into the vertical support (23) and insert one of the pins into the holes of the vertical supports to connect and fix. Release the other pin. Attach the height adjustment lever (24) to the receptacle on the outside of the vertical support (23) and secure it by inserting the bolt (10) from the inside of the lever and the washer (14), the spring washer (15) and the nut (11). Proceed also on the other vertical support.

Step 7: Attach the Carrier Hook (25) to the Height Adjustment Lever (24) with the 13mm Bolts and Nuts.

Step 8: Insert the clamp levers (9) into the vertical supports.

Step 9: Tighten all nuts and bolts until the gantry crane is stable.



## 8 Operation



### **DANGER!**

#### **DANGER TO LIFE DUE TO FALLING OF THE LOAD!**

Falling loads can cause serious injury or death.

- Avoid overload. Check that the load never exceeds the maximum load indicated on the nameplate
- Never move the lifted load.
- Never adjust the height when the gantry crane is under load!
- The height adjustment must be made by two people.
- Never stand or work under a load held by the gantry crane.
- An elevated load must never be subjected to impact or shock loading.
- Make sure that the ground on which the gantry crane stands is level, level and sufficiently stable.
- Never attach a load to the gantry crane, which may slip or whose parts are not firmly connected.
- Never use the gantry crane in a rusted or damaged condition.
- Never leave a load attached to the gantry crane unattended.



**Use protective gloves!**



**Use protective boots!**



**Wear protective clothes!**



### **NOTE!**

- Operating personnel must be familiar with the operation and functions of the device and the safety regulations pertaining to it.
- The operator is responsible for ensuring that all operating personnel have had the necessary training.

All work with the gantry crane may only be carried out by instructed persons.

All parts of the gantry crane must be checked for correct condition before starting work, especially the lifting hooks of the lifting device.

### 8.1 Operating conditions

The work area must be dry, fire and explosion proof and free of corrosive and toxic substances.

Dangerous goods such as liquid, toxic or radioactive materials may not be attached to the gantry crane.



### **NOTE!**

The operator must have sufficient freedom of movement.



### **ATTENTION!**

#### **Risk of Crushing!**

When working with the gantry crane, it can cause bruising of the upper and lower limbs.

### 8.2 Workflow



### **DANGER!**

- Before starting work, check the gantry crane for wear or defects. The gantry crane must not be put into operation if wear or a defect is found.
- Never adjust the height when the gantry crane is under load!
- The height adjustment must be made by two people.
- The gantry crane must always be secured against rolling away for its application. In addition to locking the rollers, secure the rollers against slipping with wedges!



Fig. 4: Place the trolley on the track

Step 1: Place the trolley on the track and follow the assembly instructions supplied with the trolley (see Fig. 2).

Step 2: Attach a suitable load chain to the vehicle.

Step 3: Lifting and lowering the track:  
(Attention: Never change the height under load).  
The height adjustment must be made by 2 people in order to carry out the adjustment on both sides at the same time.

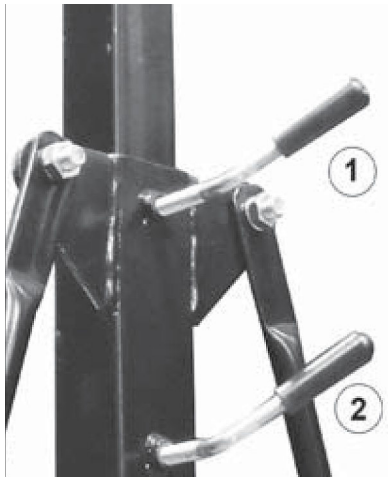

Fig. 5: Release clamping lever for height adjustment

Attention: Check that the locking bolts (fig. 4, pin 1) are in the lower position on both sides of the gantry crane.

Loosen the two clamping levers (fig. 3, 1 + 2) on each side of the gantry crane.

Step 4: Lift the Rail (Fig. 4):

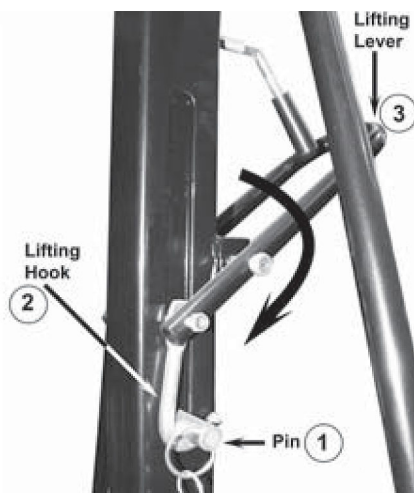

Fig. 6: Lift the Rail

Lift the suspension hooks (Fig. 4, 2) with the locking bolts in the lower position simultaneously on both sides by pressing down the two levers for height adjustment (Fig. 4, 3).

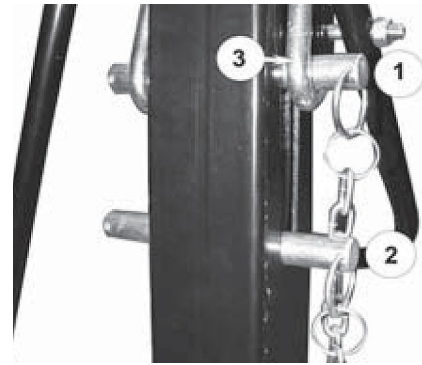

Fig. 7: Positions of the safety bolts

When the next position hole appears in the guide slot, insert the second locking pin into the newly visible lower hole - then as the lower locking pin - and slowly lower until it supports the weight (Fig. 5). Repeat these procedures until the desired height is reached. (13 holes are available). Clamp the carriers by tightening the two clamping levers (Fig. 3, 1 + 2). Loosen the two clamping levers (fig. 3, 1 + 2). Insert the locking bolt into the upper hole (Fig. 5, 1). Lift the carrying hook with the upper securing bolt (Fig. 5, 3). Lift the height adjustment lever slightly to loosen the weight on the lower safety pin (Fig. 5, 2). Remove the lower securing pin (Fig. 5, 2) and carefully insert the upper securing pin (Fig. 5, 1) into the lower hole. Repeat these procedures until the desired height is reached. Clamp the carriers by tightening the two clamping levers (Fig. 3, 1 + 2). The entire height adjustment procedure must be performed simultaneously on both supports to ensure that the track remains horizontal.

Step 5: Position gantry crane: Release the parking brakes, roll the gantry crane to the desired position, and then lock the parking brakes on the rollers again. Secure the gantry crane additionally by fixing the rollers with wedges against slipping or rolling away!



## CAUTION!

Never move the gantry crane while it is under load!

Step 6: Make sure that the load chain and the load hook do not hang in a dangerous position.

Step 7: Insert the load hook into a suitable receptacle on the load (tested load-receiving means: eg carrier, chain, belt, eyelet).

Step 8: First only lift the load until the load chain is tensioned. Check the stability of the connections and the vertical alignment of the load chain (no lateral load!).

Step 9: Then lift the load to the desired height and drive it to the desired position with the carriage. Carefully release the load there.



## CAUTION DANGER OF CRUSHING!

When lowering the load there is a risk of crushing the upper and lower limbs.

## 9 Care, maintenance and repair

### 9.1 Care by cleaning

The Mobile gantry crane must always be kept in a clean condition.



**Use protective gloves!**



**NOTE!**

Never use strong cleaning agents to clean the device. Such cleaning agents might damage or destroy the device.

All plastic and lacquered surfaces should be cleaned using a soft, damp cloth and a neutral cleaning agent.

Remove any excess lubricant or leaked oil using a dry, lint-free cloth.

### 9.2 Maintenance



**DANGER!**

Maintenance and repair works must only be performed by specialists.

Step 1: Visual inspection:

Check the gantry crane for wear or defects before each use. The gantry crane must not be put into operation if wear or a defect is found.

Step 2: Regularly grease the locking bolts and bearings for the height adjustment levers with high quality grease and oil the roller bearings.

Step 3: Check the hooks and locking bolts for wear or defects and replace them if necessary.

Step 4: Make sure that all safety instructions on the gantry crane are clearly legible.

## 10 Checking the gantry crane

The gantry crane must be inspected for operational safety by a qualified person in accordance with the provisions of the German Ordinance on Industrial Safety and DGUV Rule 100-500, Chapter 2.8, before first use and as required at intervals of no more than 1 year. A person may be considered qualified if he / she has at least the qualification previously given to the expert. The scope of testing and the inspection deadlines are i.a. according to the results of the risk assessment to be carried out.

Type, extent and deadlines of the tests described in the DGUV Rule 100-500 are previous practice and comply with the rules of technology. The test is essentially a visual and functional test. It covers the examination of the condition of the components and equipment, the completeness and effectiveness of the safety equipment and the completeness of the test book. If a test period of no more than one year is adhered to, the operator can assume that this period is adequate. Verification of the gantry crane must be verified by a log book.



**DANGER!**

Observe the test regulations and safety instructions for the lifting equipment used with the gantry crane. Carefully read the appropriate sections in the instructions accompanying the lifting equipment!

## 11 Disposal, recycling of used devices

Please take care in your own interest and in the interest of the environment that all component parts of the machine are only disposed of in the intended and permitted way.

### 11.1 Decommissioning

Immediately decommission disused machines in order to avoid later misuse and endangering of the environment or personal safety.

Step 1: Eliminate all environmentally hazardous operating materials from the used device.

Step 2: If required, disassemble the machine into easy-to-handle and usable components and parts.

Step 3: Dispose of machine components and operating materials by the disposal channels provided.

## 12 Spare parts



### **DANGER!**

#### **Danger of injury by the use of wrong spare parts!**

Dangers may result for the user and damages as well as malfunctions may be caused by using wrong or damaged spare parts.

- Only use original spare parts of the manufacturer or spare parts admitted by the manufacturer.
- Always contact the manufacturer in case of uncertainties.

### 12.1 Ordering spare parts



#### **Tips and recommendations**

The manufacturer's warranty will become null and void if non-permissible spare parts are used

The spare parts may be purchased with the authorised dealer or directly with the manufacturer. Please find the corresponding contact data in Chapter 1.2 Customer service.

Indicate the following basic information for requests or orders of spare parts:

- Type of device
- Item No.
- Position No.
- Year of construction:
- Quantity
- Required mode of dispatch (mail, freight, sea, air, express)
- Address of dispatch

Spare part orders which do not include the above indications may not be taken into consideration. If the indications regarding the mode of dispatch are missing, the product is dispatched at the discretion of the supplier.

You will find information regarding the device type, item No. and year of manufacture on the type plate fixed to the Mobile gantry crane.

#### **Example**

The castor for the gantry crane PK1 must be ordered. The castor has the number 27 in the spare parts drawing 1.

By ordering spare parts, send a copy of the spare parts drawing (1) with the marked part (castor) and marked position number (27) to the dealer or spare parts department and provide the following information:

- Type of device: Gantry crane **PK 1**
- Item number: **6172100**
- Drawing number: **1**
- Position number: **27**

## 12.2 Spare parts drawing

In case of service, the following drawing shall help to identify the necessary spare parts. If necessary, send a copy of the parts drawing with the marked components to your authorised dealer.

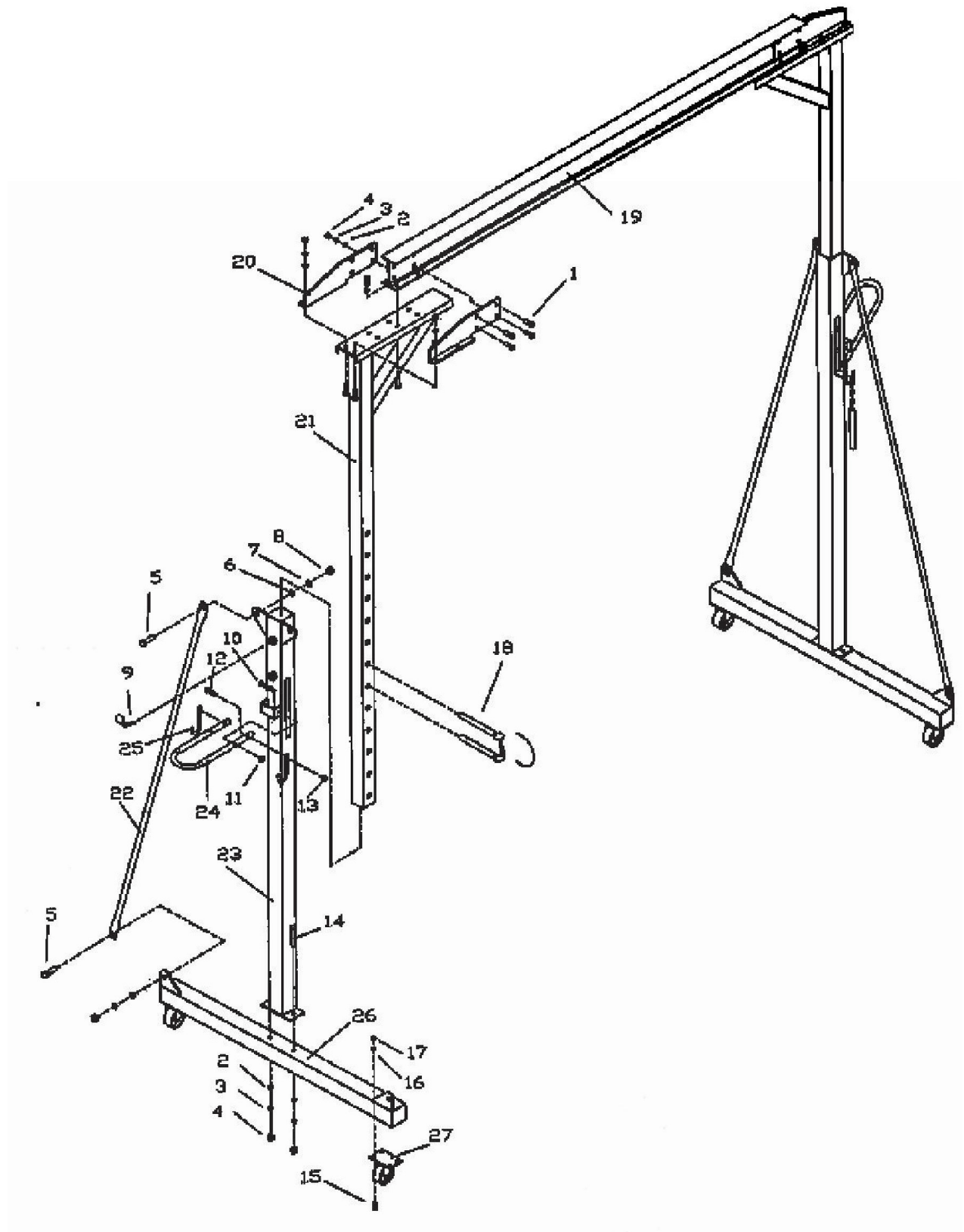

Fig. 8: Spare parts Drawing PK 1

## 13 EC Declaration of Conformity

According to machine directive 2006/42/EC Annex II 1.A

**Manufacturer/distributing company:** Stürmer Maschinen GmbH  
Dr.-Robert-Pfleger-Str. 26  
D-96103 Hallstadt

herewith declares that the following product

**Product group:** Unicraft® Werkstatttechnik

**Machine type:** Mobile gantry crane

**Designation of the machine:** PK 1

**Item number:** 6172100

**Serial number:** \_\_\_\_\_

**Year of manufacture:** 20\_\_\_\_

complies with all relevant provisions of the above mentioned directive as well as the other applied directives (below) - including their applicable modifications at the time of the declaration.

**The following harmonized standards were applied:**

DIN EN ISO 12100-1:2010      Safety of machinery - General principles for design -  
Risk assessment and risk reduction

DIN EN 15011:2014-09      Cranes - Bridge and gantry cranes;  
German version EN 15011:2011+A1:2014

**Responsible for documentation:** Kilian Stürmer, Stürmer Maschinen GmbH,  
Dr.-Robert-Pfleger-Str. 26, D-96103 Hallstadt

Hallstadt, 15.03.2017



Kilian Stürmer  
Manager



## 14 Notes



