

OWNER'S MANUAL

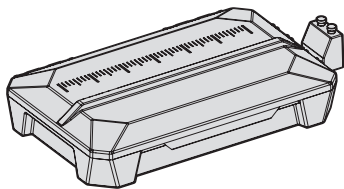

KPHA750 Pocket-Hole Jig Docking Station

For use with Kreg 500-Series and 700-Series Pocket-Hole Jigs

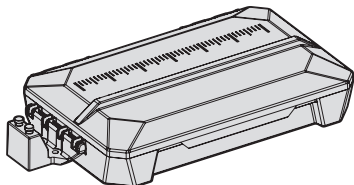
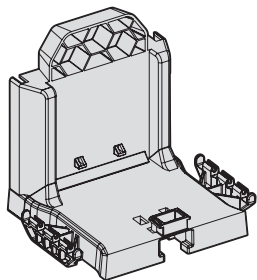

WARNING Every user must read and follow instructions and safety precautions in this manual. Failure to do so could result in serious injury. Save manual for future reference.

We're here to help.

We want you to have an exceptional project building experience. If you have questions or need support, please get in touch.
1-800-447-8638 | technicalsupport@kregtool.com

Tell us about your experience.

Your opinion counts. And we're always looking for ways to improve. Share your feedback so we can keep growing and innovating for you.
www.kregtool.com/feedback

English	2
French (N. America)	19
Spanish (N. America)	37
French	55
Spanish	73
German	91

Table of Contents

Safety Precautions	2	Operation - Folding the Material Support Wings	12
Pre-Assembly	3	Operation - Using the Adjustable Stop . . .	13
Recommended Tools (Not Included) . . .	3	Removing the Jig from the Docking Station.	15
Product Description	3	Care and Cleaning	16
Assembly: For 500-Series Jig	4		
Assembly: For 700-Series Jig	7		
Assembly: Adjustable Stop.	10		

Safety Precautions

WARNING Before using a power tool with this product, read and follow the tool manufacturer's instructions and safety precautions in addition to the safety precautions below to reduce the risk of serious injury from hazards such as fire, electric shock, or rotating drill bit.

- Always wear personal protective equipment recommended by the manufacturer of the power tool you are using, such as eye, hearing, or respiratory protection.
- The drill bit is sharp. Handle with care.
- Do not allow familiarity gained from frequent use of your tools to replace safe work practices. A moment of carelessness is sufficient to cause serious injury.
- Avoid awkward hand positions where a sudden slip could cause contact with the rotating bit.
- When drilling, always ensure workpiece is clamped securely. It is dangerous to hold workpiece in place by hand.

WARNING Do not operate this tool or any machinery while under the influence of drugs, alcohol, or medications.

WARNING This product can expose you to chemicals including Acrylonitrile and other chemicals, which are known to the State of California to cause cancer and reproductive harm. For more information go to www.P65Warnings.ca.gov.

Pre-Assembly

Review this section before you begin. Ensure that you have all tools and materials on hand. Compare the package with the items listed in the Recommended Tools and Product Description sections. If any item is missing or lost, do not use this product. Contact Technical Support or return the product to the place of purchase.

Recommended Tools (Not Included)

Assembling dock for use with 500-Series Jig:

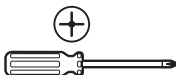

#2 Phillips screwdriver

Assembling dock for use with 700-Series Jig:

No tools are required.

Product Description

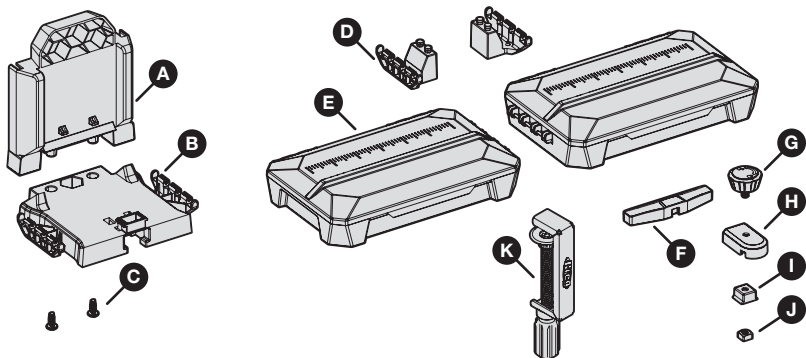

Part	Description
A	Dock-base back for 500-Series Jig
B	Dock-base platform for 500-Series Jig
C	Dock-base screws (2) for 500-Series Jig
D	Dock adapters for 700-Series Jig (2)
E	Material support wings (2)

Part	Description
F	Adjustable stop arm
G	Adjustable stop knob
H	Adjustable stop base
I	Adjustable stop base wedge
J	Adjustable stop square nut
K	KPHA760 Pocket-hole jig clamp

Assembly: For 500-Series Jig

This section describes how to assemble the KPHA750 Pocket-Hole Jig Docking Station for use with a Kreg 500-Series Jig.

1 Assemble the Dock Base

- Remove the two screws (C) taped to the dock-base platform (B).
- Insert the dock-base back (A) into the dock-base platform (B):
 - The honeycomb side of the dock-base back (A) faces away from the dock-base platform (B).
 - The two connectors that protrude from the bottom of the dock-base back (A) fit into the corresponding holes in the dock-base platform (B).
- For each connector: Insert a screw (C) into the connector from the underside of the dock-base platform (B); then use a #2 Phillips screwdriver to tighten the screw (C).

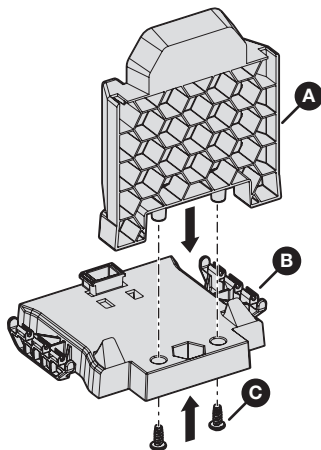

2 Connect the 500-Series Jig to the Dock Base

- Place the assembled dock base (1) on a flat surface.
- Slide the 500-Series Jig (2) onto the dock base until the jig (2) reaches the back of the assembled dock base (1) and snaps into position.

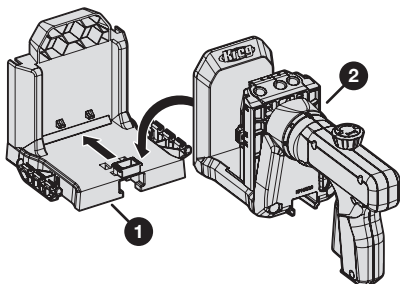

3 Connect the Material Support Wings to the Dock Base

Tip The material support wings also serve as storage boxes.

- Hold a material support wing (E) right-side up (so that the lid of the storage box is facing up and opens away from you).
- Align the connector (1) on the side of the material support wing (E) with the connector (2) on the side of the dock base; then press the material support wing (E) down firmly so that the connectors snap together.

Note The bars on the material-support-wing connector (1) snap into the grooves on the dock-base connector (2).

- Repeat these steps to connect the other material support wing (E) to the connector (2) on the opposite side of the dock base.

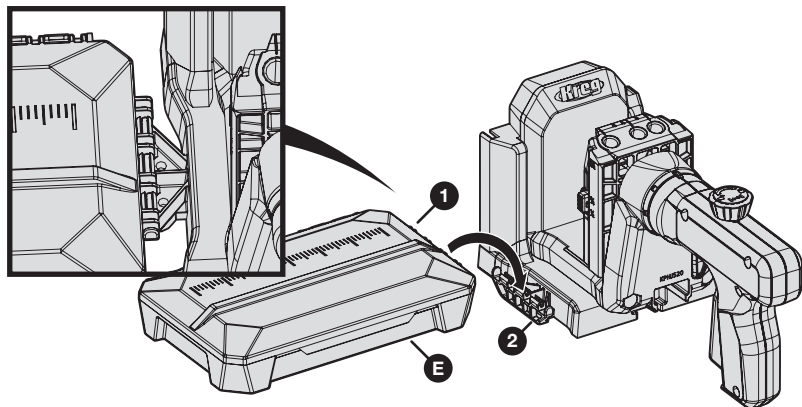

4 Optional: Mount the Dock Base to a Work Surface

If desired, you can mount the dock base to your work surface for added stability.

- Place the assembled docking station (with or without the 500-Series Jig attached) in the desired position on your workbench.
- Drive one Kreg pocket-hole screw (1) through each of the four mounting holes (2) in the dock-base platform (B).

Note You can use Kreg SML-C125 screws or any other Kreg pocket-hole screw.

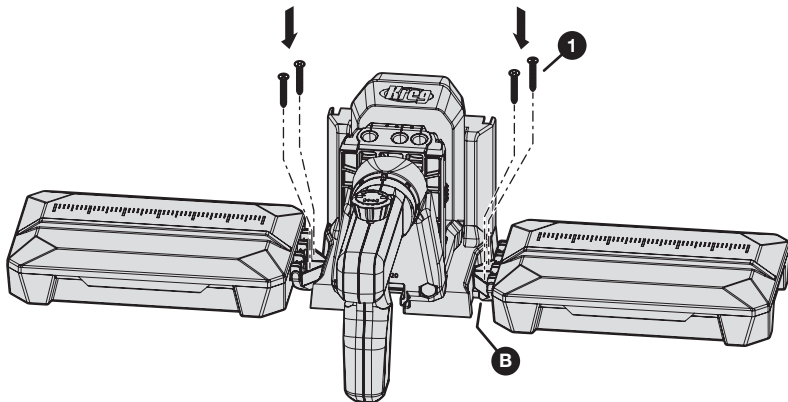
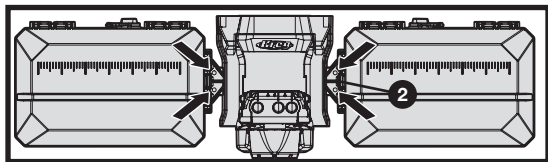

Assembly: For 700-Series Jig

This section describes how to assemble the KPHA750 Pocket-Hole Jig Docking Station for use with a Kreg 700-Series Jig.

1 Connect the Dock Adapters to the 700-Series Jig

- Place the 700-Series Jig on a flat surface.
- With one hand, lift one side of the 700-Series Jig slightly.
- With your other hand, place a dock adapter (D) under the jig so that the attachment pins (1) fit into the corresponding hole on the underside of the jig; then slide the dock adapter (D) toward the jig handle (3) to lock the dock adapter (D) into position.

Note One side of a dock adapter (D) has attachment pins (1) that fit under the jig; the other side has a connector (2) for a material support wing (not shown). Ensure that the wing-connector side (2) of the dock adapter (D) extends out from the side of the jig.

- Repeat steps b and c to connect the other dock adapter (D) on the opposite side of the jig.

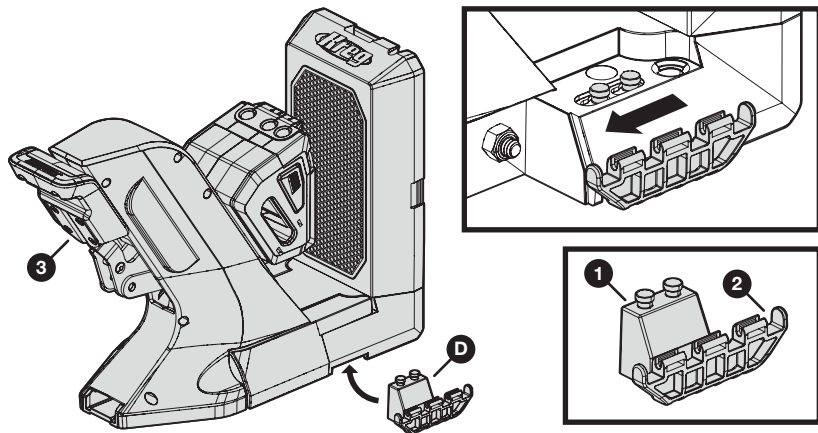

2 Connect the Material Support Wings to the Dock Adapters

Tip The material support wings also serve as storage boxes.

- Hold a material support wing (E) right-side up (so that the lid of the storage box is facing up and opens away from you).
- Align the connector (1) on the side of the material support wing (E) with the connector (2) on the dock adapter (D) that extends from the side of the jig; then press the material support wing (E) down firmly so that the connectors snap together.

Note The bars on the material-support-wing connector (1) snap into the grooves on the dock-adapter connector (2).

- Repeat these steps to connect the other material support wing (E) to the dock adapter (D) on the opposite side of the jig.

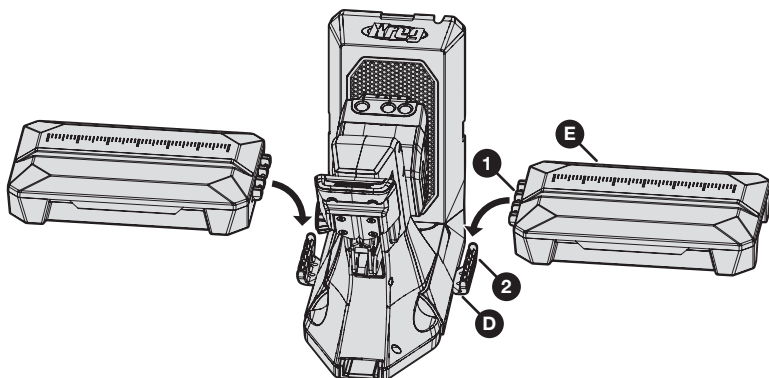

3 Optional: Mount the Dock Adapters to a Work Surface

If desired, you can mount the dock adapters to your work surface for added stability.

- Place the docking station (with the 700-Series Jig attached to it) in the desired position on your workbench.
- Drive one Kreg pocket-hole screw (1) through each of the four mounting holes (2) in the dock adapters (D).

Note You can use Kreg SML-C125 screws or any other Kreg pocket-hole screw.

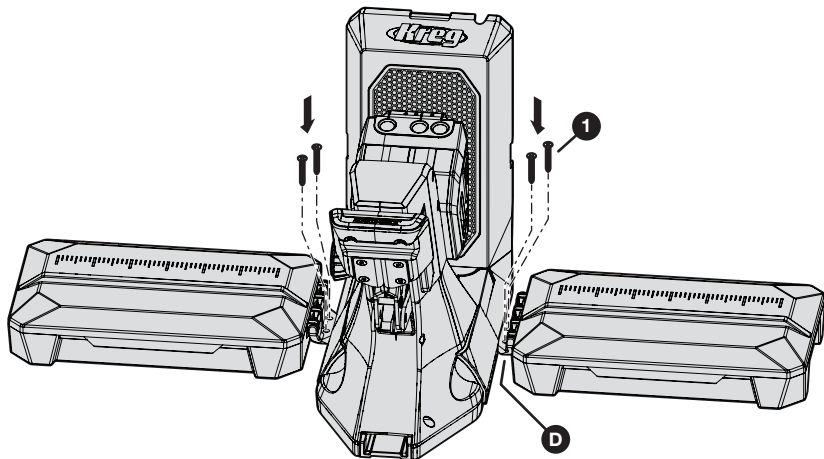
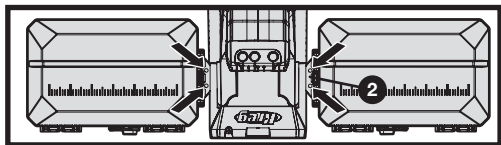

Assembly: Adjustable Stop

The docking station includes an adjustable stop that can be attached to either material support wing. The adjustable stop makes it easy to achieve repeatable results when you have many pieces that require the same pocket-hole spacing.

Note The adjustable stop has two parts: the adjustable stop base, which you will assemble in step 1; and the adjustable stop arm, which can be attached to the adjustable stop base in different configurations (see step 2).

1 Assemble the Adjustable Stop Base

- Insert the screw (1) of the adjustable stop knob (G) into the hole on top of the adjustable stop base (H).
- Holding the adjustable stop knob (G) in position, turn the adjustable stop base (H) upside down so that the screw (1) extends upward.
- Drop the adjustable stop base wedge (I) onto the screw (1) with the flanged side of the adjustable stop base wedge (I) facing up.

Note The adjustable stop base wedge (I) should sit flush with the adjustable stop base (H). If it does not sit flush, rotate the adjustable stop base wedge (I) 90 degrees.

- Place the adjustable stop square nut (J) onto the screw (1); then rotate the adjustable stop knob (G) until the adjustable stop square nut (J) is finger-tight.

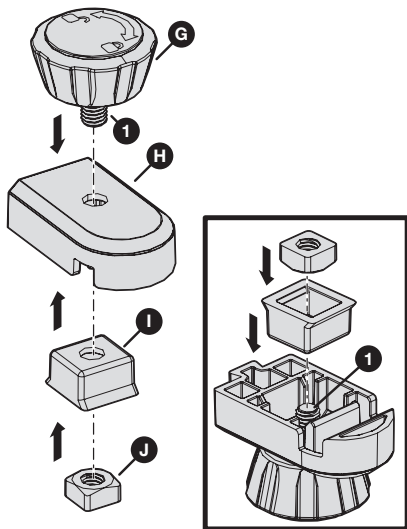

2 Attach the Adjustable Stop Arm to the Adjustable Stop Base

Slide a notch in the adjustable stop arm (F) down over the tab (1) on the adjustable stop base (H) until the adjustable stop arm (F) is fully seated on the tab (1).

Note The adjustable stop arm (F) has three notches: a center notch (2) on one side and two outer notches (3, 4) on the opposite side. Use the appropriate notch depending on how you want to configure the adjustable stop.

Note To change the configuration of the adjustable stop, lift the adjustable stop arm (F) off the adjustable stop base (H). Then slide a different notch of the adjustable stop arm (F) over the tab (1) on the adjustable stop base (H).

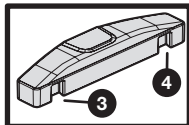
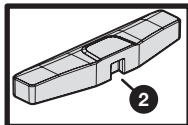
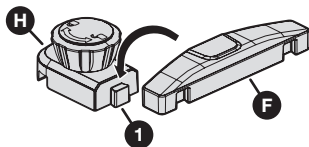

Centered Configuration

Use the arm's center notch (2)

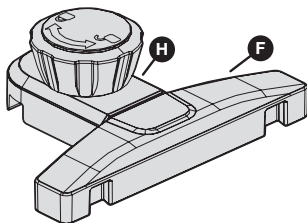

Side Configuration

Use either of the arm's outer notches (3, 4), so that the arm (F) extends to one side of the base (H)

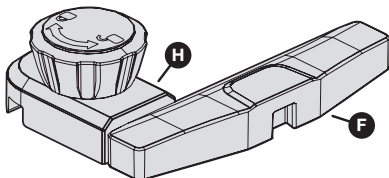

Operation - Folding the Material Support Wings

You can fold the material support wings up to the vertical position to save space when the jig is not in use, or to make it easier to move the jig from one location to another. Always fold the material support wings down before using the jig.

To fold up the material support wings:

- Fold the material support wing (E) up to a vertical position.
- Rotate the wing lock (1) inward until the latch (2) engages in the corresponding notch:
 - For a 500-Series Jig, the notch (3) is located on the side of the dock-base back (A).
 - For a 700-Series Jig, the notch (3) is located on the side of the jig.
- Repeat this process for the material support wing (E) on the opposite side of the jig.

To fold down the material support wings:

- Rotate the wing lock (1) outward until the latch (2) disengages from the notch:
 - For a 500-Series Jig, the notch (3) is located on the side of the dock base (A).
 - For a 700-Series Jig, the notch (3) is located on the side of the jig.
- Fold the material support wing (E) down to a horizontal position.
- Repeat this process for the material support wing (E) on the opposite side of the jig.

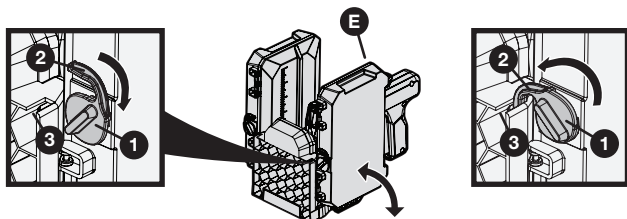

Folding the material support wings on a 500-Series Jig

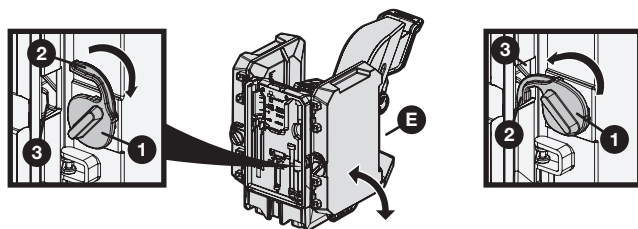

Folding the material support wings on a 700-Series Jig

Operation - Using the Adjustable Stop

The adjustable stop enables you to drill pocket holes on similar workpieces at a faster pace.

Note The adjustable stop requires assembly. See **Assembly: Adjustable Stop** on page 10.

1 Set Up the Adjustable Stop

If necessary, change the configuration of the adjustable stop to accommodate the size and orientation of your workpiece in the jig:

- **Wide workpiece:** If the workpiece is wide enough to extend onto the top of a material support wing (E), use the adjustable stop (1) in its *centered* configuration.
- **Narrow workpiece:** If the workpiece does not extend across the gap between the jig and the material support wing (E), use the adjustable stop (1) in a *side* configuration.

Note For a side configuration, use whichever outer notch in the adjustable stop arm will be farther from the jig after you place the adjustable stop (1) onto a material support wing (E).

Note For instructions on changing the configuration, see **Attach the Adjustable Stop Arm to the Adjustable Stop Base** on page 11.

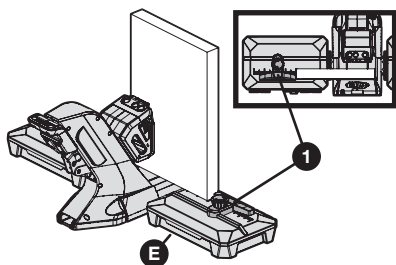

Adjustable stop (1) in centered configuration for wide workpiece

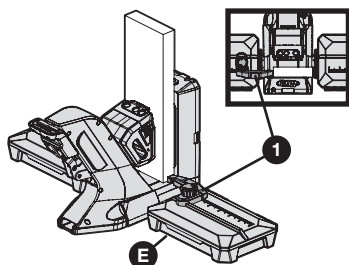

Adjustable stop (1) in side configuration for narrow workpiece

2 Place the Adjustable Stop in Position

- a. With the adjustable stop (1) configured the way you want it, place the adjustable stop (1) onto the lid of a material support wing (E) so that:
 - The edge of the adjustable stop arm (F) rests snugly against the workpiece.
 - The notch (2) on the underside of the adjustable stop base fits over the rail (3) that runs across the lid of the material support wing (E).
- b. Rotate the adjustable stop knob (G) clockwise until tight to secure the adjustable stop (1) in position.

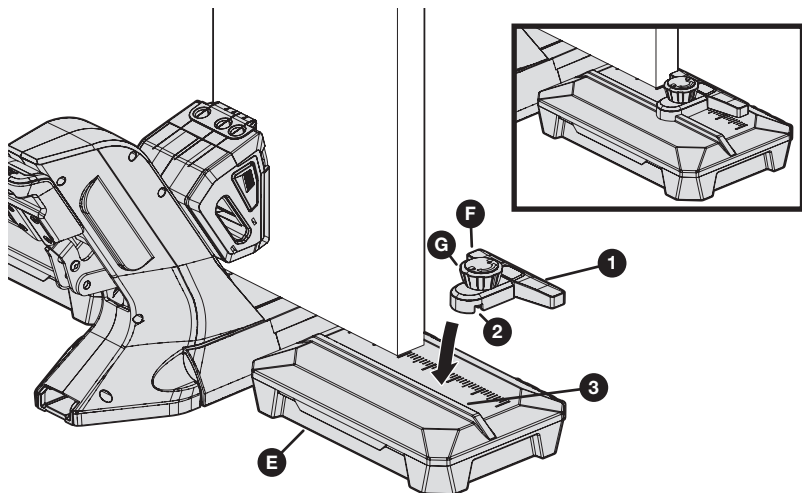

Note To reposition or remove the adjustable stop (1), rotate the adjustable stop knob (G) counterclockwise to loosen it. Then slide the adjustable stop (1) to a new position along the rail (3) or lift it off of the material support wing (E).

Removing the Jig from the Docking Station

If you want to use the jig without the docking station, you can remove it from the docking station.

Removing a Kreg 500-Series Jig

Grasp the jig (1) firmly and pull it toward you to slide it off the dock base (2).

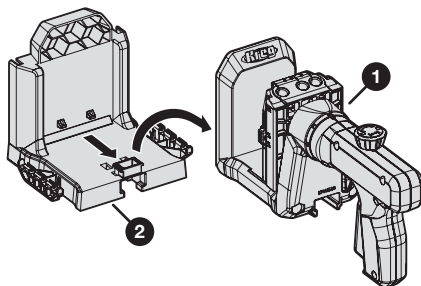

Removing a Kreg 700-Series Jig from a Mounted Docking Station

With the jig handle (3) facing you, slide the jig toward you until the jig disengages from the dock adapters (D). Then lift the jig off the dock adapters (D).

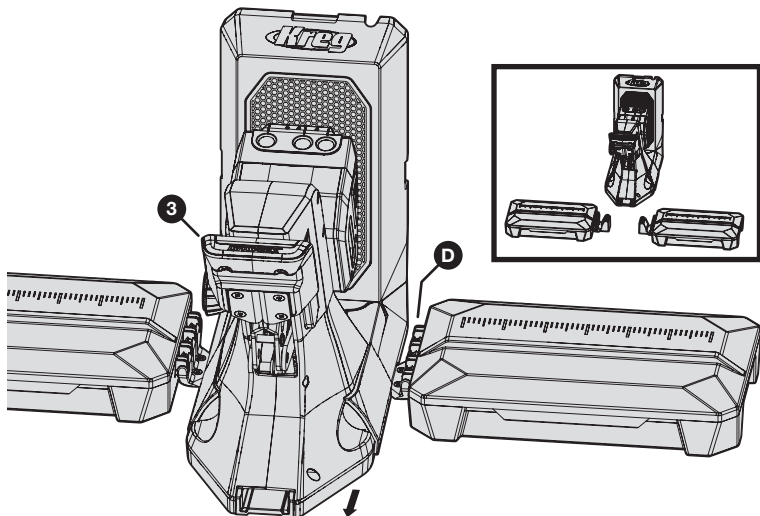

Removing a Kreg 700-Series Jig from an Unmounted Docking Station

- a. Detach each material support wing (E):
 1. Grasp the material support wing (E) close to where it connects to the dock adapter (D).
 2. Gently lift up the material support wing (E) so that the material-support-wing connector (5) pops out of the dock-adapter connector (6).
- b. Remove the dock adapter (D) from each side of the jig:
 1. Lift that side of the jig slightly off the work surface.
 2. With the jig handle (3) facing you, slide the dock adapter (D) away from you until the dock adapter (D) disengages from the slot on the underside of the jig.
 3. Pull the dock adapter (D) out from the underside of the jig.

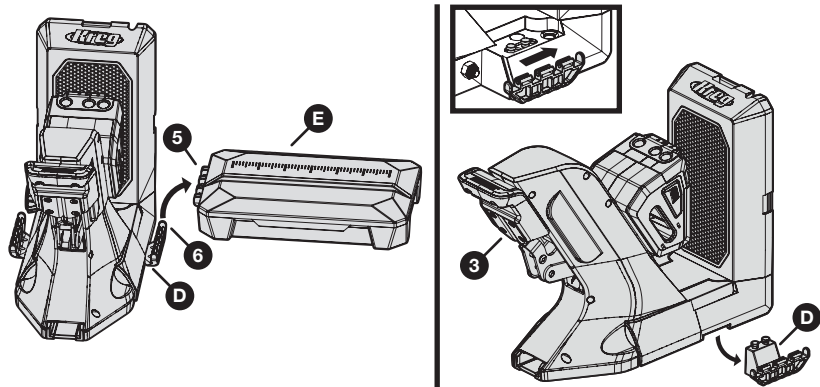

Care and Cleaning

Periodically clean the dock by vacuuming any chips and wood dust.

Use a damp cloth to wipe SureGrip™ anti-slip pad surfaces clean of dust and debris.



EXPLORE. BUILD. SHARE.

We're makers just like you.

That's why we love to see what you're working on.

Share with the community and get inspired!

#madewithKreg

Get free plans, project resources, and more.

kregtool.com and buildsomething.com