



HOLZMANN MASCHINEN GmbH

Marktplatz 4 · A-4170 Haslach

Tel. +43 7289 71 562-0

info@holzmann-maschinen.at

www.holzmann-maschinen.at

Originalfassung

DE BETRIEBSANLEITUNG

Übersetzung / Translation

EN USER MANUAL

OSZ. SPINDELSCHLEIFMASCHINE

OSCILLATING SPINDLE SANDER



OSS75A_230V

CE
YOUR
JOB.
OUR
TOOLS.



3 TECHNIK / TECHNICS

3.1 Lieferumfang / Delivery content

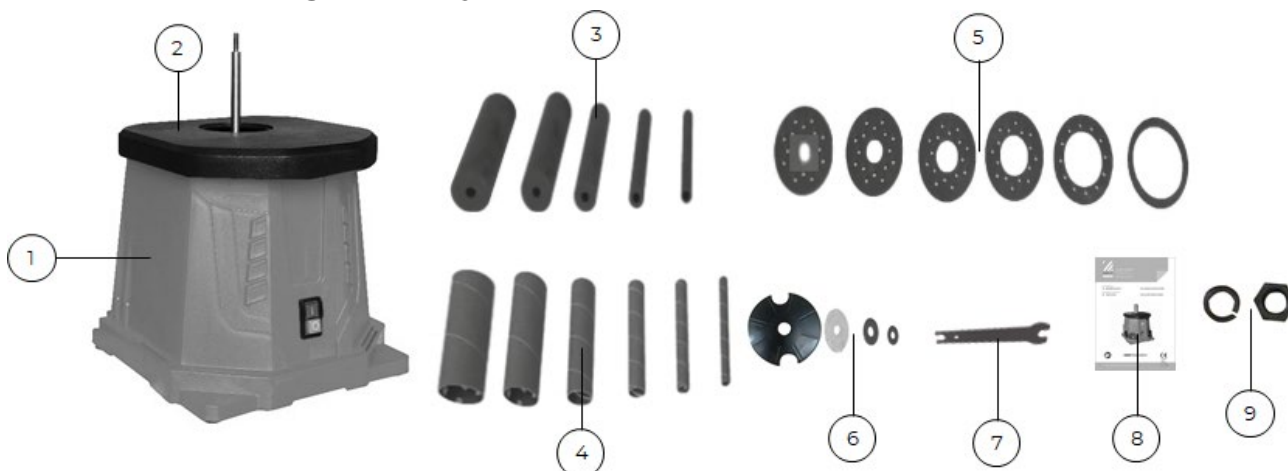

#	Beschreibung / Description	Qty
1	Maschine / machine	1
2	Aluminiumgussarbeitstisch / aluminium cast worktable	1
3	Gummischleifwalze / rubber sanding roll	Ø 19/26/38/51/76 x 115mm
4	Schleifhülsen-AußenØ / sanding sleeves diameter	K80; Ø 15/21/28/40/53/78 mm
	Schleifhülsen-InnenØ / sanding sleeves diameter	K80; Ø 13/19/26/38/51/76 mm
5	Tischeinlagen / table inlays	Ø 18/25/31/44/57/82 mm
6	Spindelscheiben / spindle discs	Ø 14/24/44/71 mm
7	Montageschlüssel / wrench	1
8	Betriebsanleitung / user manual	1
9	Mutter + Federring / nut + spring washer	1

3.2 Komponenten / Components

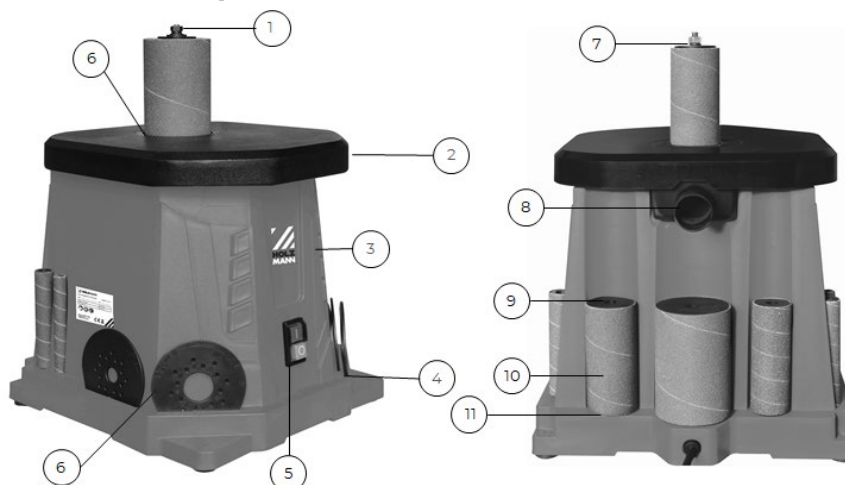

	Beschreibung / Description		Beschreibung / Description
1	Spindel / spindle	7	Spindelscheibe / spindle disc
2	Aluminiumgusstisch / aluminium cast table	8	Absauganschluss / dust collector plug
3	Gehäuse / housing	9	Gummischleifwalze / rubber sanding roll
4	Ablage für Tischeinlagen / table inlay slot	10	Schleifhülsen / sanding sleeves
5	Ein-Aus-Schalter / ON-OFF switch	11	Steckplatz Schleifwalzen / sanding roll slot
6	Tischeinlagen / table inlays		



3.3 Technische Daten / Technical data

Spezifikation / Specification	
Spannung / voltage	230 V / 50 Hz
Motorleistung S1 (100 %) / motor power S1 (100 %)	450 W
Leerlaufdrehzahl / no-load speed	2000 min ⁻¹
Oszillationen pro Minute / oscillations per minute	58
Oszillationshub / oscillation stroke	16 mm
Spindeldurchmesser / spindle diameter	Ø 12,7 mm
Spindelhöhe / spindle height	115 mm
Schleifhülsen / sanding sleeves	Ø 15/21/28/40/53/78 mm
max. Schleifhöhe / max. sanding height	98 mm
Tischgröße / table size	320 x 300 mm
Absauganschluss / dust collector plug	Ø 39 mm
Maschinenmaße (LxBxH) / machine dimensions (LxWxH)	400 x 365 x 440 mm
Verpackungsmaße (LxBxH) / packaging dimensions (LxWxH)	465 x 400 x 495 mm
Gewicht Brutto / weight gross	10,6 kg
Gewicht Netto / weight net	9 kg
Schallleistungspegel L _{WA} / sound power level L _{WA}	109,8 dB(A).....k: 3 dB(A)
Schalldruckpegel L _{PA} / sound pressure level L _{PA}	96,8 dB(A).....k: 3 dB(A)

(DE) Hinweis Geräuschangaben: Die angegebenen Werte sind Emissionswerte und müssen damit nicht zugleich auch sichere Arbeitsplatzwerte darstellen. Obwohl es eine Korrelation zwischen Emissions- und Immissionspegeln gibt, kann daraus nicht zuverlässig abgeleitet werden, ob zusätzliche Vorsichtsmaßnahmen notwendig sind oder nicht. Faktoren, welche den am Arbeitsplatz tatsächlich vorhandenen Immissionspegel beeinflussen, beinhalten die Eigenart des Arbeitsraumes und andere Geräuschquellen, d. h. die Zahl der Maschinen und anderer benachbarter Arbeitsvorgänge. Die zulässigen Arbeitsplatzwerte können ebenso von Land zu Land variieren. Diese Information soll jedoch den Anwender befähigen, eine bessere Abschätzung von Gefährdung und Risiko vorzunehmen.

(EN) Notice noise emission: The values given are emission values and therefore do not have to represent safe workplace values at the same time. Although there is a correlation between emission and immission levels, it cannot be reliably deduced whether additional precautions are necessary or not. Factors influencing the actual immission level at the workplace include the nature of the workspace and other noise sources, i.e. the number of machines and other adjacent operations. The permissible workplace values may also vary from country to country. However, this information should enable the user to make a better assessment of hazard and risk.



10 PREFACE (EN)

Dear Customer!

This manual contains information and important notes for safe commissioning and handling of the OSCILLATING SPINDLE SANDER OSS75A_230V, hereinafter referred to as “machine” in this document.



This manual is part of the machine and must not be removed. Save it for later reference and if you let other people use the machine, add this manual to the machine.

Please read and note the safety instructions!

Before first use read this manual carefully. It eases the correct use of the machine and prevents misunderstanding and damages of machine.

Due to constant advancements in product design, construction, illustrations and contents may deviate slightly. If you notice any errors, please inform us.

We reserve the right to make technical changes!

Check the goods immediately after receipt and note any complaints on the consignment note when taking over the goods from the deliverer!

Transport damage must be reported to us separately to us within 24 hours.

HOLZMANN MASCHINEN GmbH cannot accept any liability for transport damage that has not been reported.

Copyright

© 2022

This documentation is protected by copyright. All rights reserved! In particular, the reprint, translation and extraction of photos and illustrations will be prosecuted.

The place of jurisdiction is the regional court Linz or the court responsible for 4170 Haslach is valid.

Customer service contact

HOLZMANN MASCHINEN GmbH

4170 Haslach, Marktplatz 4
AUSTRIA

Tel +43 7289 71562 - 0
info@holzmann-maschinen.at



11 SAFETY

This section contains information and important notes on the safe commissioning and handling of the machine.



For your safety, read this manual carefully before commissioning. This will enable you to handle the machine safely and thus prevent misunderstandings as well as personal injury and damage to property. Pay special attention to the symbols and pictograms used on the machine as well as the safety information and danger warnings!

11.1 Intended use of the machine

The machine is designed exclusively for the following activities:

Sanding wood, wood composites or materials with similar physical properties to wood, within the prescribed technical limits.

NOTE



HOLZMANN MASCHINEN GmbH assumes no responsibility or warranty for any other use or use beyond this and for any resulting damage to property or injury.

11.1.1 Technical restrictions

The machine is designed for the work under the following conditions:

Relative humidity	max. 70 %
Temperature (operation)	+5 °C to +40 °C
Temperature (storage, transport)	-25 °C to +55 °C

11.1.2 Prohibited applications / Dangerous misuse

- Operating the machine outdoors.
- Operating the machine without adequate physical and mental fitness.
- Operating the machine without knowledge of the manual.
- Modifying the machine design.
- Operating the machine outside the technical limits specified in this manual.
- Removing of the safety markings attached to the machine.
- Modifying, circumventing or disabling the safety devices of the machine.

The non-intended use or the disregard of the explanations and instructions described in this manual will result in the expiration of all warranty claims and compensation claims for damages against HOLZMANN MASCHINEN GmbH.

11.2 User requirements

The machine is designed to be operated by one person. The prerequisites for operating the machine are physical and mental fitness as well as knowledge and understanding of the operating instructions. Persons who, due to their physical, sensory or mental capabilities, inexperience or lack of knowledge, are unable to operate the machine safely must not use the machine without supervision or instruction by a responsible person.

Please note that locally applicable laws and regulations determine the minimum age of the operator and may restrict the use of this machine!

Work on electrical components or equipment may only be carried out by a qualified electrician or under the guidance and supervision of a qualified electrician.

Put on your personal protective equipment before working on the machine.



11.3 General safety instructions

To avoid malfunctions, damage and health impairments when working with the machine, the following points must be observed in addition to the general rules for safe working:

- Check the machine for completeness and function before starting.
- Select a level, vibration-free surface as the installation area.
- Ensure sufficient space around the machine.
- Ensure sufficient lighting conditions at the workplace to avoid stroboscopic effects.
- Ensure a clean working environment.
- Keep the area around the machine free of obstacles (e.g. dust, chips, cut-off workpiece parts, etc.).
- Only use tools that are in perfect condition and free of cracks and other defects (e.g. deformations).
- Remove tool keys and other setting tools before switching on the machine.
- Never leave the running machine unattended. Switch off the machine before leaving the working area and secure it against unintentional or unauthorized restarting.
- The machine may only be operated, maintained or repaired by persons who are familiar and who have been informed about the dangers arising from this work.
- Ensure that unauthorized persons keep a safety distance from the machine and keep children away from the machine.
- Always work with care and the necessary caution and never use excessive force.
- Do not overload the machine.
- Hide long hair under hair protection.
- Wear close fitting protective work clothing and suitable protective equipment (eye protection, dust mask).
- Never wear loose jewellery, loose clothing or accessories (e.g. tie, scarf).
- Do not work on the machine if you are tired, not concentrated or under the influence of medication, alcohol or drugs!
- Connect the machine to a suitable dust collection system.
- Do not use the machine in areas where vapours of paints, solvents or flammable liquids represent a potential danger (danger of fire or explosion!).
- Shut down the machine and disconnect it from the power supply, before adjustment, changeover, cleaning, maintenance or repair work, etc. Before starting work on the machine, wait until all tools or machine parts have come to a complete standstill and secure the machine against unintentional restart.

11.4 Electrical safety

- Only use suitable extension cables.
- A damaged or tangled cable increases the risk of electric shock. Handle the cable with care. Never use the cable to carry, pull or disconnect the power tool. Keep the cable away from heat, oil, sharp edges or moving parts.
- Proper plugs and outlets reduce the risk of electric shock.
- Water entry into the machine increases the risk of electric shock. Do not expose the machine to rain or moisture.
- The machine may only be used if the power supply is protected by a residual current circuit breaker.
- Use the machine only when the ON-OFF switch is in good working order.

11.5 Special safety instructions for this machine

- Never touch a moving sanding tool.
- Do not use the machine if the sanding tool is damaged
- Keep the ventilation slots on the housing clear to prevent the motor from overheating.
- Never sand an unsupported workpiece. Secure the workpiece with the table or a fence.

11.6 Hazard warnings

11.6.1 Residual risks

Despite intended use, certain residual risk factors remain.

- Risk of injury to hands/fingers from moving sanding tool during operation.



11.6.2 Hazardous situations

Due to the structure and construction of the machine, hazardous situations may occur which are identified in this manual as follows:

DANGER



A safety instruction designed in this way indicates an imminently hazardous situation which, if not avoided, will result in death or serious injury.

WARNING



A safety instruction designed in this way indicates a potentially hazardous situation which, if not avoided, could result in death or serious injury.

CAUTION



A safety instruction designed in this way indicates a possibly hazardous situation which, if not avoided, may result in minor or moderate injury.

NOTE



A safety notice designed in this way indicates a potentially hazardous situation which, if not avoided, may result in property damage.

Regardless of all safety regulations, your common sense and your appropriate technical aptitude/training are and remain the most important safety factor in the error-free operation of the machine. **Safe working depends on you!**

12 ASSEMBLY

12.1 Preparation

12.1.1 Check delivery content

Check the delivery immediately for transport damage and missing parts. Report any damage or missing parts to your dealer or the shipping company immediately. Visible transport damage must also be noted immediately on the delivery note in accordance with the provisions of the warranty, otherwise the goods are deemed to have been properly accepted.

12.1.2 Requirements for the installation site

The selected installation site must ensure a suitable connection to the power supply, as well as (e.g.) connection to an extraction system. Observe the safety requirements and the dimensions of the machine.

The base of the machine has fixing holes by means of which the machine is firmly connected to a workbench or machine table. This prevents movement of the machine during operation and possible damage or injury.

NOTE



Required mounting material is not included in the scope of delivery.



12.2 Assemble / changing sanding tool

The machine has been disassembled for transport and must be reassembled before use. Follow the instructions below:

WARNING



Danger due to electrical voltage!

Handling the machine with connected power supply may result in serious injury or death.

- Always disconnect the machine from the power supply before carrying out any modification or adjustment work and secure it against unintentional reconnection.

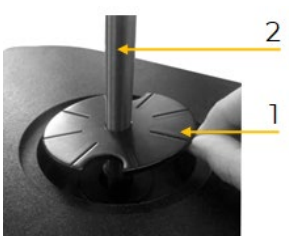
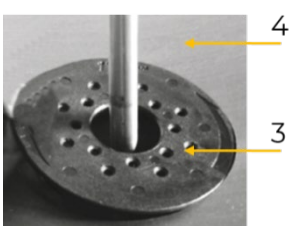
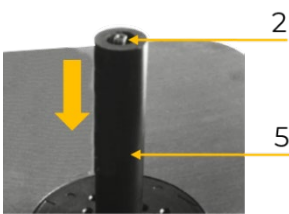
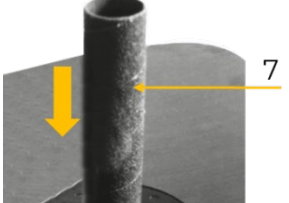
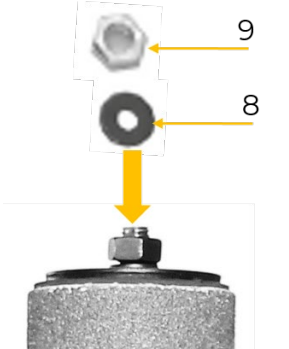
	<p>1. Slide the lower spindle disc (1) over the spindle (2) and place it in the recess of the table inlay.</p>
	<p>2. Insert table inlay (3) into the table (4)</p>
	<p>3. Push the rubber sanding roll (5) onto the spindle (2)</p>
	<p>4. Push the sanding sleeve (7) onto the rubber sanding roll</p> <p>NOTE: The sanding sleeve with Ø 15mm is mount directly onto the spindle!</p>
	<p>5. Put on the spindle disc (8) with the correct dimension and spindle nut (9).</p>

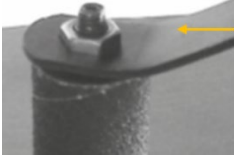
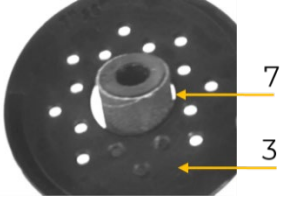

	6. Tighten the spindle nut with the wrench (10)	
	NOTE: When changing the sanding sleeves, always use the matching parts (see table). The table inlays (3) must always be larger than the grinding sleeves (7)!	
Sanding sleeve Ø	Table inlay inside-Ø	Ø Spindle disc
15 mm	18 mm	small 14 mm
21 mm	25 mm	small 14 mm
28 mm	31 mm	medium 24 mm
40 mm	44 mm	medium 24 mm
53 mm	57 mm	large 44 mm
78 mm	82 mm	large 44 mm

13 OPERATION

Only operate the machine when it is in a perfect condition. Before each operation, a visual inspection of the machine must be carried out. Power cord and operating elements must be checked carefully. Check screw connections for damage and tight fit.

13.1 Operating instructions

- Before switching on the machine check the faultlessly move of the spindle
- Never start the machine with a workpiece pressed down

13.2 Handling

- Switch on the machine.
- Once the machine has reached its maximum speed you may start sanding process.
- Move the work piece slowly in the direction contrary to the running direction of the sanding roll.
- Do not overload the machine by too much pressure against the sanding roll.
- After finishing the sanding process switch off the machine and disconnect from power supply.

13.2.1 Switch the machine on and off

	<p>Switch on Press the green switch-on button (I).</p> <p>Switch off Press the red switch-off (O)</p>
---	---



14 CLEANING, MAINTENANCE, STORAGE, DISPOSAL

WARNING

**Danger due to electrical voltage!**

Handling the machine with connected power supply may result in serious injury or death.

- Always disconnect the machine from the power supply before cleaning, maintenance or repair work and secure it against unintentional reconnection.

14.1 Cleaning

NOTE



Incorrect cleaning products can attack the finish of the machine. Do not use any solvents, nitro thinners or other cleaning products that could damage the machine's finish.

Observe the specifications and instructions of the cleaning agent manufacturer.

Regular cleaning is a prerequisite for the safe operation of the machine and its long service life. Keep the surfaces and ventilation slots of the machine free of dust and dirt. For cleaning, use a soft cloth and a mild soap solution and, if necessary, a damp-free jet of compressed air.

14.2 Maintenance

The machine is low-maintenance and only a few parts have to be serviced. Nevertheless, malfunctions or defects which could impair the safety of the user must be rectified immediately!

- Regularly check that the safety devices on the machine are in perfect and functional condition.
- Only use perfect and suitable tools.
- Only use original spare parts recommended by the manufacturer.

14.2.1 Maintenance plan

The type and degree of machine wear depends to a large extent on the operating conditions. The following intervals apply when the machine is used within the technical limits:

Interval	Components	Action
before usage	• Sanding tool	• Check and replace, if damaged.
	• Power cord	
Each time after completion of work	• Surfaces	• Remove dust and dirt
	• Air vents	
if required	• Sanding tool	• Replace

14.3 Storage

Store the machine in a dry, frost-proof and lockable place when not in use. Disconnect the machine from the power supply. Make sure that unauthorised persons and especially children do not have access to the machine.

NOTE



Improper storage can damage and destroy important components. Only store packed or already unpacked parts under the intended ambient conditions!



14.4 Disposal



Observe the national waste disposal regulations. Never dispose of the machine, machine components or operating equipment in the residual waste. If necessary, contact your local authorities for information regarding available disposal options.

If you purchase a new machine or equivalent equipment from your specialist dealer, he is obliged in certain countries to dispose of your old machine properly.

15 TROUBLESHOOTING

WARNING



Danger due to electrical voltage!

Handling the machine with connected power supply may result in serious injury or death.

- Always disconnect the machine from the power supply before maintenance or repair work and secure it against unintentional reconnection.

Many possible sources of error can be eliminated in advance if the machine is properly connected to the power supply.

If you are unable to carry out the necessary repairs properly and/or do not have the required training, always consult a specialist to solve the problem.

Trouble	Possible cause	Solution
Machine does not run	• ON-OFF switch defective	• Repair/replace switch
	• Fuse defective	• Replace fuse
	• Motor defective	• Repair/replace motor
	• Power cord damaged	• Replace power cord
Machine slows down during working	• Too much pressure put on the workpiece	• Reduce the pressure on the workpiece
Work piece burns during the working process	• Sanding tool covered with grease	• Replace sanding tool
	• Excessive pressure on workpiece	• Reduce the pressure
Strong vibrations	• Loosely sanding tool	• Tighten sanding tool
	• Sanding tool defective	• Replace sanding tool
	• Spindle knocks	• Repair/replace spindle
	• Loosely machine	• Refix machine



Motor

red

white

current plate

blue

brown

yellow/green

K_c

power cord

yellow/green

K_c : electromagnetic switch



17.2 Explosionszeichnung / Exploded view

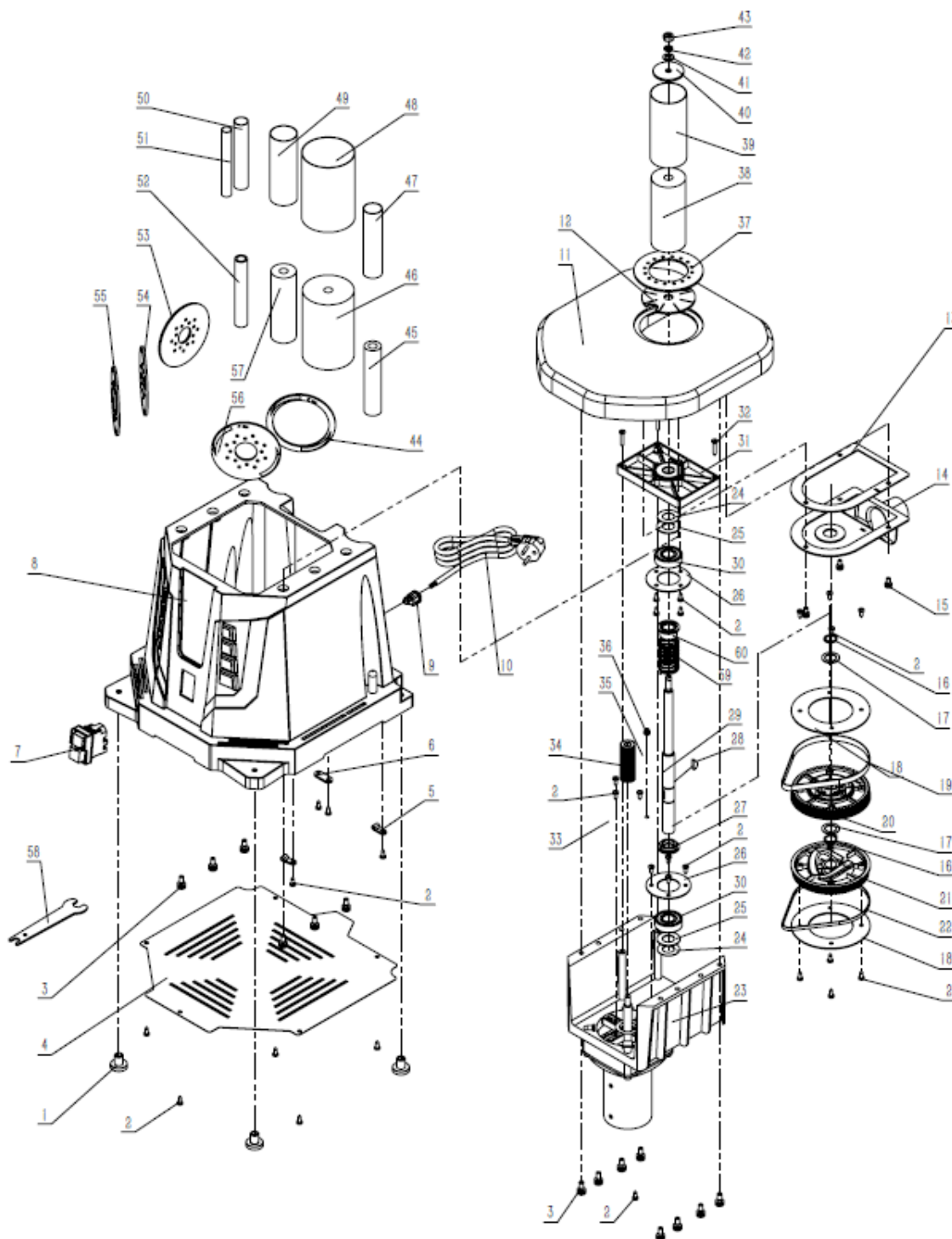

17.3 Ersatzteilliste / Spare part list

No.	Description	Qty	No.	Description	Qty
1	Foot	4	31	Backpanels	1
2	Cross recessed pan head tapping screws ST4.2x12	29	32	Cross recessed pan head tapping screws	4
3	Cross recessed pan head screw + spring washer + flat washer M6x16	14	33	Tension frame assembly	1
4	Baseplate	1	34	Motor wheel	1



5	Install wire fixing button	2	35	Tension wheel assembly	1
6	Cable joint	1	36	Hexagon lock nuts M5	1
7	Switch	1	37	Work table plate	1
8	Base	1	38	Sand cylinder roller	1
9	Ply-yarn drill	1	39	Sand cylinder	1
10	Power cord	1	40	Sand cylinder pressing plate	1
11	Work table	1	41	Washer 8	1
12	Sand cylinder plate	1	42	Spring washer 8	1
13	Washer	1	43	Hexagon nuts M8	1
14	Dust port	1	44	Work table plate	1
15	Cross recessed pan head screw + spring washer + flat washer M5x12	3	45	Sand cylinder roller	1
16	Circlip for shaft 17	2	46	Sand cylinder roller	1
17	Spring plate	2	47	Sand cylinder	1
18	Belt wheel clamp	2	48	Sand cylinder	1
19	Synchronous toothed belt 160 XL (wide 10mm)	1	49	Sand cylinder	1
20	Synchronous pulley 70T	1	50	Sand cylinder	1
21	Synchronous pulley 69T	1	51	Sand cylinder	1
22	Synchronous toothed belt 160 XL (wide 6mm)	1	52	Sand cylinder roller	1
23	Motor	1	53	Work table plate	1
24	Rubber blanket	2	54	Work table plate	1
25	Felt pad	2	55	Work table plate	1
26	Binder plate	2	56	Work table plate	1
27	Axle sleeve	1	57	Sand cylinder roller	1
28	Half round key 5x6,5	1	58	Wrench	1
29	Shaft	1	59	Spring	1
30	Deep groove ball bearing 6203-2RZ	2	60	Shaft sleeve	1

18 ZUBEHÖR / ACCESSORIES

(DE) Optionales Zubehör finden Sie online auf der Produktseite, Kategorie EMPFOHLENES ZUBEHÖR ZUM PRODUKT.

(EN) Optional accessories can be found online on the product page, category RECOMMENDED PRODUCT ACCESSORIES.