

de	Originalbetriebsanleitung	8	nl	Originele gebruiksaanwijzing	40
en	Original instructions	10	pl	Oryginalna instrukcja obsługi	42
fr	Notice d'utilisation d'origine	12	pt	Manual de instruções original	44
es	Manual de instrucciones original	14	ro	Manualul de utilizare original	46
bg	Оригинална инструкция за експлоатация	16	sk	Originálny návod na obsluhu	48
cs	Původní návod k obsluze	18	sl	Originalna navodila za uporabo	50
da	Original brugsanvisning	20	sv	Originalbruksanvisning	52
el	Πρωτότυπο οδηγιών χρήσης	22			
et	Originaalkasutusjuhend	24			
fi	Alkuperäiset käyttöohjeet	26			
hr	Originalne upute za uporabu	28			
hu	Eredeti használati utasítás	30			
it	Istruzioni d'esercizio originali	32			
lt	Originali naudojimo instrukcija	34			
lv	Originālā lietošanas pamācība	36			
nb	Original bruksanvisning	38			

ZS-MFK 700

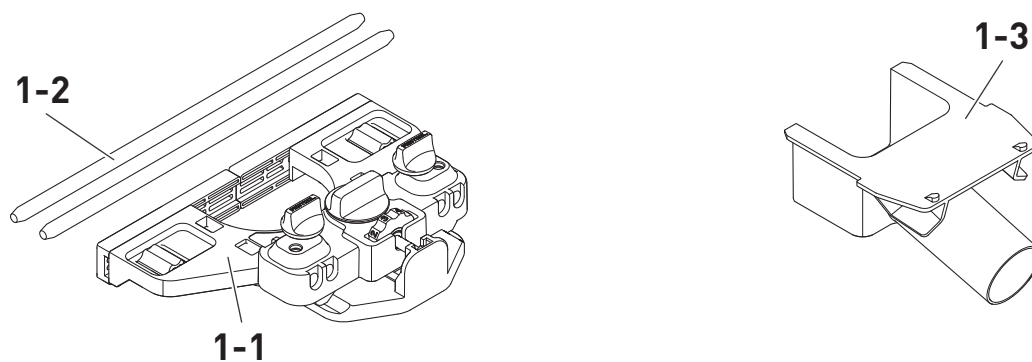

1



2

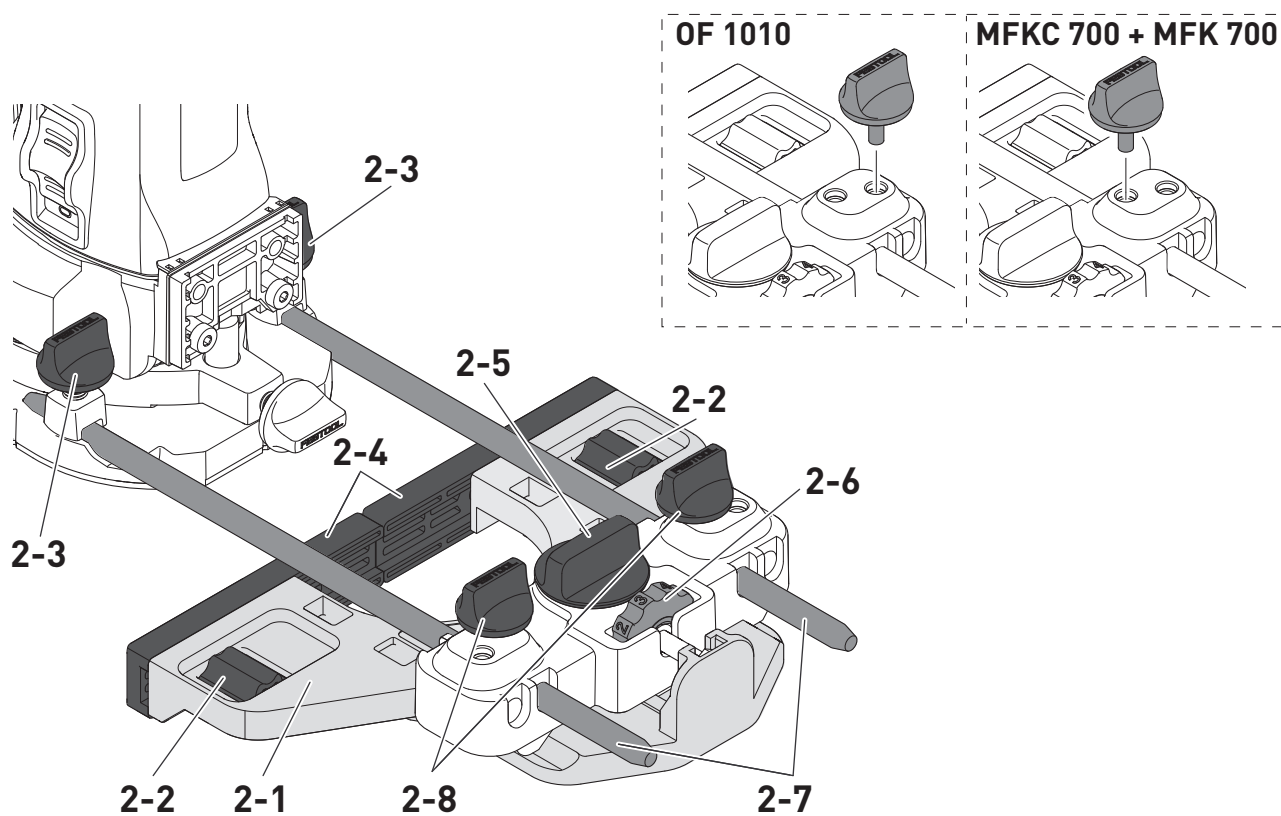

3

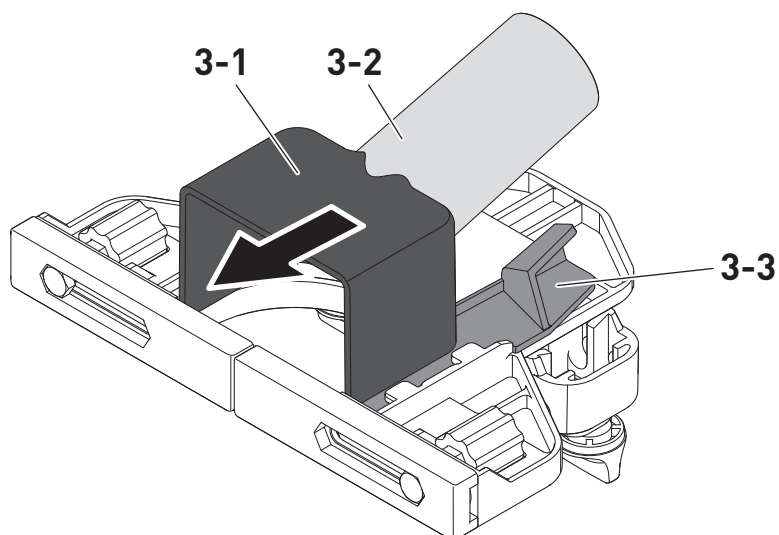

4

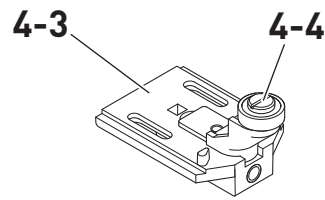
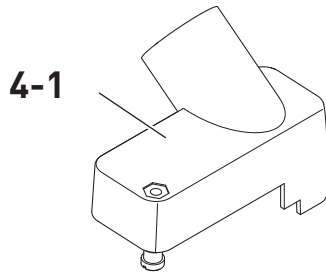
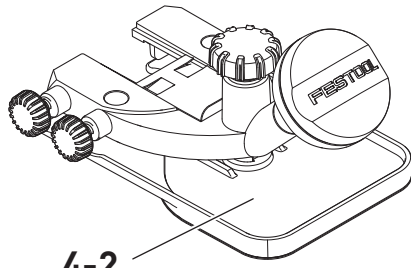

4-4

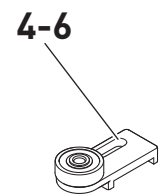
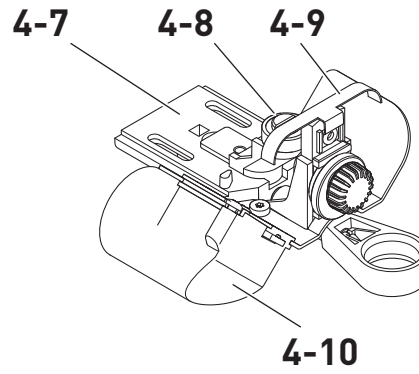
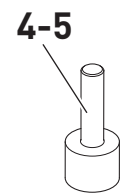

5

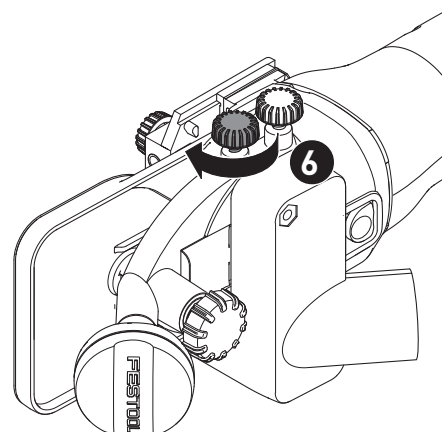
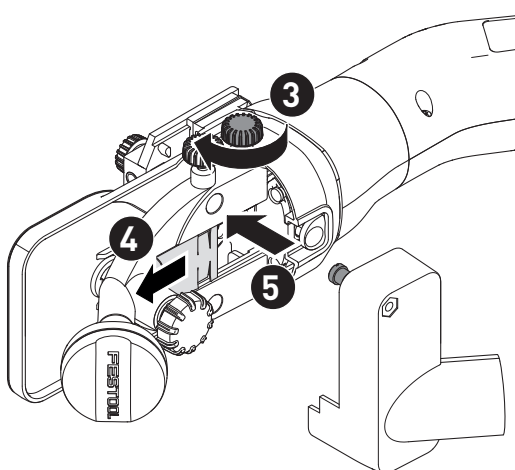
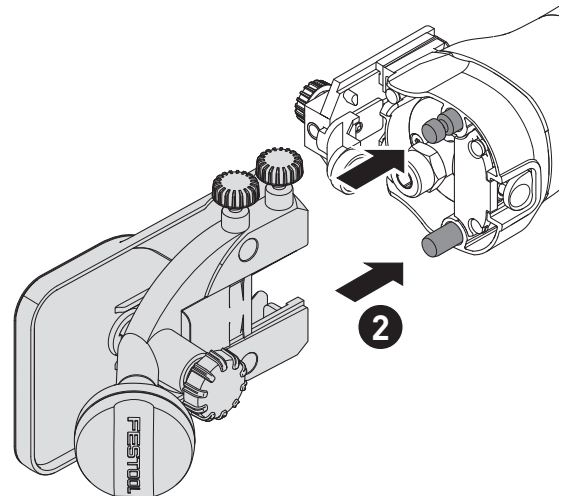
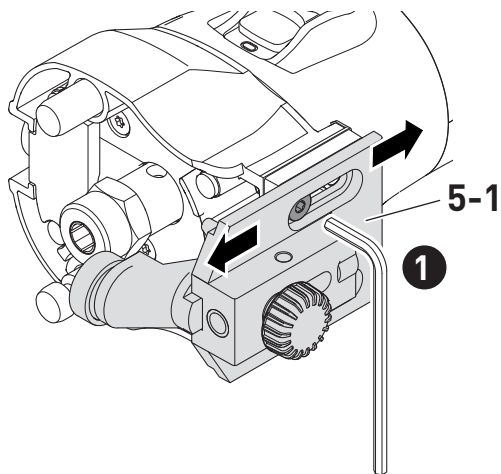
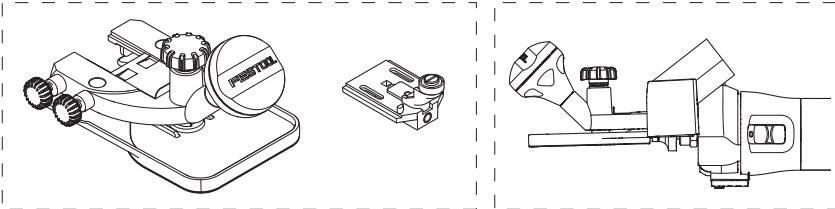

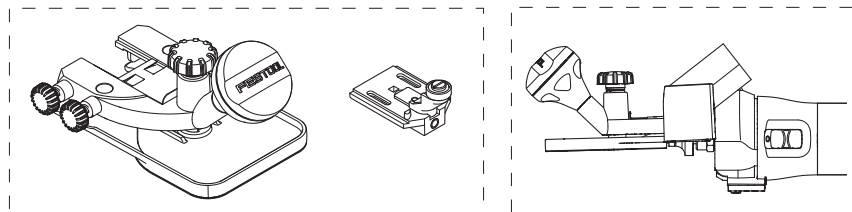
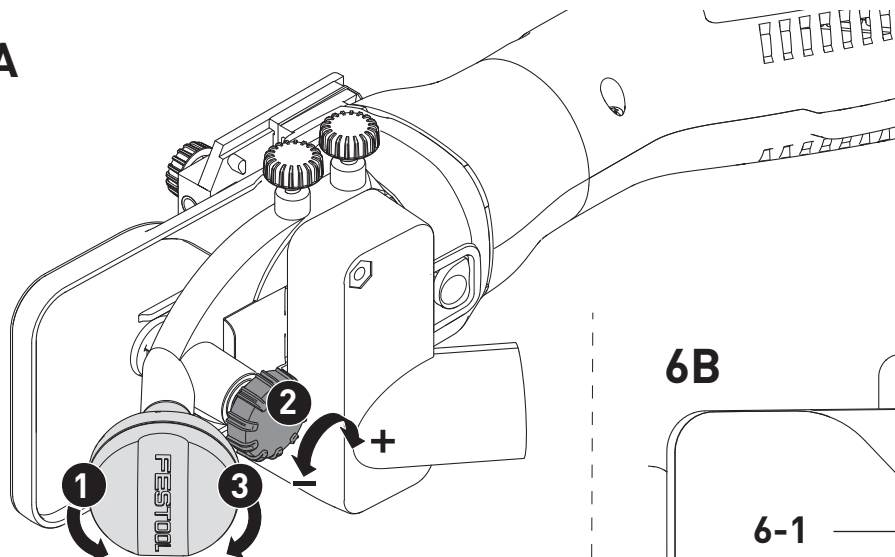
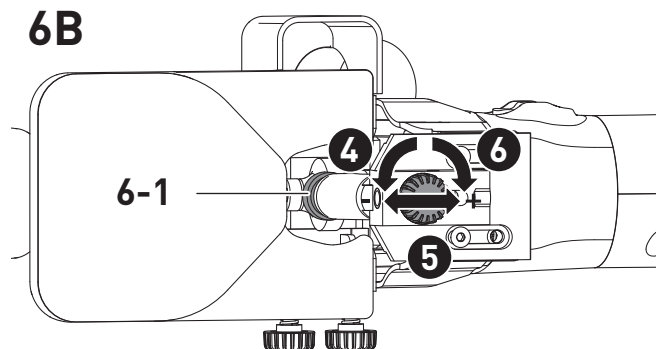
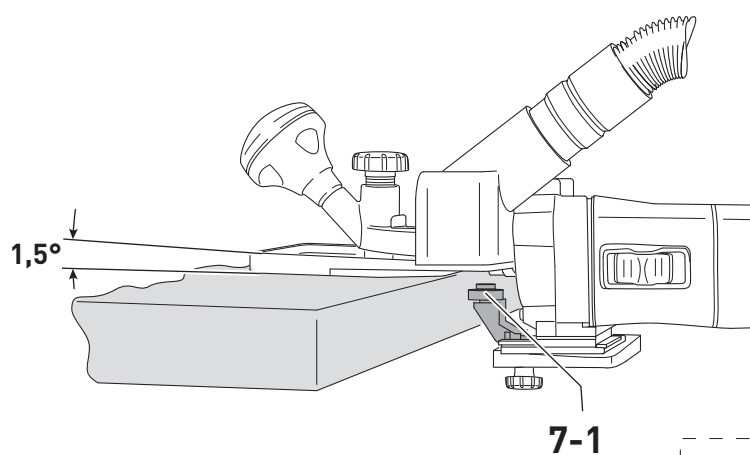
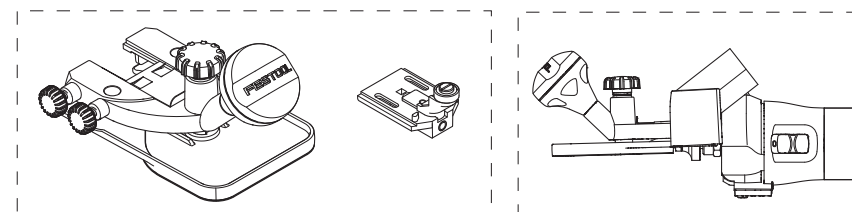
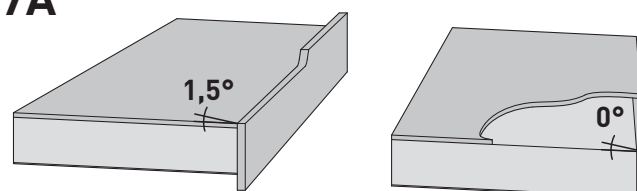
6**6A****6B****7****7A**

The three line drawings illustrate the following steps:

- Coarse Focus Adjustment:** The microscope is shown with the coarse focus knob being turned to bring the specimen into initial focus.
- Fine Focus Adjustment:** The fine focus knob is used to sharpen the image after the coarse focus has been set.
- Stage and Slide Adjustment:** The stage is moved using the X-Y-Z controls to position the specimen correctly under the objective lens.

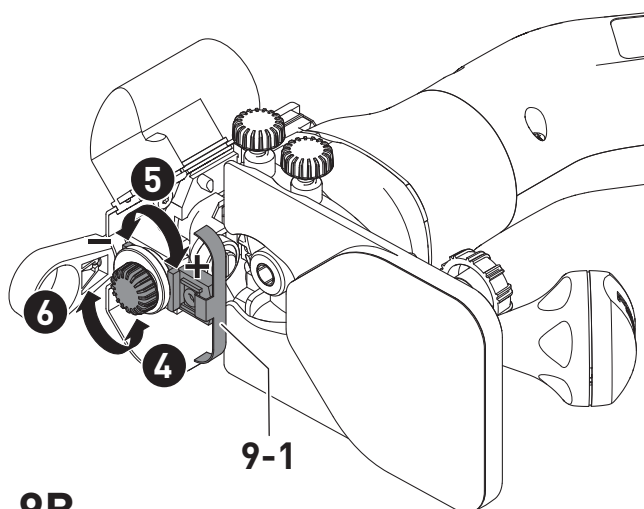
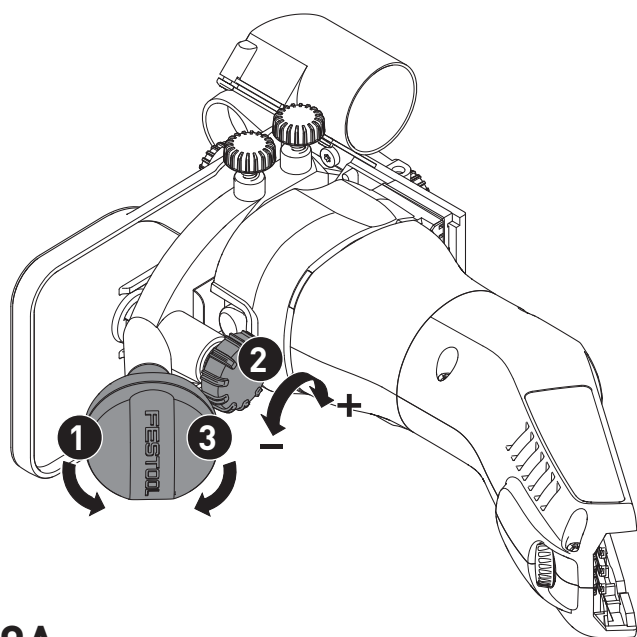
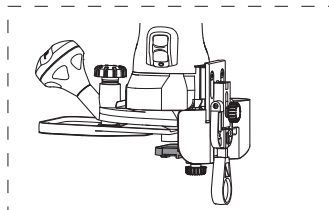
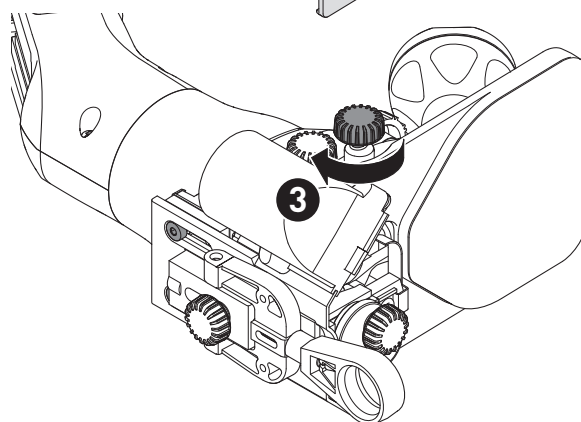
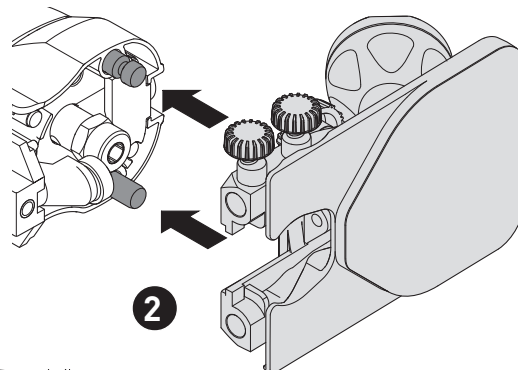

9B

10

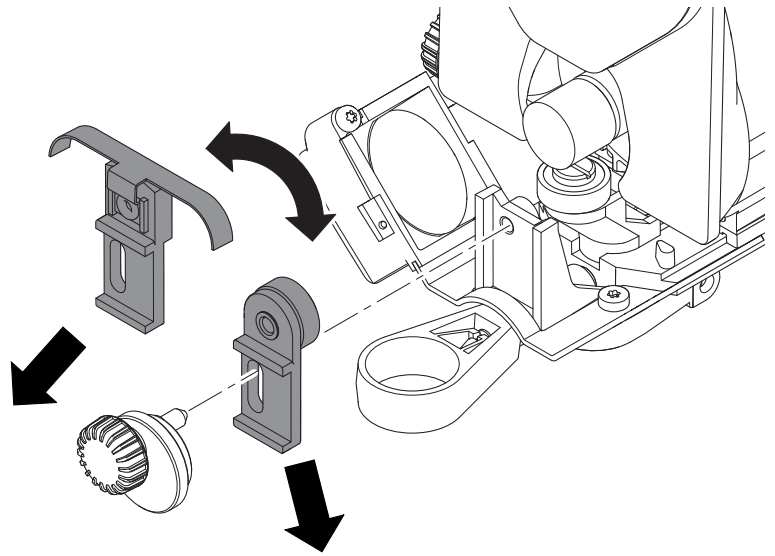
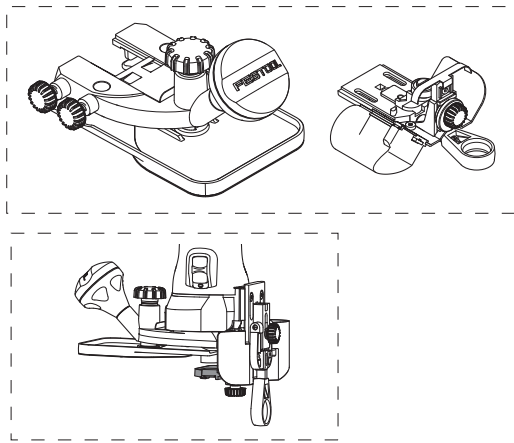

10A

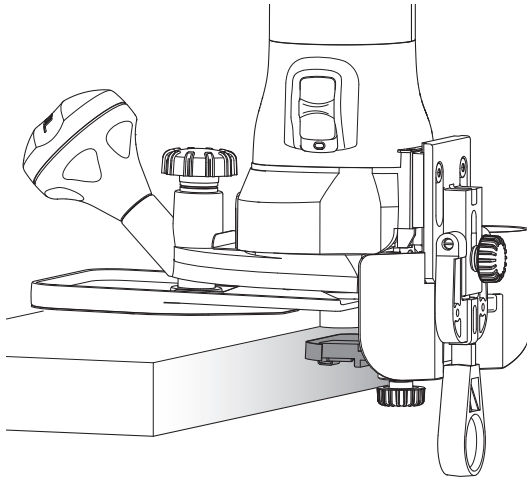

10B

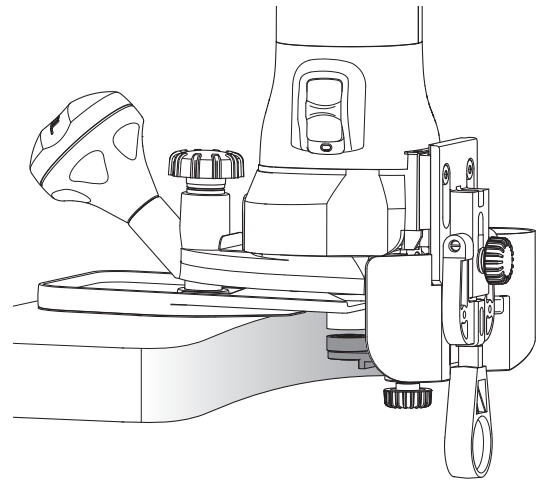

11

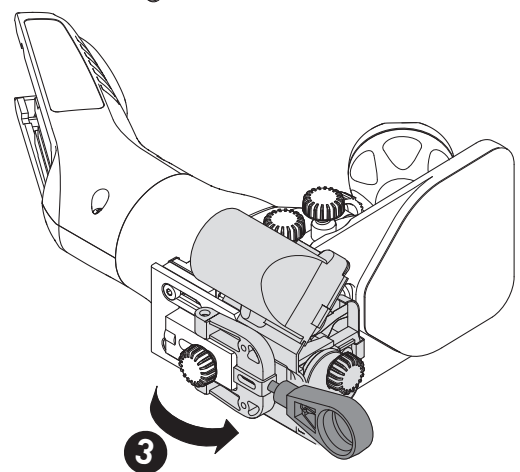
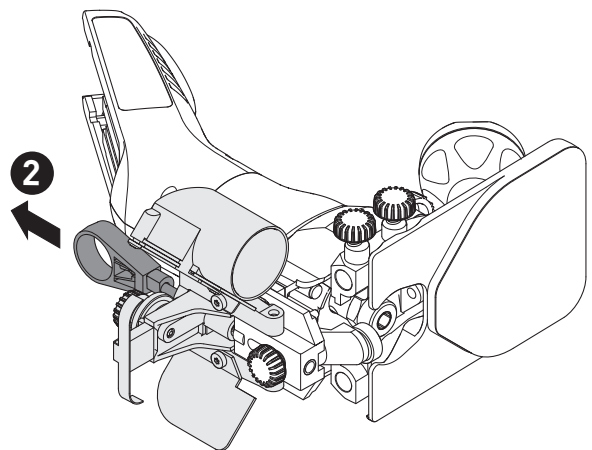
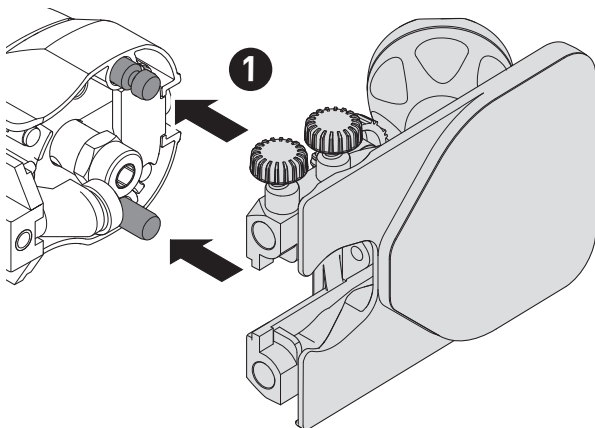
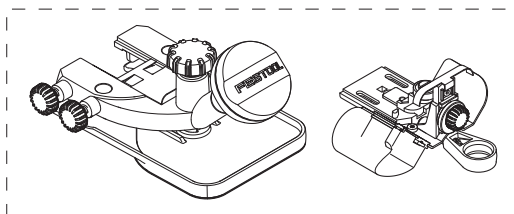

1 Symbols



Warning of general danger



Read the operating manual and safety warnings.



UKCA marking: Confirms the conformity of the product with UK regulations.



Do not dispose of it with domestic waste.



Tip or advice

2 Safety warnings



WARNING! Read all safety warnings, instructions, illustrations and specifications provided with this power tool. Failure to follow all instructions listed below may result in electric shock, fire and/or serious injury.

Save all warnings and instructions for future reference.

Observe the operating manual of the power tool.

3 Parallel side fence

[1-1] Parallel side fence

[1-2] Guide rods

[1-3] Extraction hood

3.1 Routing with a parallel side fence

For work running parallel to the workpiece edge, the parallel side fence [2-1] can be used.

- Clamp the two guide rods [2-7] to the parallel side fence using the two rotary knobs [2-8].
- Insert the guide rods into the grooves of the router table to the required extent and clamp them using the two rotary knobs [2-3].

Fine adjustment

- Open the rotary knob [2-5] to perform fine adjustment using the adjusting wheel [2-6].
- ⓘ Each number on the adjusting wheel is equal to fine adjustment of .
- Close the rotary knob [2-5] after performing fine adjustment.

- Set the two guidance jaws [2-4] so that they are approx. mm from the cutter. To do so, open the two jaw fasteners [2-2] and close them after making an adjustment.

Dust extraction attachment

- As shown in figure [3], push the dust extraction attachment [3-1] from behind until it engages on the parallel side fence.
- To remove the dust extraction attachment, slightly lift the tabs [3-3].
- ⓘ An extractor hose with a diameter of 27 mm or 36 mm can be connected to the extractor connector [3-2].

4 Router table for edge veneer

[4-1] Extraction hood

[4-2] Router table

[4-3] Sensor with feeler roller [4-4]

[4-5] Edge trimming cutter

[4-6] Feeler roller

[4-7] Swivel-mounted sensor with

- [4-8] Feeler roller
- [4-9] Contact spring
- [4-10] Extraction hood

4.1 Routing edges with a sensor

Horizontal working position [5]+[6]+[7]

For flush trimming thin surface coatings (edge veneer) and profile routing.

Fitting the router table and sensor [5]

- ⓘ The sensor [5-1] can be optimally adjusted to the routing tool by moving it in the slotted holes.

Setting the routing depth [6]

- Set the routing depth on the router table [6A].
- Set the routing depth of the feeler roller [6-1] [6B].

Routing edges [7]

Guide the power tool in such a way that the feeler roller [7-1] is flush with the workpiece.

- ⓘ So that the panel coating is not damaged when edge routing, the router table is inclined by 1.5°. For exactly right-angled milling grooves, a router table with 0° inclination is available as an accessory [7A].

4.2 Routing edges with a swivel-mounted sensor

Vertical working position [8]+[9]+[10]

For flush trimming surface coatings and profile routing.

- With contact spring for straight and rough workpiece edges **[10A]**
- With feeler roller for curved workpiece edges **[10B]**

Fitting the router table and sensor [8]

-  The sensor **[8-1]** can be optimally adjusted to the routing tool by moving it in the slotted holes.

Setting the routing depth [9]

- Set the routing depth on the router table **[9A]**.
- Set the routing depth of the feeler roller or contact spring **[9-1]** on the sensor **[9B]**.

Routing edges [10]

- Guide the power tool along the workpiece at an even feed rate. The router table and feeler roller or contact spring must always be flush with the workpiece.

4.3 Changing the working position from vertical to horizontal [11]

Convert the router table and the sensor for a quick change of working position.

- Install the router table for edge veneer in a vertical position.
- Swivel the sensor.

5 Accessories

You can find the PO numbers for accessories and tools under www.festool.co.uk.

6 Environment



Do not dispose of accessories in the household waste. Recycle accessories and packaging. Observe applicable national regulations.

Information on REACH: www.festool.co.uk/reach

7 General information

Imported into the UK by

Festool UK Ltd
1 Anglo Saxon Way
Bury St Edmunds
IP30 9XH
Great Britain